

S5522

2000-2006 JEEP WRANGLER/RUBICON (TJ),
2004-2006 UNLIMITED (EXTENDED) 4.0L/2.5L,
Cat-Back, 2.5" Turn Down

MBRP®

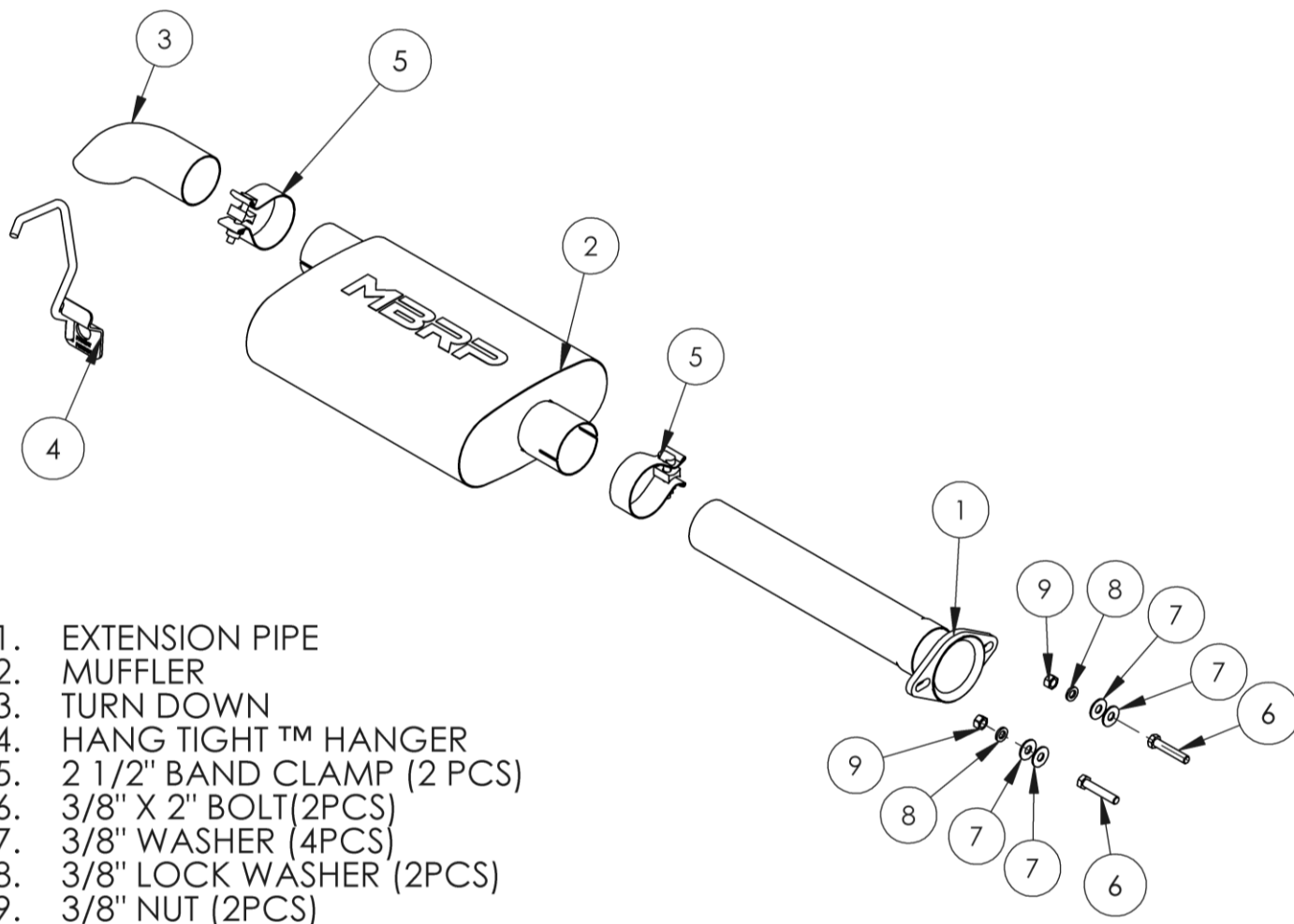

PLEASE READ BEFORE STARTING INSTALLATION

While MBRP has made every effort to ensure that all components of this system are of superior quality and properly packaged, it is the installer's responsibility to ensure the following before removal of the factory exhaust:

- that ALL components shown above are present.
- that ALL mating components fit together.
- that there are no damaged components.
- that the system you have purchased is appropriate for your vehicle year, model and configuration.
- that the system will not interfere with any modifications previously installed or planned.
- that you have read and understand these instructions.

If you have any questions or are uncertain about any aspect of the installation of this system to your vehicle please contact your dealer before commencing installation.

2000-2006 Jeep Wrangler (TJ) 2004-2006 Jeep Wrangler Unlimited

Removal of Stock System:



Figure 1

1. Apply a penetrating lubricant liberally to all exhaust fasteners, hangers and rubber insulators.



Figure 2

2. Cut the exhaust pipe after the muffler to be able to remove it from the vehicle. **Refer to Figure 1.**

3. Remove the tail section of the exhaust by removing it from the rubber isolators. **Refer to Figure 2.**



Figure 3

4. Remove the hardware from the flange and remove the muffler. **Refer to Figure 3.**

Installation of MBRP Inc. Performance Exhaust:



Figure 4



Figure 5



Figure 6

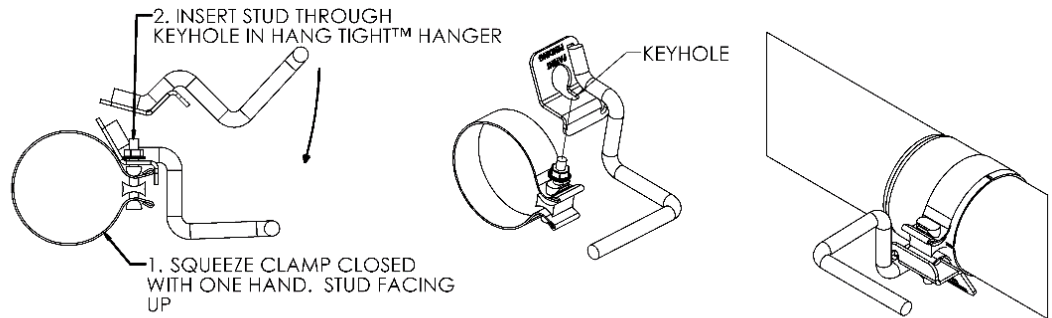

Figure 7

1. For the Unlimited Wrangler install the **Extension Pipe** to the existing flange using the fasteners provided. **Refer to Figure 4.** For the regular length TJ the **Extension Pipe** will need to be shortened 10".

2. Slide the **2 1/2" Clamp** over the **Muffler** inlet and then install it to the **Extension Pipe**. **Refer to Figure 5.**

3. Slide the **Hang Tight Hanger and clamp** (assembly instructions below) over the **Muffler** outlet and then install the **Turn Down** to the **Muffler**. Install the hanger of the **Hang Tight Hanger** into the existing rubber insulator. **Refer to Figures 6 & 7.**



3. ROTATE HANG TIGHT™ HANGER TO SEAT THREADED STUD IN SLOT. BE SURE THE NUT IS ABOVE THE BRACKET

4. Tighten all hardware and clamps, starting at the front and working rearward to secure the system. Check along the full length of the exhaust system to ensure there is adequate clearance for fuel lines, vent lines, brake lines, frame, bodywork, suspension, and any wiring, etc. If there is any interference detected, relocate, or adjust to provide adequate clearance. Ensure all clamp connections are secure and components are unable to rotate or slide. Band clamps require approximately 45 lb-ft (60 N-m) of torque. Verify clearances, system security and band clamp torque after 30-60 miles (50-100 km) of driving.



Congratulations! You are ready to begin experiencing the improved power, sound and driving experience of your MBRP Inc. performance exhaust system. We know you will enjoy your purchase.