

Fitting Instructions #5591IS

Jeep Cherokee KL (2014-On)

Rear Control Arm Upper & Lower Outer Bush Kit

- Lift the vehicle up and support on jack stands or hoist. Remove rear wheels and upper/lower control arms;
- Remove the original bush including the steel shell from the housing with a bush extraction kit (Refer Figure 01 for example). Alternatively remove hub assembly and use a press to remove the bushes;
- Clean housing surface to remove any old original bushing materials;
- Install the new bush centre to the housing (refer Figure 02);
- Apply the grease supplied to the housing bore, the outside of the steel crush tube and press the crush tube in;
- Refit the rear upper/lower control arms using manufacturer's torque settings and carry out a wheel alignment;

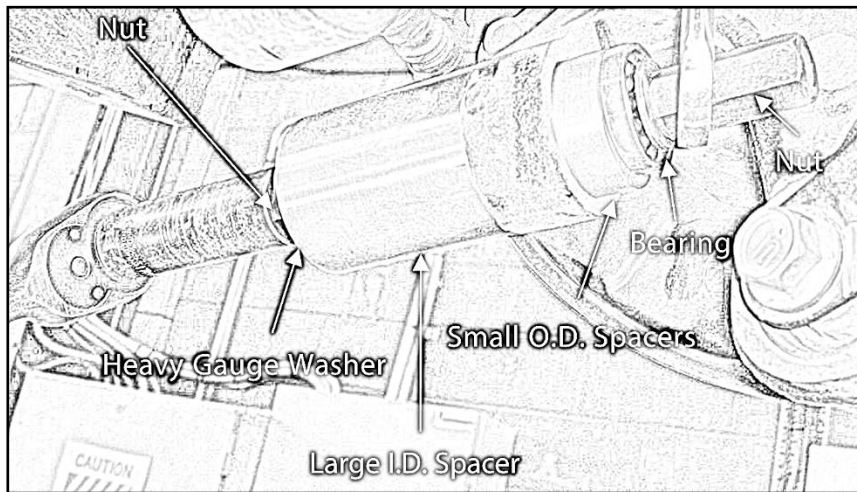
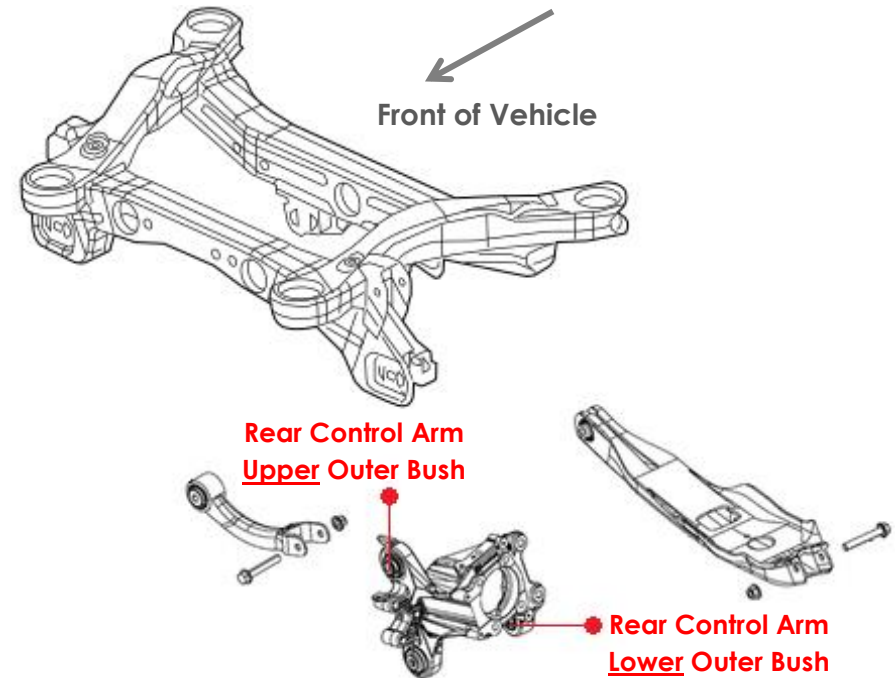

Figure 01 – Example of Bush Extraction Arrangement

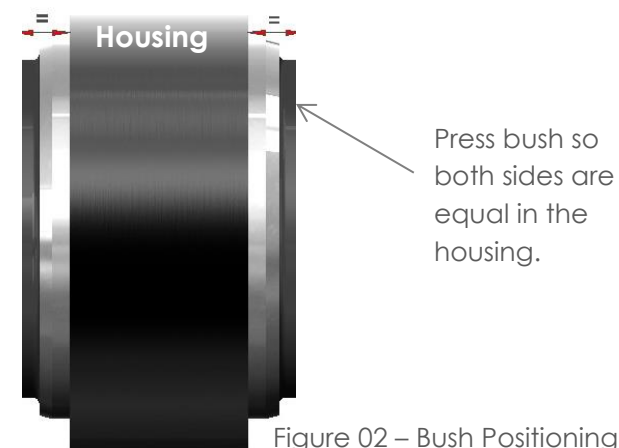

Figure 02 – Bush Positioning in Housing