



INSTALLATION INSTRUCTIONS

Not legal for sale or use in California on any pollution controlled motor vehicle.

69-9510TC VOLKSWAGEN 2022-25 MK8 GOLF R 2022-24 ARTEON L4 - 2.0L TURBO

TOOLS NEEDED:

1/4" Ratchet
Extension
7mm Socket
8mm Socket
T25 Torx
Pliers

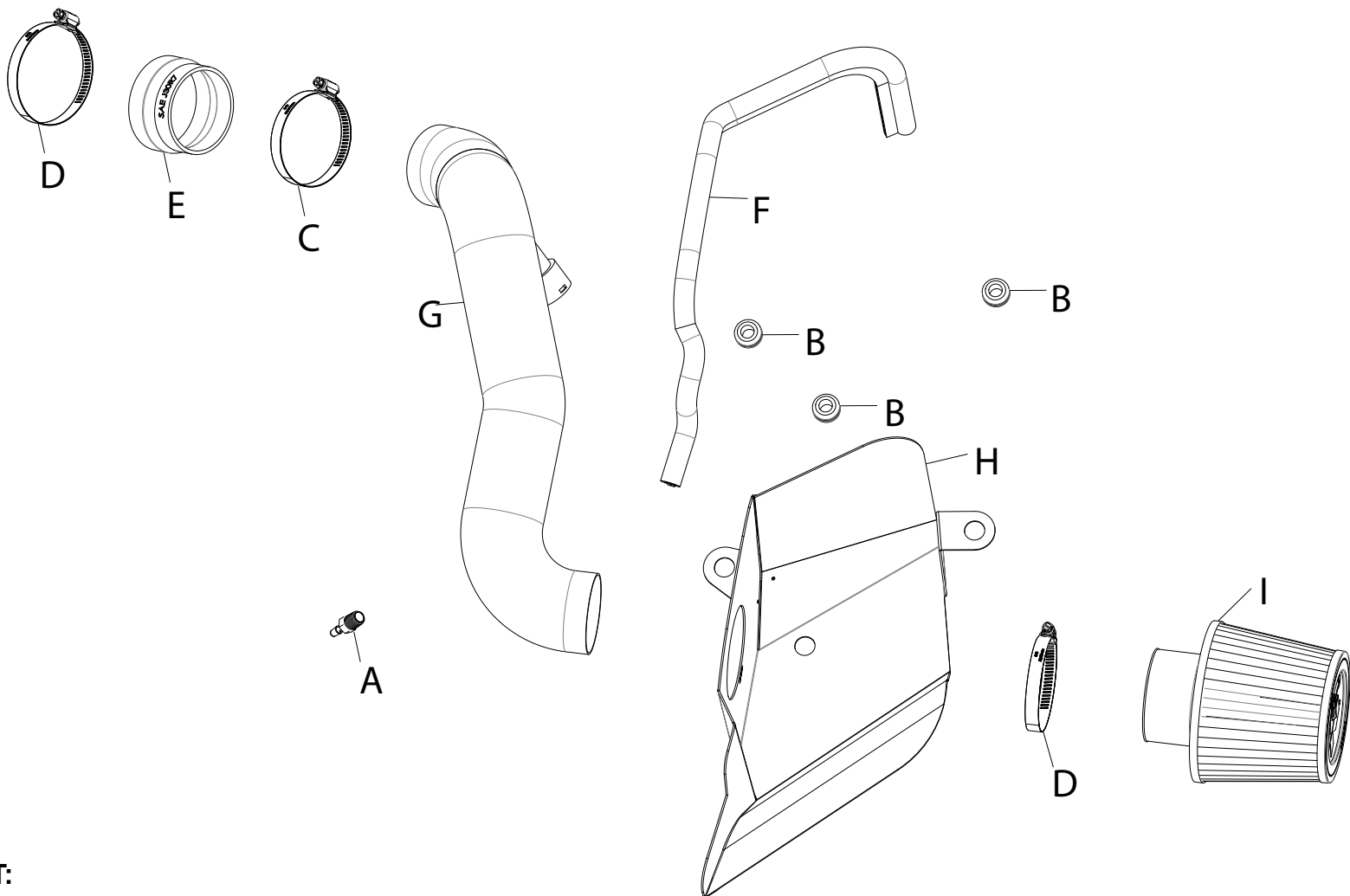

PARTS LIST:

Description	Qty.	Part #	Description	Qty.	Part #	Description	Qty.	Part #
A VENT; 1/4"HOSE BARB, 1/4"NPT	1	08046	D HOSE CLAMP; #52	2	08610	G TUBE; 3.0"OD X 28"L	1	25920C
B GROMMET; 1"OD, 1/2"ID	3	08064	E HOSE; 3.25"ID TO 3"ID X 2"L	1	08186	H HEAT SHIELD	1	20-8649
C HOSE CLAMP; #48	1	08601	F EDGE TRIM; (56"L)	1	102490	I AIR FILTER	1	RU-5176

If you need any assistance please call 1-800-858-3333 to speak with a representative in our Customer Service Center before returning the product.

NOTE: FAILURE TO FOLLOW INSTALLATION INSTRUCTIONS AND NOT USING THE PROVIDED HARDWARE MAY DAMAGE THE INTAKE TUBE, THROTTLE BODY AND ENGINE.

TO START:

1. Turn off the ignition and disconnect the negative battery cable.
NOTE: Disconnecting the negative battery cable erases pre-programmed electronic memories. Write down all memory settings before disconnecting the negative battery cable. Some radios will require an anti-theft code to be entered after the battery is reconnected. The anti-theft code is typically supplied with your owner's manual. In the event your vehicles anti-theft code cannot be recovered, contact an authorized dealership to obtain your vehicles anti-theft code.



2. Loosen the hose clamp that secures the stock intake tube to the turbo inlet.



3. Release the spring clamp that secures the stock intake tube to the air filter housing and disconnect the tube from the housing.

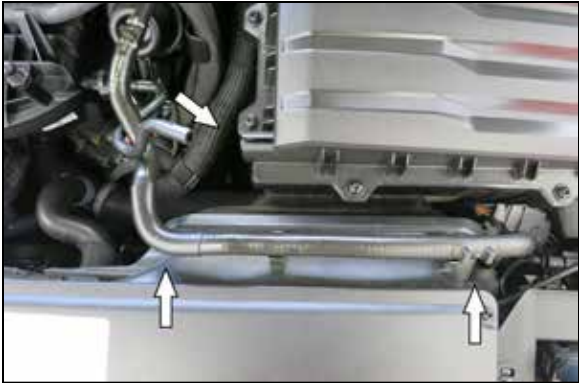

4. Disconnect the vacuum line from the air filter housing. Pull the coolant line away from scoop.



5. Remove the two screws that secure the fresh air inlet and then remove the fresh air inlet from the vehicle.



6. Remove the factory air filter housing from the vehicle.

Continued

INSTALLATION INSTRUCTIONS



7. Depress the locking clips and disconnect the BOV hose from the intake tube and remove the intake tube from the vehicle.



8. Install the provided step coupler onto the turbo inlet and secure with the provided hose clamp.

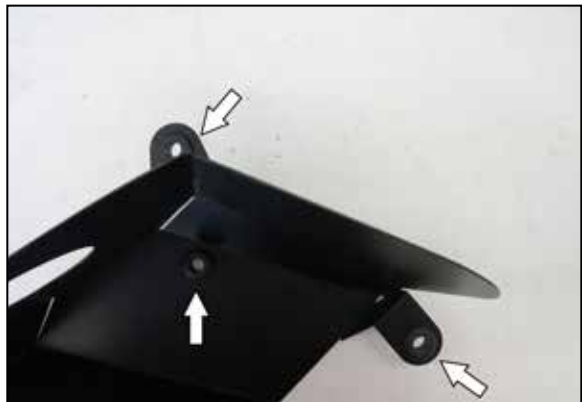

9. Install the provided grommets into the heat shield as shown.



10. Cut the provided edge trim into three sections as shown.



11. Install the edge trim onto the heat shield as shown.



12. Install the 1/4" NPT vacuum fitting into the K&N intake tube as shown. **NOTE: Plastic NPT fittings are easy to cross thread. Install the vent fitting "hand" tight, then turn it two complete turns with a wrench.**



13. Set the heat shield into the vehicle so the mounting studs insert into the mounting grommets.



14. Reinstall the fresh air inlet and secure with the factory hardware.



15. Connect the BOV hose to the fitting on the K&N intake tube.



16. Insert the intake tube through the heat shield and into the coupler at the turbo, adjust for best fit and secure with the provided hose clamp.



17. Connect the vacuum line to the fitting installed into the K&N intake tube.



18. Install the air filter onto the intake tube and secure with the provided hose clamp.



19. Install the K&N decal onto the intake tube as shown.



20. Reconnect the negative battery cable.

21. Reconnect the vehicle's negative battery cable. Double check to make sure everything is tight and properly positioned before starting the vehicle.

22. It will be necessary for all K&N® high flow intake systems to be checked periodically for realignment, clearance and tightening of all connections. Failure to follow the above instructions or proper maintenance may void warranty.

ROAD TESTING:

1. Start the engine with the transmission in neutral or park, and the parking brake engaged. Listen for air leaks or odd noises. For air leaks secure hoses and connections. For odd noises, find cause and repair before proceeding. This kit will function identically to the factory system except for being louder and much more responsive.

2. Test drive the vehicle. Listen for odd noises or rattles and fix as necessary.

3. If road test is fine, you can now enjoy the added power and performance from your kit.

4. K&N Engineering, Inc., requires cleaning the intake system's air filter element every 100,000 miles. When used in dusty or off-road environments, our filters will require cleaning more often. We recommend that you visually inspect your filter once every 25,000 miles to determine if the screen is still visible. When the screen is no longer visible some place on the filter element, it is time to clean it. To clean and re-oil, purchase our filter Recharger® service kit, part number 99-5050 or 99-5000 and follow the easy instructions.