

INSTALLATION INSTRUCTIONS DIESEL FUEL RAIL PRESSURE & HPOP GAUGES

2650-1481-00 Rev. D



CAUTION!
As a safety precaution, the +12V terminal of this product should be fused before connecting to the 12V ignition switch. We recommend using a 3 Amp, automotive type fuse.

See next page for wire color by application chart.

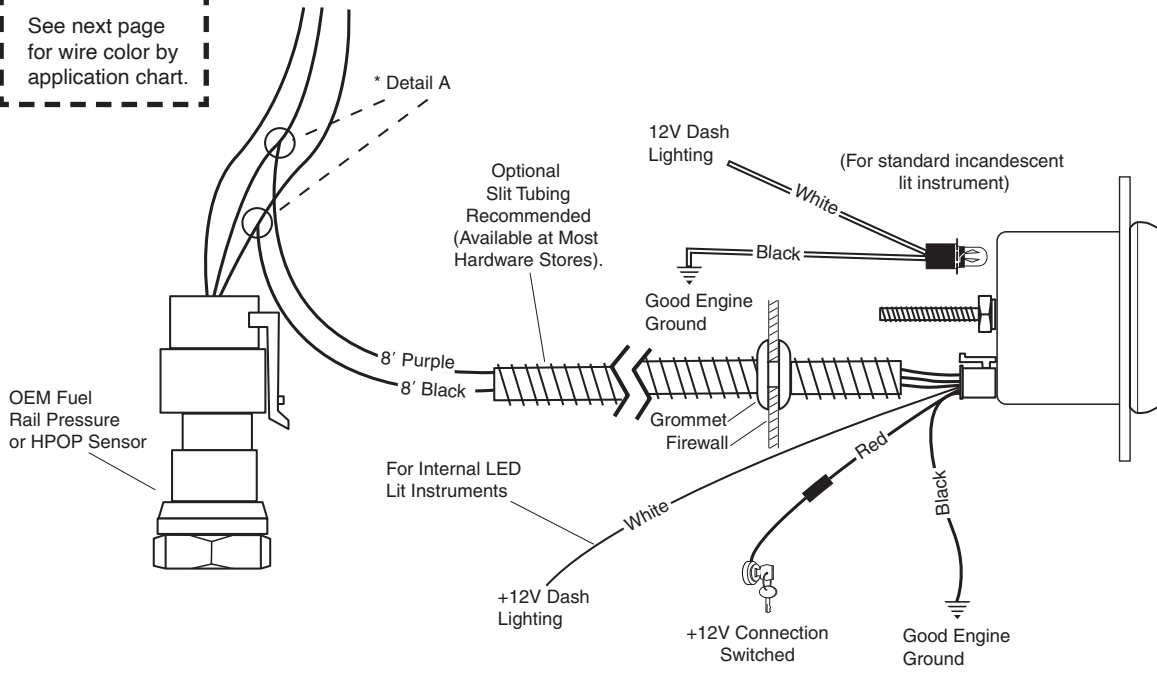

NOTE: When the ignition is off the pointer may not always rest at zero.

Recommended Splice

- Carefully strip approximately 1/2" of the insulation from the OEM wire. Use caution not to cut or break wire while removing the insulation. (see figure 1.)
- Wrap the bare end of the gauge harness wire around the bare OEM wire. (see figure 2)
- Solder connection. (see figure 3)
- Wrap splice with electrical tape to seal and insulate connection. (see figure 4)

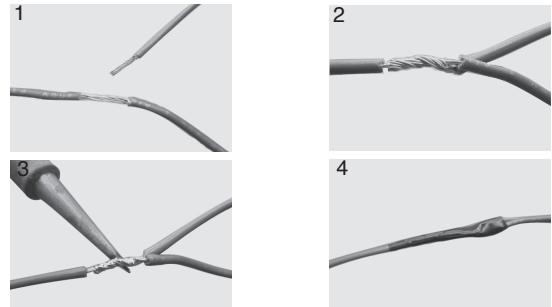

Installation

- Check that you have all parts required for installation, and the engine is cool.
- Disconnect the negative (-) battery cable.
- Gauge mounts in a 2-1/16" hole for 2-1/16" gauge. Use supplied brackets and nuts to secure gauge to dash or panel, if a friction fit or a pod mounted bracket are not used.
- Drill 1" diameter hole where wires pass through sheet metal (such as firewall) and install rubber grommet provided. (Grommet will require slit). Route the necessary wire through the grommet into the engine compartment. The 8' Purple and 8' Black wires will need to be routed to the engine compartment.
- Connect the white wire to dash lighting or switchable 12v light source, the 4' red wire to a switched +12V source and the 4' black wire to ground (see diagram for details).
- From the table below, determine the wire colors used in your vehicle for the signal and ground wires.
- Locate the harness connected to the sensor (Fuel Rail Pressure or HPOP) in your vehicle. Confirm the harness matches the wires identified in the table.
- Connect the 8' Purple wire from the gauge harness to the signal wire.
- Connect the 8' Black wire from the gauge harness to the sensor ground.
- Secure all wiring with cable ties (not included) to ensure they are kept away from moving parts, sharp edges, and high heat sources.
- Reconnect negative (-) battery cable.

For example: The 2004 Dodge with a Cummins 5.9L uses a BROWN/YELLOW wire for Signal and a VIOLET/RED wire for Ground. The BROWN/YELLOW wire needs to be connected to the 8' PURPLE wire from the gauge harness, and the VIOLET/RED wire needs to be connected to the 8' BLACK wire from the gauge harness.

NOTE: It is recommended that the electrical connections made in the engine compartment be soldered, and wrapped with several layers of a good electrical tape.

CAUTION: If you will be working with the fuel system, take care to insure no sparks or flames occur.

Brand	Year(s)	Engine	Wire Color (at sensor)	
			Signal	Ground
			Purple from Gauge	Black from Gauge
Fuel Rail Pressure Sensor				
Chevy	2002-2008	Duramax 6.6L	Yellow	Orange/Black
Chevy	2009-2011	Duramax 6.6L	Orange/Black	White
Chevy	2012	Duramax 6.6L	Yellow	Black
Chevy	2013-2016	Duramax 6.6L	Yellow	Orange/Black
Chevy	2017-2025	Duramax 6.6L	Blue/White	Black/Green
Fuel Rail Pressure Sensor				
Dodge	2003	Cummins 5.9L	Pink/Black	Violet/Red
Dodge	2004-2005	Cummins 5.9L		
Dodge	2006-2009	Cummins 5.9L	Brown/Yellow	Brown/White
Dodge	2007	Cummins 6.7L		
Dodge	2008-2013	Cummins 6.7L		
Dodge	2014-2025	Cummins 6.7L		
High Pressure Oil Pressure Sensor				
Ford	1994-1996	Powerstroke 7.3L	Dark Blue/ Light Green	Gray/Red
Ford	1997	Powerstroke 7.3L	Light Blue/Red	
Ford	1999-2003	Powerstroke 7.3L	Dark Blue/ Light Green	
Ford	2003-2007	Powerstroke 6.0L		
Fuel Rail Pressure Sensor				
Ford	2008-2010	Powerstroke 6.4L	Green	Black
Ford	2011-2019	Powerstroke 6.7L	Blue/Brown	Green/White
Ford	2020-2022	Powerstroke 6.7L	Blue/Red	Blue/Brown
Ford	2023-2025	Powerstroke 6.7L	Blue/Green	Blue

Power-Up

The pointer will move backward to the stop pin and then move to the zero box, or current pressure reading. This procedure is an auto-calibration function and is performed on every power-up. While this test is being performed, the gauge may make a clicking sound. This is normal.

SERVICE

For service send your product to AutoMeter in a well packed shipping carton. Please include a note explaining what the problem is along with your phone number. If you are sending product back for Warranty adjustment, you must include a copy (or original) of your sales receipt from the place of purchase.

12 MONTH LIMITED WARRANTY

AutoMeter Products, Inc. warrants to the consumer that all AutoMeter High Performance products purchased from an Authorized AutoMeter Reseller will be free from defects in material and workmanship for a period of twelve (12) months from date of the original purchase. Products that fail within this 12 month warranty period will be repaired or replaced at AutoMeter's option, when determined by AutoMeter that the product failed due to defects in material or workmanship. This warranty is limited to the repair or replacement of parts in the AutoMeter High Performance product and the necessary labor done by AutoMeter to effect the repair or replacement of the AutoMeter High Performance product. In no event shall AutoMeter's cost to repair or replace an AutoMeter High Performance Product under this warranty exceed the original purchase price of the AutoMeter High Performance Product. Nor shall AutoMeter Products, Inc. be responsible for special, incidental or consequential damages or costs incurred due to the failure of an AutoMeter High Performance Product. This warranty applies only to the original purchaser of the AutoMeter High Performance Product and is non-transferable. This warranty also applies only to AutoMeter High Performance Products purchased from an Authorized AutoMeter Reseller. All implied warranties shall be limited in duration to the said 12 month warranty period. Breaking the instrument seal, improper use or installation, accident, water damage, abuse, unauthorized repairs or alterations voids this warranty. AutoMeter disclaims any liability for consequential damages due to the breach of any written or implied warranty on all products manufactured by AutoMeter Products, Inc. For a comprehensive listing of Un-Authorized AutoMeter Resellers please visit www.autometer.com/autometerlocator/index/unauthorized.

FOR SERVICE SEND TO: **AUTO METER PRODUCTS, INC.** 413 W. Elm St., Sycamore, IL 60178 USA (866) 248-6356

Email us at service@autometer.com

<http://www.autometer.com>



The Super Bezel is a registered trademark of Auto Meter Products, Inc.