



ORACLE LIGHTING

GX460 REVERSE MODULES
ORACLE PART #5932
INSTALLATION GUIDE

TOOLS NEEDED:
10MM SOCKET
SOCKET WRENCH



SCAN TO VIEW INSTALL VIDEO

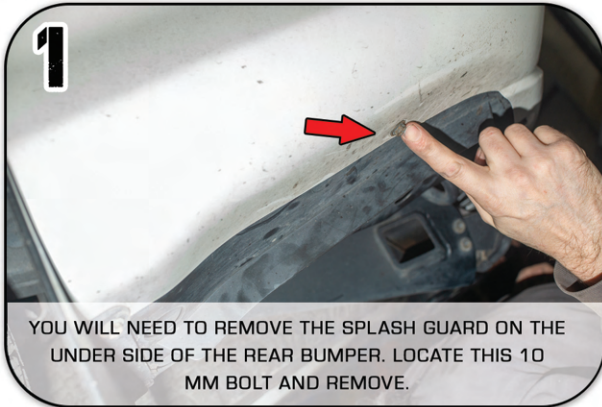

1
YOU WILL NEED TO REMOVE THE SPLASH GUARD ON THE UNDER SIDE OF THE REAR BUMPER. LOCATE THIS 10 MM BOLT AND REMOVE.



2
TOWARDS THE TIRE THERE WILL BE (2) MORE 10MM BOLTS ON THE SPLASH GUARD THAT NEED TO BE REMOVED.

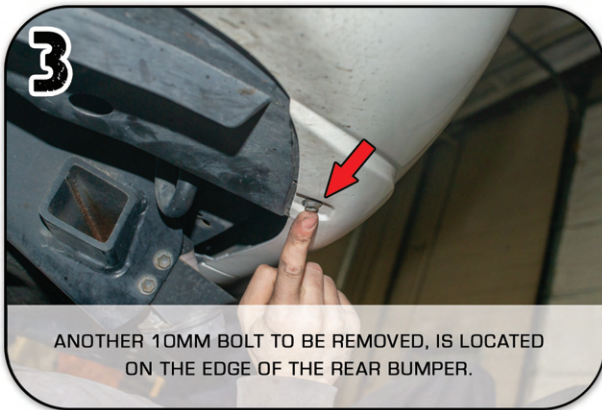

3
ANOTHER 10MM BOLT TO BE REMOVED, IS LOCATED ON THE EDGE OF THE REAR BUMPER.

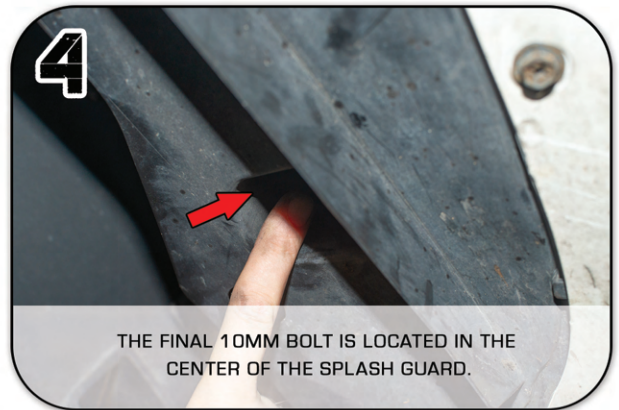

4
THE FINAL 10MM BOLT IS LOCATED IN THE CENTER OF THE SPLASH GUARD.



5
YOU CAN NOW REMOVE THE SPLASH GUARD AFTER ALL BOLTS HAVE BEEN LOOSENED AND REMOVED.



6
REACH UP AND LOCATE THE REVERSE LIGHT BULB. TWIST AND DISCONNECT THE BULB FROM THE HOUSING.

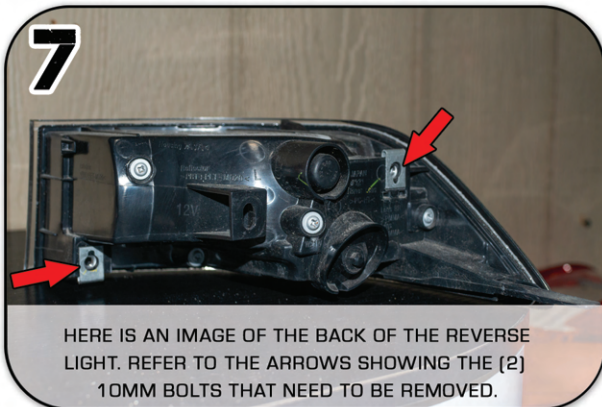

7
HERE IS AN IMAGE OF THE BACK OF THE REVERSE LIGHT. REFER TO THE ARROWS SHOWING THE (2) 10MM BOLTS THAT NEED TO BE REMOVED.

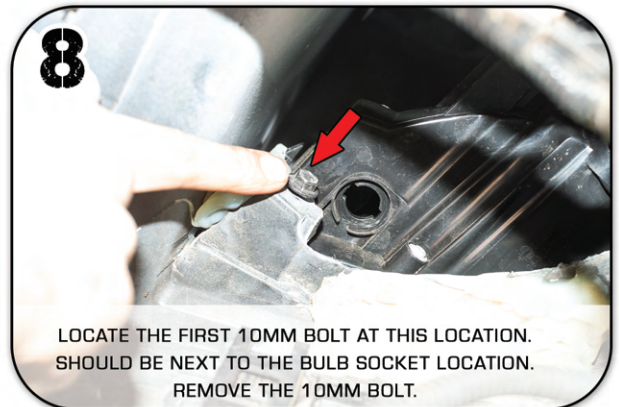

8
LOCATE THE FIRST 10MM BOLT AT THIS LOCATION. SHOULD BE NEXT TO THE BULB SOCKET LOCATION. REMOVE THE 10MM BOLT.



ORACLE LIGHTING

GX460 REVERSE MODULES
ORACLE PART #5932
INSTALLATION GUIDE

TOOLS NEEDED:
10MM SOCKET
SOCKET WRENCH



SCAN TO VIEW INSTALL VIDEO

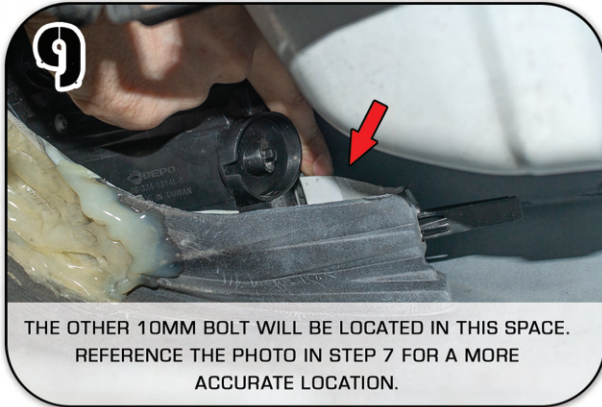

9
THE OTHER 10MM BOLT WILL BE LOCATED IN THIS SPACE. REFERENCE THE PHOTO IN STEP 7 FOR A MORE ACCURATE LOCATION.

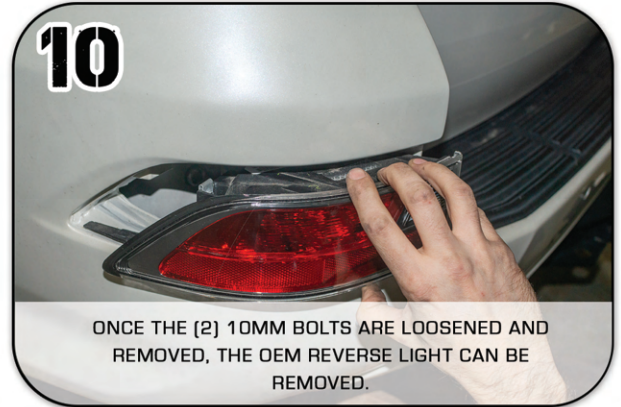

10
ONCE THE (2) 10MM BOLTS ARE LOOSENED AND REMOVED, THE OEM REVERSE LIGHT CAN BE REMOVED.



11
FEED THE PLUG & PLAY ADAPTER WIRE INTO LOCATION.



12
SNAP IN THE NEW ORACLE REVERSE LIGHT MODULE.



13
REMOVE THE OEM REVERSE LIGHT BULB.



14
PLUG IN THE REVERSE LIGHT MODULE TO THE OEM REVERSE LIGHT BULB PLUG.



15
REPLACE THE SPLASH GUARD WITH THE (5) 10MM BOLTS YOU REMOVED PREVIOUSLY. YOU MAY USE THIS IMAGE AS A REFERENCE TO THE BOLT LOCATIONS.

16

REPEAT THE STEPS ON THE OTHER SIDE OF YOUR VEHICLE TO INSTALL THE REMAINING REVERSE MODULE.

#ORACLELIGHTS

TAG US TO SHARE YOUR PROJECT ON SOCIAL MEDIA!