



***advanced FLOW engineering*** BladeRunner – Cold Side Charge Pipe Kit  
**Instruction Manual** P/N: 46-20699-B

Make: **Kia**

Model: **Stinger**

Year: **2022-2023**

Engine: **L4-2.5L (t)**



- Please read the entire instruction manual before proceeding.
- Ensure all components listed are present.
- For technical support please call 951-493-7185.
- Ensure you have all necessary tools before proceeding.
- Do not attempt to work on your vehicle when the engine is hot.
- Retain factory parts for future use.

Label	Qty.	UoM	Description	Part Number
A	1	Ea.	Tube, Cold Side: 46-20699-B	05-61427B
B	1	Ea.	Adaptor, Intercooler: 46-2069X	05-61429
C	1	Ea.	Adaptor, Throttle Body: 46-2069X	05-61430
D	1	Ea.	Coupling, Silicone Elbow Rdr: 2.80" x 2.67" x 66Deg	05-61434
E	1	Ea.	Coupling, Silicone Dbl Elbow Rdr: 3.35" x 2.78"	05-61435
F	1	Ea.	O-Ring, 60mm ID x 2mm W	05-61436
G	1	Ea.	O-Ring, 70mm ID x 5mm W	05-61151
H	3	Ea.	Clamp, SmartSeal, 052 (2.88" – 3.56")	03-50786
J	1	Ea.	Clamp, SmartSeal, 060 (3.25" – 4.06")	03-50790
K	1	Ea.	Screw, Socket Hd Cap: M6 x 1.0 x 16mm	03-50787
M	1	Ea.	Washer, M6 (12mm OD x 6.4mm ID)	03-50177
N	1	Ea.	Plug, Hex Hd Socket: 1/8" NPT (Zn Plt)	03-50029

**Installation will require the following tools:**

7mm, 8mm, 10mm, 12mm sockets , 5mm allen, 3/16" allen, extensions, ratchet, flat screwdriver, pick, teflon tape.

Warranty Information available at <https://afepower.com/contact#warranty>

**Emissions Disclaimer:** This product is not currently CARB exempt and is not available for purchase in California or for use on any vehicle registered with the California Department of Motor Vehicles.

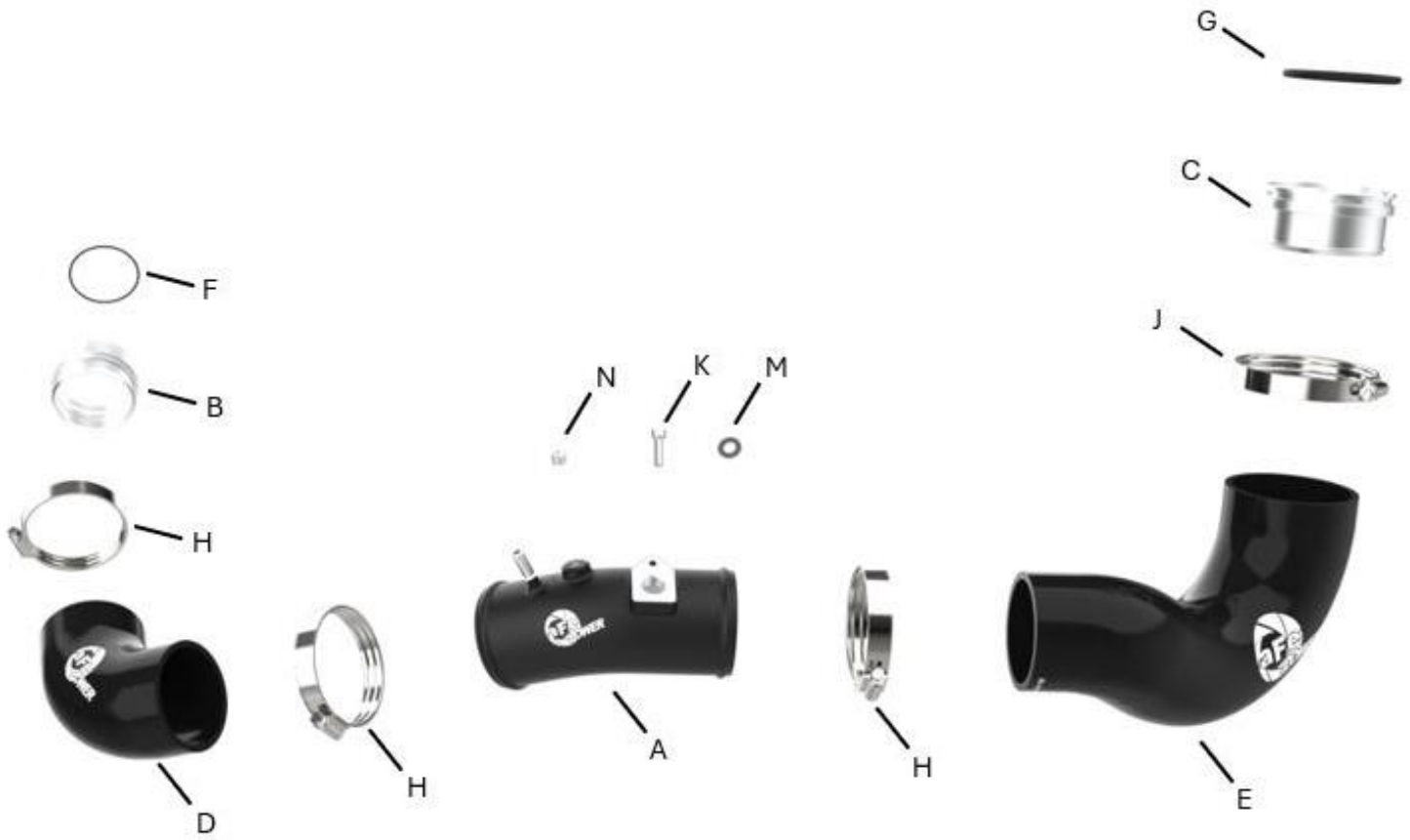

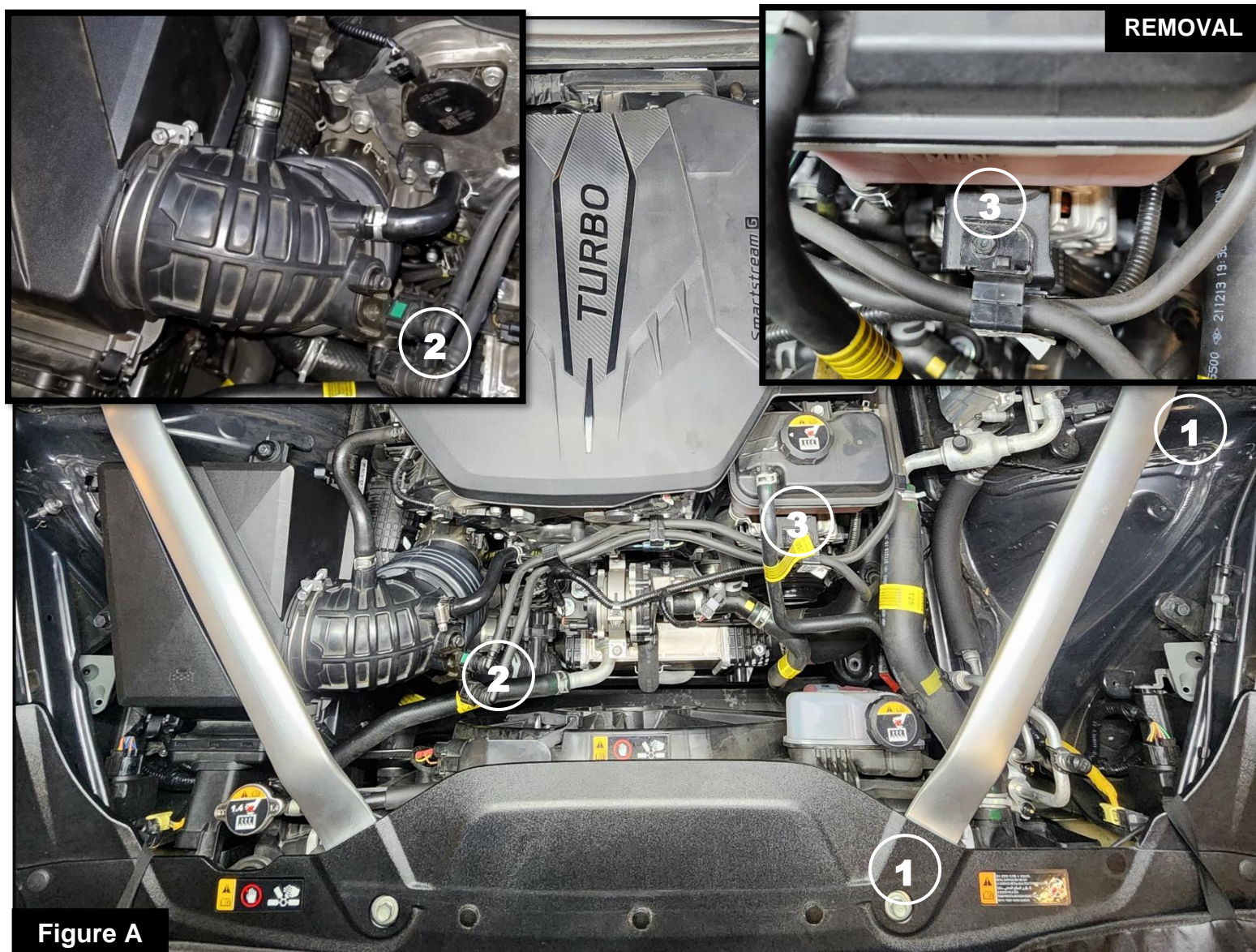

**Figure A**

### **Refer to Figure A for Steps 1-4**

Step 1: Disconnect the negative battery cable.

Step 2: Remove the screws securing the drivers side factory strut brace onto the vehicle ① and remove the brace.

Step 3: Squeeze both sides of the vacuum line clips ② to release them, then disconnect the vacuum lines from the air intake tube.

Step 4: Remove the screw securing the vacuum line mounting bracket ③.

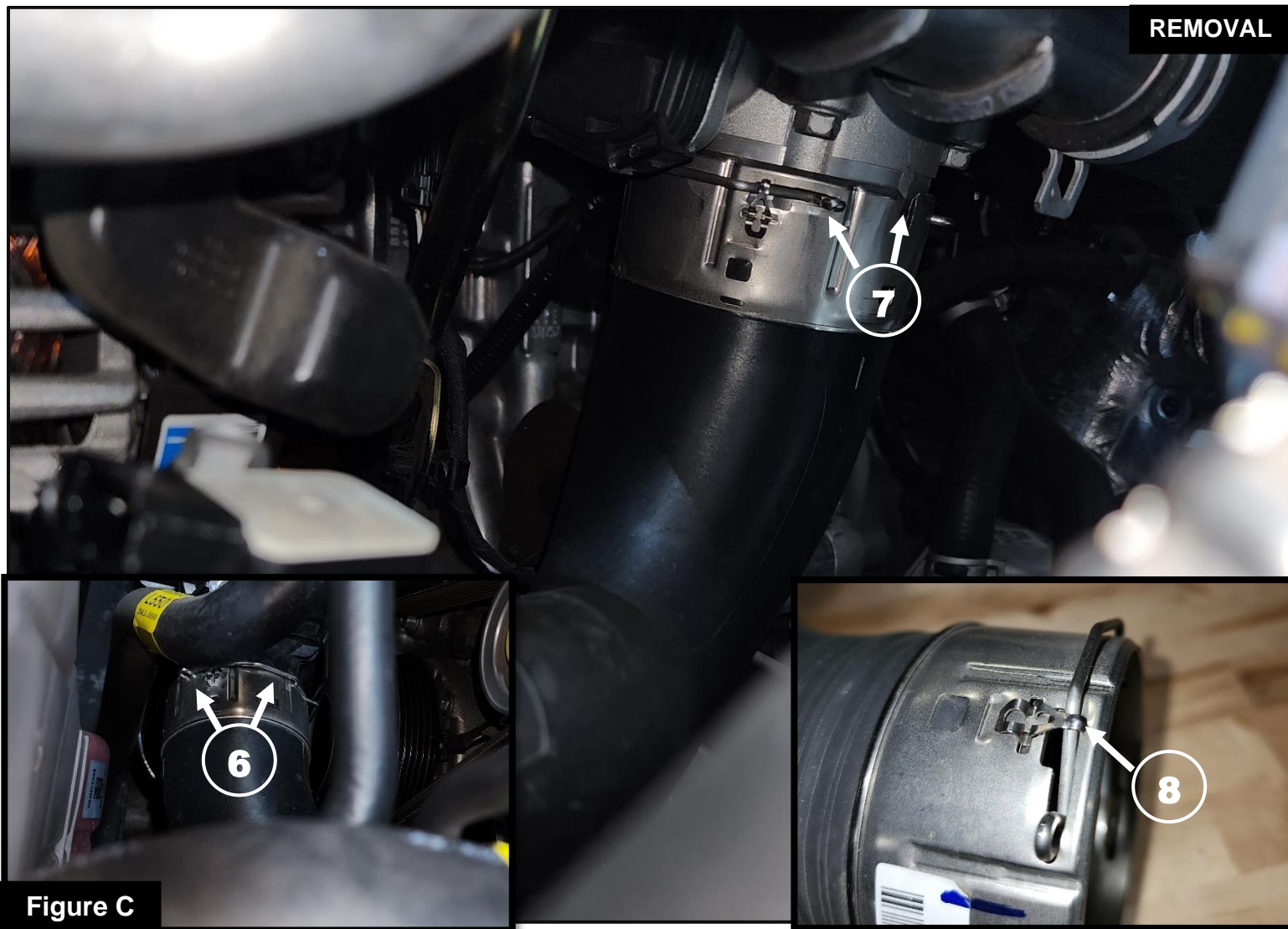



**Figure B**

### **Refer to Figure B for Steps 5-6**

Step 5: Squeeze both clips on the sides of the vacuum line (4) to release it. Then disconnect them from the vacuum port on the cold side charge pipe.

Step 6: Disconnect the Manifold Absolute Pressure (MAP) sensor connector from the sensor (5) on the cold side charge pipe.



### **Refer to Figure C for Steps 7-9**

Step 7: Expand the retaining clip securing the cold side charge pipe onto the intercooler outlet, then disconnect it from the intercooler (6).

Step 8: Expand the retaining clip securing the cold side charge pipe onto the throttle body, then remove the charge pipe from the vehicle (7).

Step 9: Remove the factory retaining clips from the cold side charge pipe (8). Do this by gently lifting the tabs up on each side and sliding the clips out of slots, set aside for later use.





**Figure D**

## **Refer to Figure D for Steps 10-12**

**Note: Be sure to use thread sealant on the plug or sensor to prevent any leaking**

Step 10: If you are not using any aftermarket sensors, install the supplied 1/8" NPT plug into the threaded fitting on the aFe POWER cold side charge pipe ⑨

**Note: Be sure to lubricate the O-ring with grease to prevent it from tearing during installation.**

Step 11: Transfer the MAP sensor from the factory charge pipe to the aFe POWER cold side charge pipe ⑩

Step 12: Secure the MAP sensor using the supplied M6x1.0x16 screw and M6 washer.

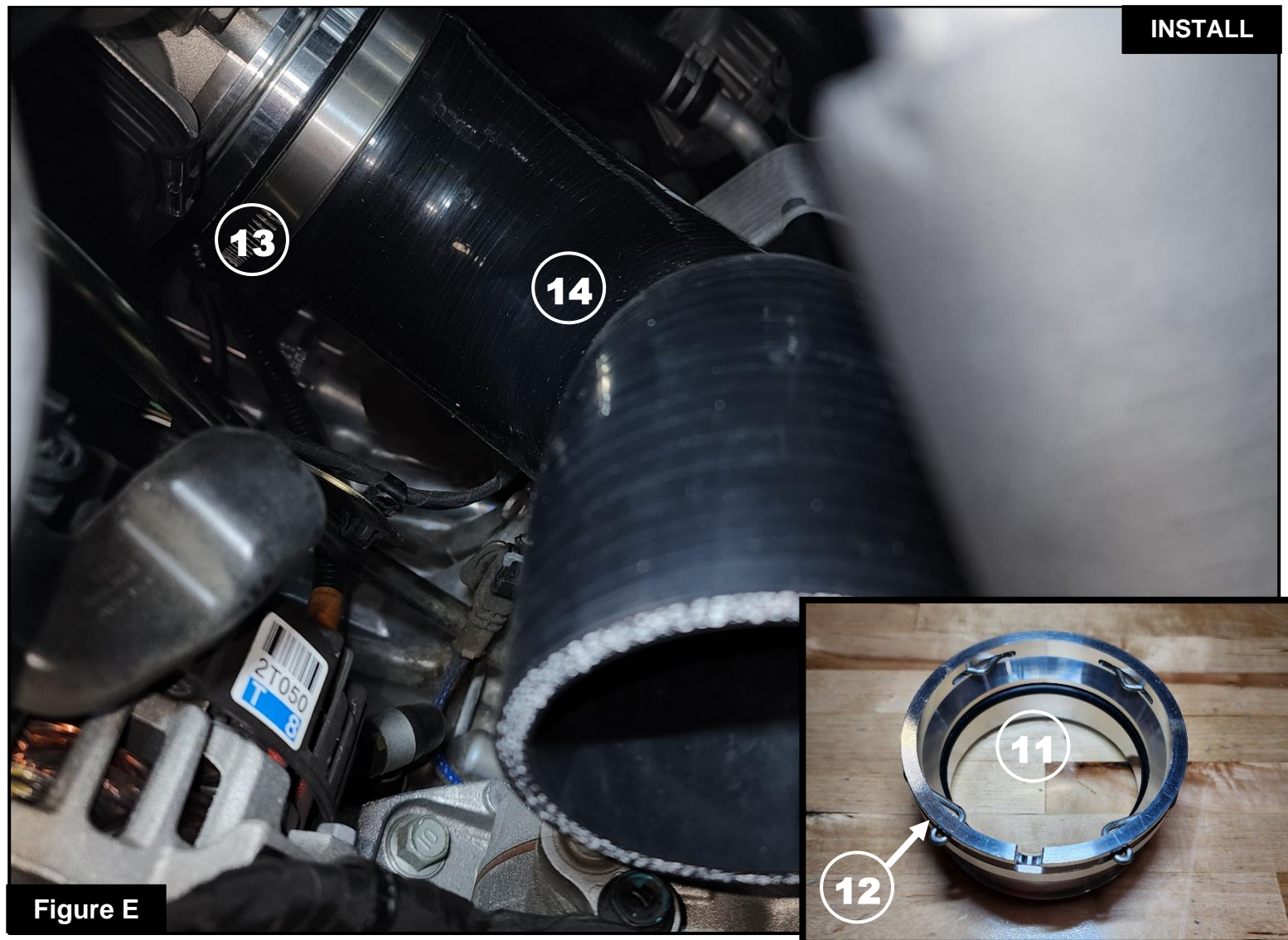
**Figure E**

## **Refer to Figure E for Steps 13-16**

**Note: Be sure to lubricate the O-ring with grease to prevent it from tearing during installation.**

Step 13: Install the 70mm ID x 5mm W O-ring into the groove on the inside of the supplied aFe POWER throttle body adaptor (11)

Step 14: Install the factory throttle body retaining clip from Step 9 onto the aFe POWER throttle body adaptor (12)

Step 15: Install the aFe POWER throttle body adaptor into the supplied aFe POWER silicone double elbow reducer coupling, 3.35" x 2.78", and secure it with the supplied 060 SmartSeal clamp (13)

Step 16: Install the aFe POWER throttle body adaptor with coupling onto the throttle body (14) ensure the retaining clip snaps into place all the way around.

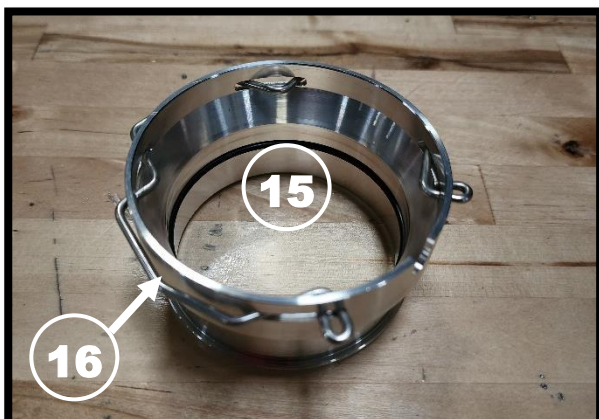

**Figure F**

## **Refer to Figure F for Steps 17-19**

***Note: Be sure to lubricate the O-ring with grease to prevent it from tearing during installation.***

Step 17: Install the 60mm ID x 2mm W O-ring into the groove on the inside of the supplied aFe POWER intercooler adaptor (15)

Step 18: Install the factory intercooler adaptor retaining clip from Step 10 onto the aFe POWER intercooler adaptor (16)

Step 19: Install the aFe POWER intercooler adaptor onto the intercooler outlet (17) ensure the retaining clip snaps into place all the way around and that the O-ring stays in its groove.

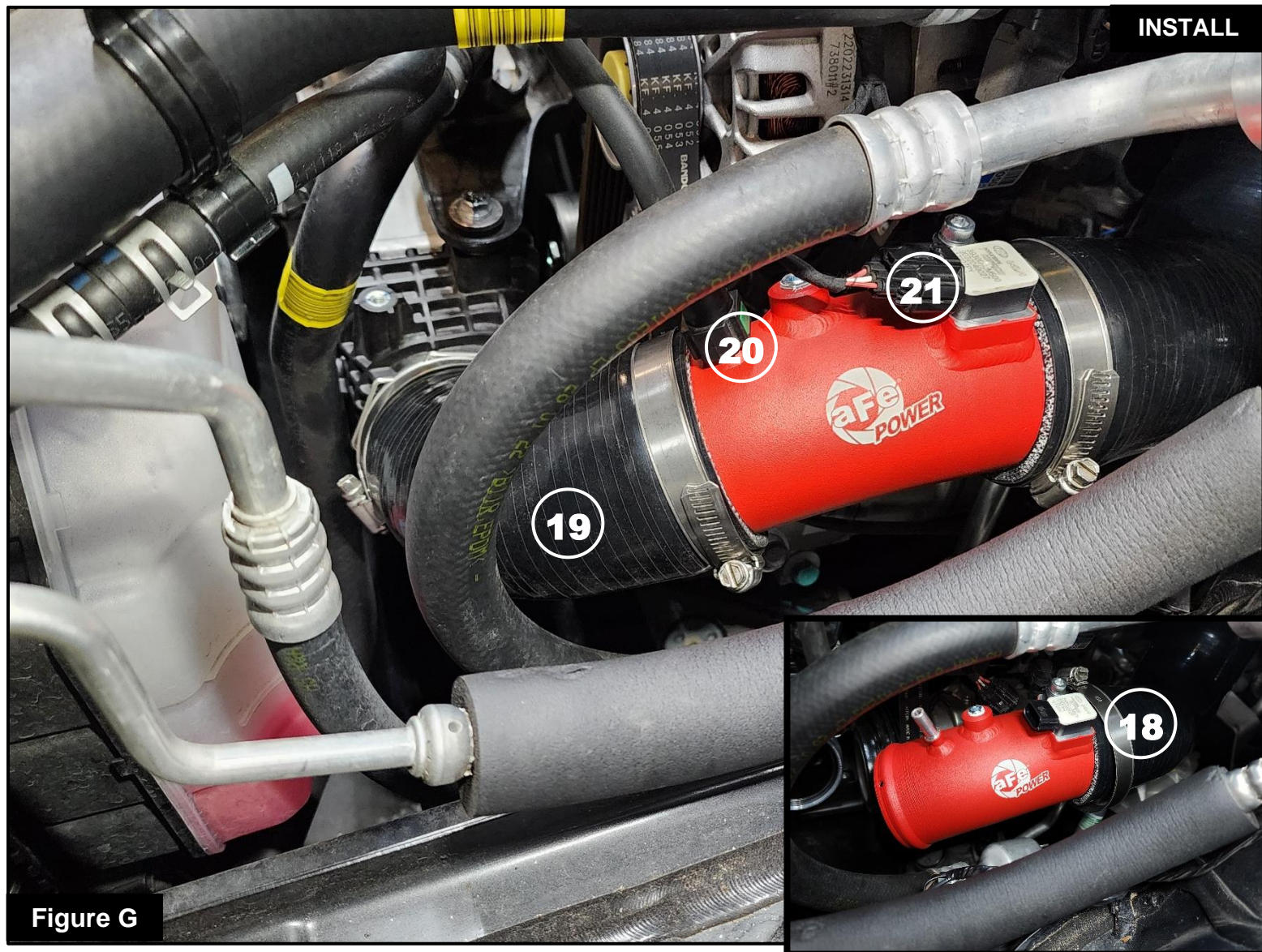

### **Refer to Figure G for Steps 20-23**

Step 20: Install the aFe POWER cold side charge pipe into the throttle body coupling along with one 052 SmartSeal clamp (18) do not tighten the clamp yet.

Step 21: Install the supplied aFe POWER silicone elbow reducer coupling, 2.80" x 2.67" x 66Deg, with two 052 SmartSeal clamps connecting the intercooler adaptor to the cold side charge pipe (19) do not tighten the clamps yet.

Step 22: Connect the vacuum line to the fitting on the aFe POWER cold side charge pipe and adjust the tube as necessary ensuring there is nothing touching (20) then tighten all of the clamps.

Step 23: Reconnect the MAP sensor electrical connector to the sensor (21)



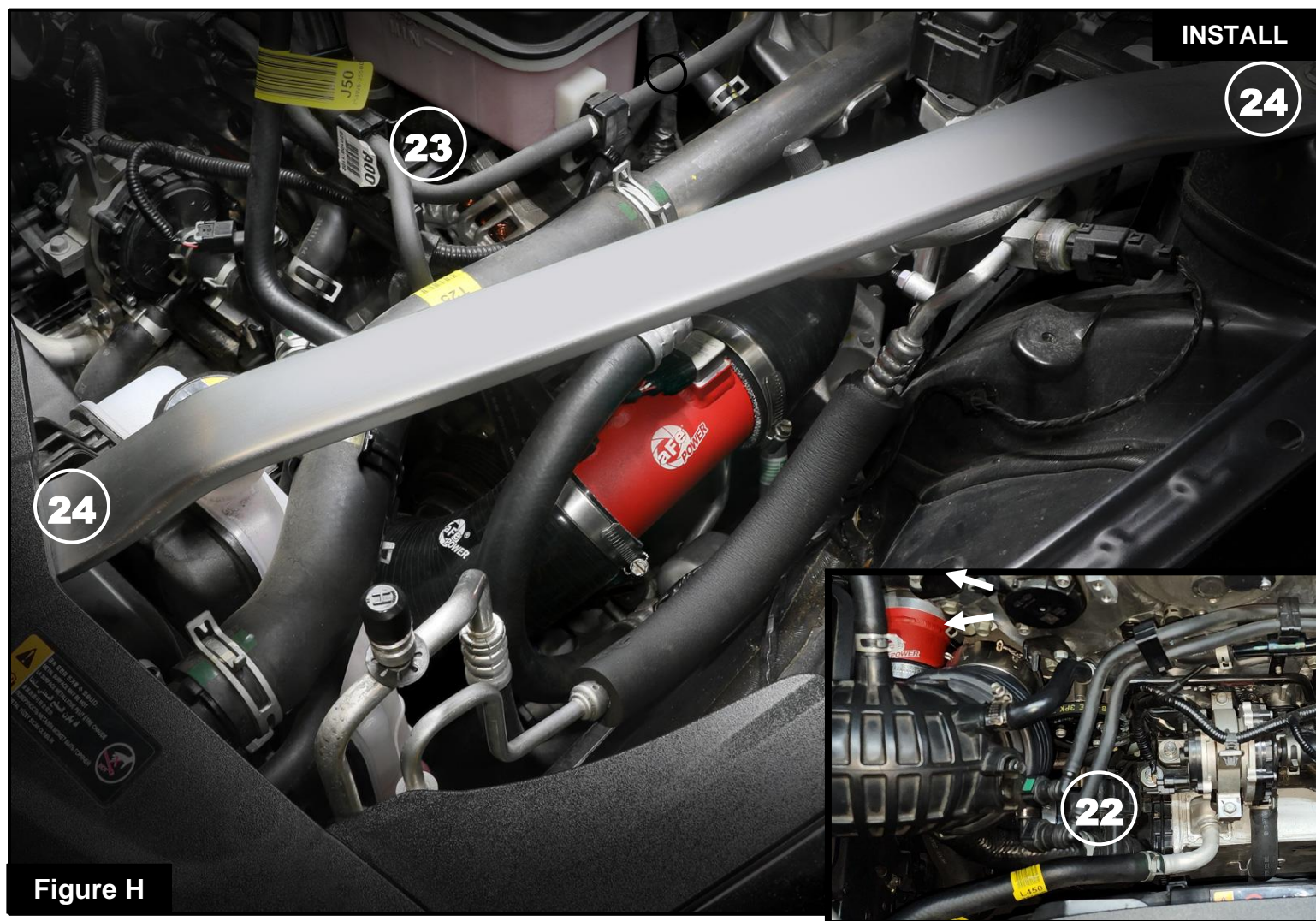

**Figure H**

## **Refer to Figure H for Steps 24-28**

Step 24: Reconnect the vacuum hoses to onto the air intake tube (22)

Step 25: Secure the vacuum lines to their mount (23)

Step 26: Reinstall the drivers side strut brace into the vehicle (24)

Step 27: Reconnect the negative battery cable.

Step 28: Install is now complete.

**NOTE: Check all clamps, and connectors are secure after 100-200 miles**



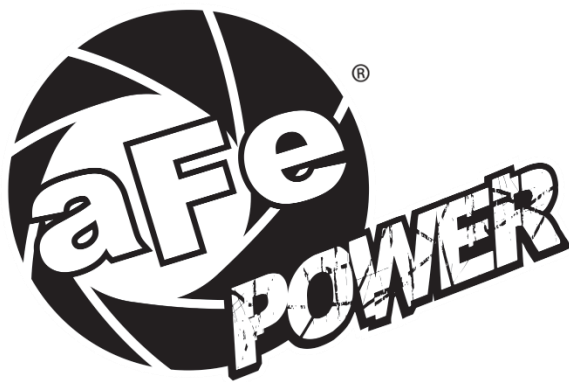

***advanced FLOW engineering, inc.***

Corona, CA 92879

<https://afepower.com/contact>