



PORSCHE FOILER™ WIND DIFFUSER INSTALLATION GUIDE:

Vehicle Fitment:

- **Porsche 992 (All Models)**

Welcome to the AWE family! By purchasing this **AWE Foiler™ Wind Diffuser** you are showing your Porsche that 'sound' matters; some sounds are unwelcome, and will be silenced ...*discretely*.

Installation questions?
[CONTACT US](#)

PARTS LIST



INSPECT ALL PARTS PRIOR TO DISASSEMBLY OF VEHICLE; IF DAMAGED OR MISSING, PLEASE CONTACT THE PLACE OF PURCHASE IMMEDIATELY.

Foiler™ Wind Diffuser Parts:

- 1 Driver side Foiler™ 200003
- 1 Passenger side Foiler™ 200004

Tools Required:

- Flat trim removal tool
- T-20 Torx bits

STEP 1



Always refer to the manufacturer service manual for precise torque specifications on all OEM fasteners.



Climate Warning: Plastic becomes brittle in colder climates and can break easily if mishandled.

Using a flat trim removal tool, remove the interior triangle trim piece on the door panel shown at the arrow in **Figure 1-1**. Start at the bottom and pry upwards. Once the part is free, the wiring will still be attached, as shown in **Figure 1-2**. Just leave the part hanging while you work.

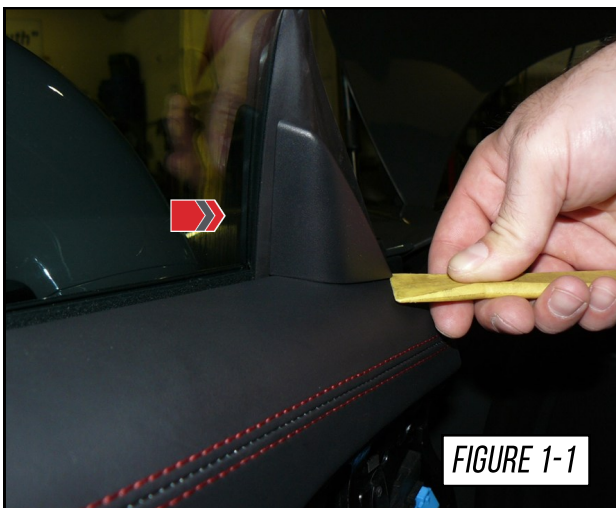

STEP 2

From inside the door, remove the T-20 Torx screw holding the exterior OE plastic triangle piece in place, at the arrow in **Figure 2-1**. The removed screw is shown in **Figure 2-2**.

Note: OE screw may be sliver or black.



STEP 3

Once the screw is removed, lift up and out on the OE exterior trim piece and it will come right out. The removed OE part is shown in **Figure 3-1** and **3-2**.

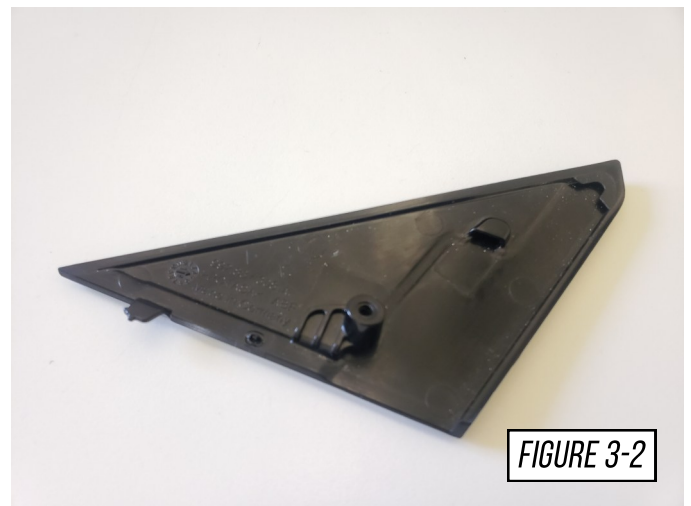
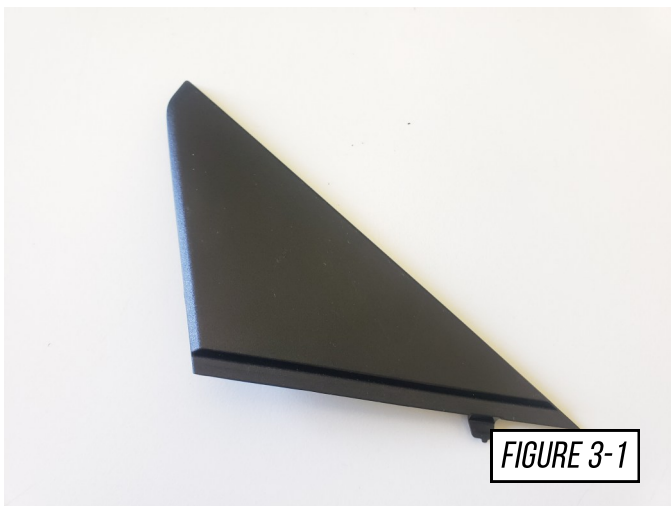

STEP 4

The AWE Foiler™ is located and aligned on the door by 2 pockets and 1 tab, as shown in **Figure 4**.



FIGURE 4

STEP 5

Mount the AWE Foiler™ on the car in the same orientation as how the factory trim piece was mounted.

Slide the upper mounting points and the bottom tab first to ensure the Foiler™ is properly attached.

Fasten the lower mounting point using the factory T-20 Torx screw.



Gently hold the AWE Foiler™ in place while tightening to ensure the final placement is as desired.



FIGURE 5



CAUTION: Hand tighten the screw *ONLY*. Do everything in your power to **NOT** over-tighten this screw!

STEP 6

Reinstall the interior trim components removed earlier, to achieve this, push down and in till the part clips into place, as shown in **Figure 6-1**.

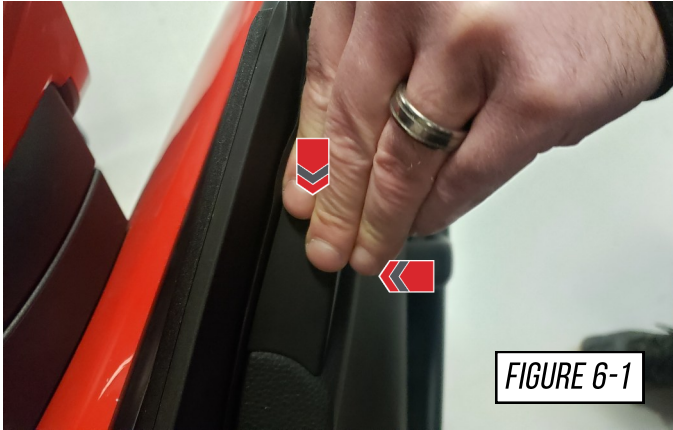

ENJOY!



CARE

Once installed, the AWE Foiler™ will eliminate wind buffeting in the interior of the vehicle when only one window is in the down position.

Avoid using polishes or waxes on injection molded parts, the compound can be difficult to remove from the porous surface finish.

Any questions or comments,
please do not hesitate to contact us:

AWE
199 Precision Drive
Horsham, PA 19044
215-658-1670
[CONTACT FORM](#)

WARRANTY

Up-to-date warranty information is found **[HERE](#)**.