

***advanced FLOW engineering***

Cold Air Intake System

**Instruction Manual** P/N: 54-13083D / 54-13083R

Make: **RAM**

Model: **1500 RHO**

Year: **2025-2026**

Engine: **L6-3.0L(tt) Hurricane**



- Please read the entire instruction manual before proceeding.
- Ensure all components listed are present.
- For technical support please call at 951-493-7185.
- Ensure you have all necessary tools before proceeding.
- Do not attempt to work on your vehicle when the engine is hot.
- Retain factory parts for future use.

Label	Qty.	Description	Part Number
A	1	Air Filter (Pro DRY S) for 54-13083D	24-91205D
A	1	Air Filter (Pro 5R) for 54-13083R	24-91205R
B	1	Tube, mounted on the engine	05-5070120B1
C	1	Tube, with sensor pad	05-5413083B3
D	1	Housing	05-5413083B2
E	1	Coupler, Bellow: 4-1/4" ID	05-01430
F	1	Coupler, Reducer: 4-1/4" to 4" ID	05-01768
G	1	Plug, for housing auxiliary inlet	05-01769
H	3	Worm Clamp, #072	03-50010
J	1	Worm Clamp, #064	03-50006
K	2	Screw, Torx: M4 x 10mm	03-50490
M	2	Cable holder for 7/16" Diameter	05-01770

**Installation will require the following tools:**

8mm nut drivers or socket, 10mm, 13mm sockets and ratchet, 6" extension, Clip removal tool, T20 torx bit, Adjustable wrench.

Warranty information available at <https://afepower.com/warranty>

**Emissions Disclaimer:**

This product is not currently CARB exempt and is not available for purchase in California or for use on any vehicle registered with the California Department of Motor Vehicles.

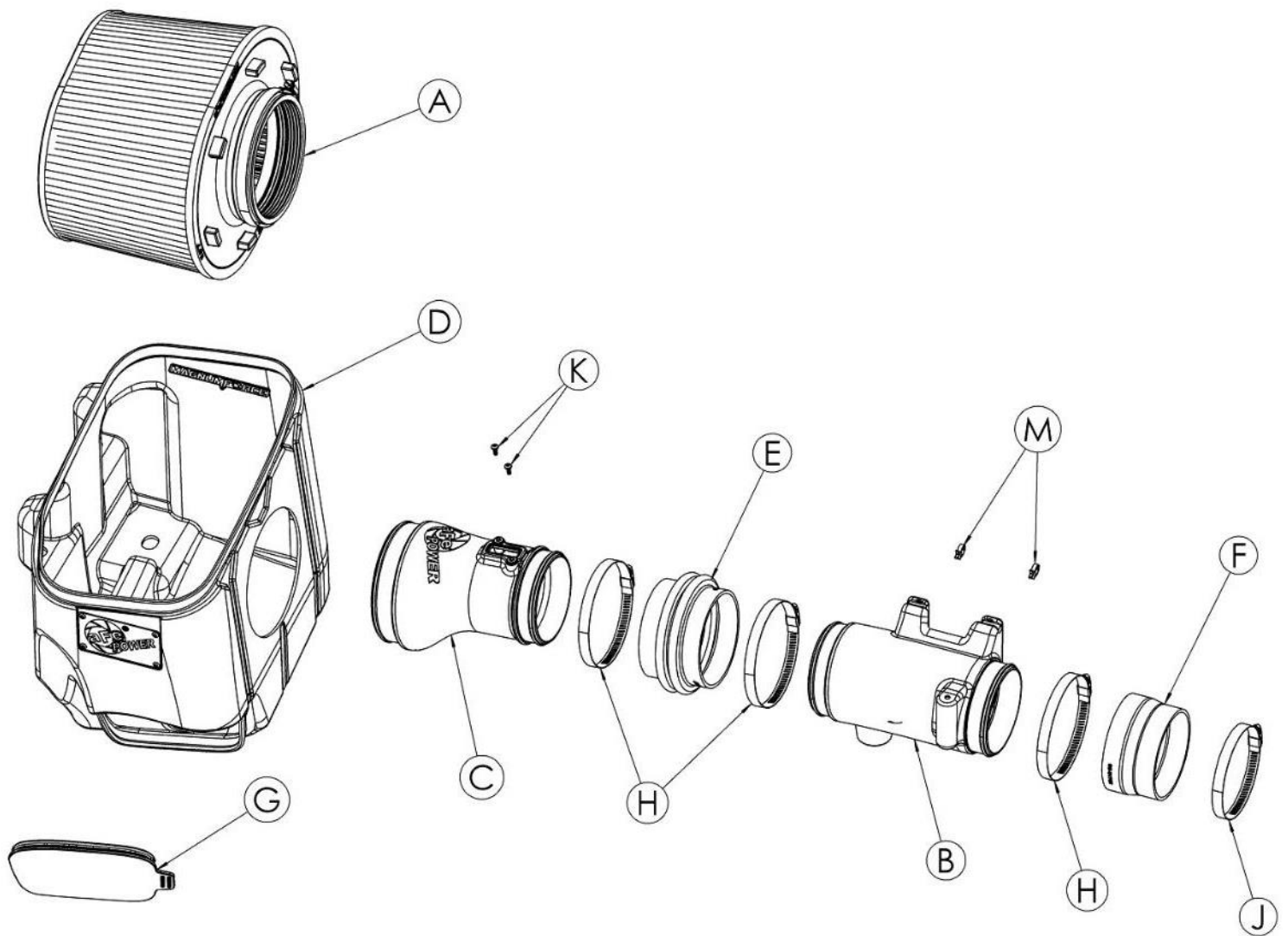





**Figure A**

### **Refer to Figure A for Steps 1-2**

Step 1: Using a 13mm socket and ratchet, remove the nut securing the engine cover.

Step 2: Remove the engine cover.





### **Refer to Figure B for Step 3**

Step 3: Carefully release the coolant line from the retaining clips along the air intake tube path. Gently tuck the line behind the oil filler neck to keep it out of the way during the installation process.



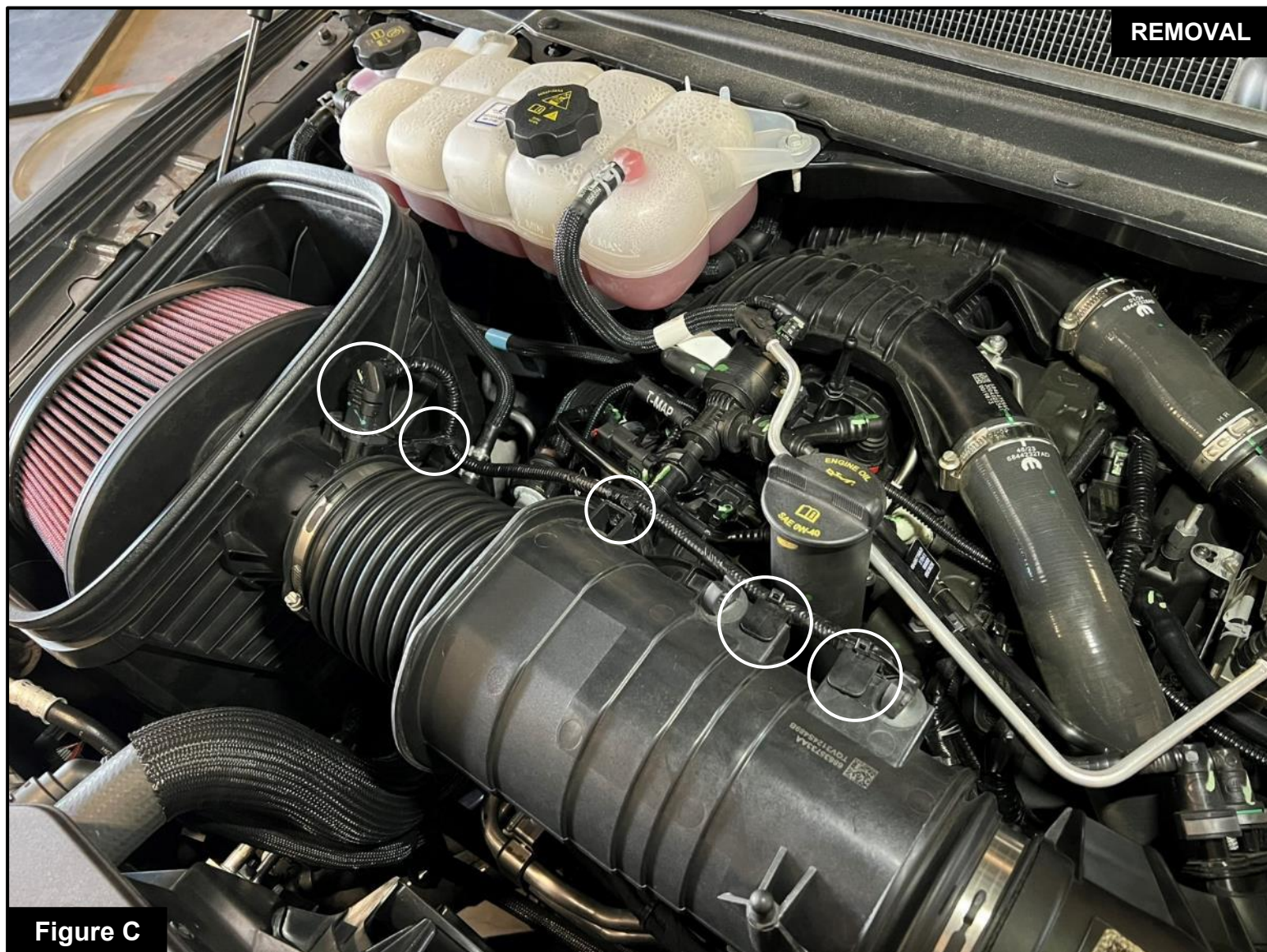

**Figure C**

### **Refer to Figure C for Steps 4-5**

Step 4: With a plastic pry tool or trim removal tool, gently pop out the four retaining clips that hold the Mass Air Flow (MAF) sensor harness in place, tuck the harness behind the oil filler neck to keep it out of the way. Be careful not to damage the wiring.

Step 5: Push the locking clip outward, then press down on the release tab to disconnect the MAF sensor connector.



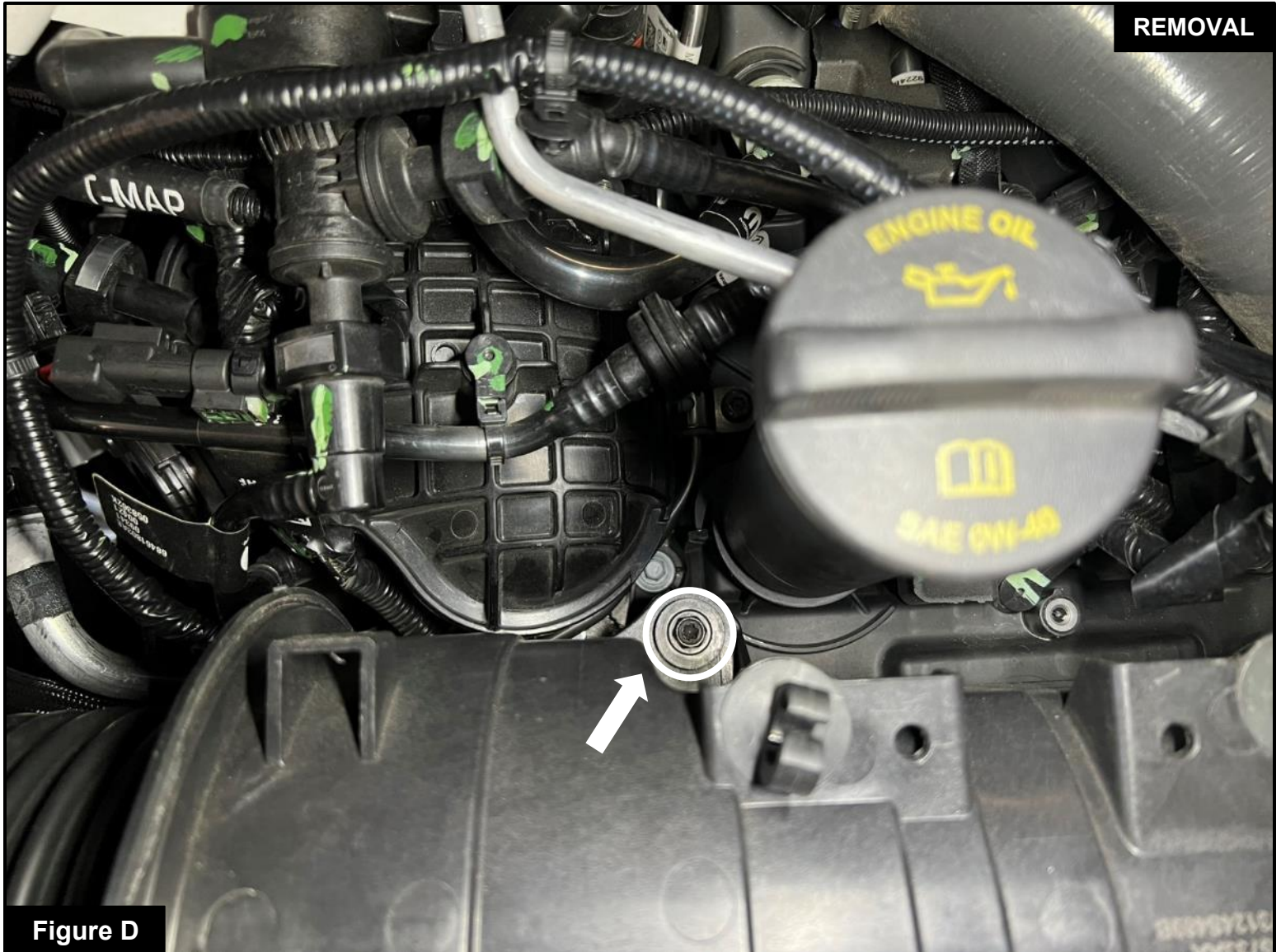
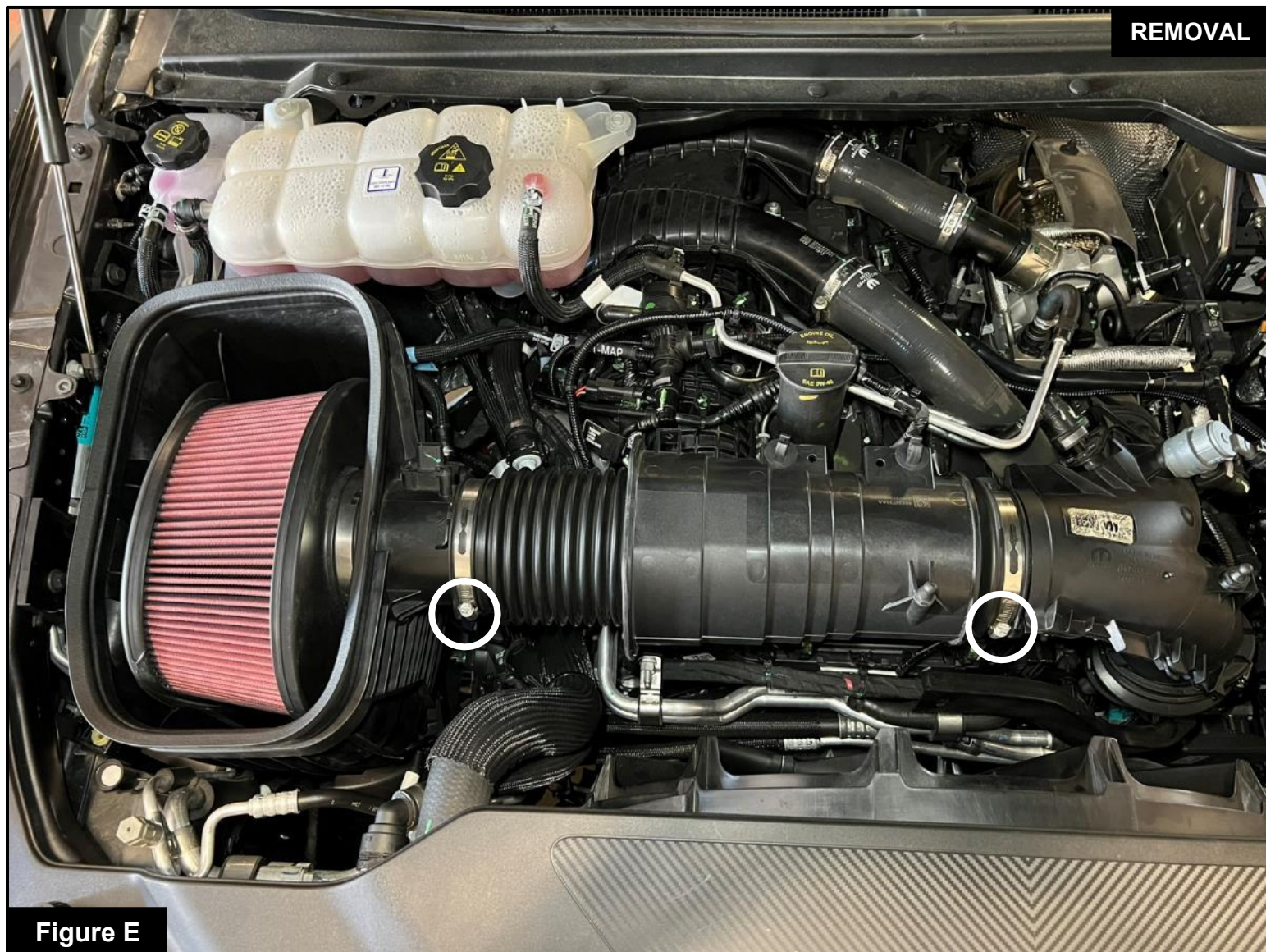

Figure D

### **Refer to Figure D for Step 6**

Step 6: Using a 10mm socket with an extension and a ratchet, remove the screw securing the intake tube to the vehicle. The screw will be reused later in the installation.





### **Refer to Figure E for Step 7**

Step 7: Using an 8mm nut driver, loosen the clamps securing the intake tube to the turbo inlet tube and airbox. Once loosened, carefully remove the intake tube by sliding it off both sides.



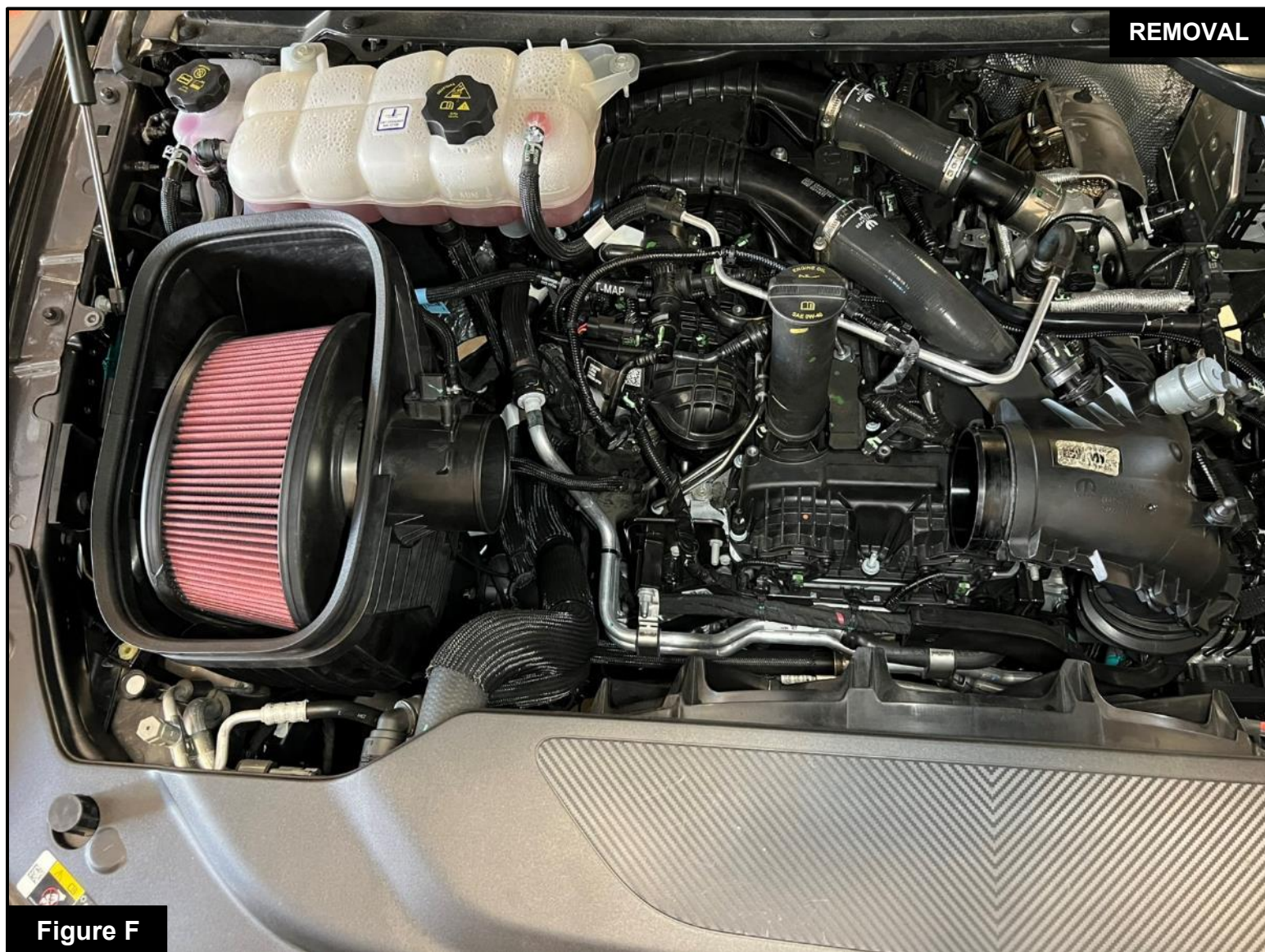

## **Refer to Figure F for Step 8**

Step 8: Firmly grasp the airbox and pull straight up to release the grommets from the mounting pegs. Lift the airbox out of the vehicle.





### **Refer to Figure G for Steps 9-10**

Step 9: Transfer the (5) five factory grommets from the bottom of the factory airbox to the Magnum Force housing.

Step 10: Transfer the duckbill drain plug as well.





**Figure H**

**Refer to Figure H for Step 11**

Step 11: Transfer the factory seal trim from the factory airbox to the Magnum Force housing.

**Figure I****Refer to Figure I for Step 12**

Step 12: Install the provided silicone plug into the front inlet of the Magnum Force housing.





Figure J

### **Refer to Figure J for Step 13**

Step 13: Install the aFe POWER housing assembly into the vehicle, aligning the grommets on the housing with the factory mounting pegs. Press down firmly to sit the housing securely.





Figure K

### **Refer to Figure K for Step 14**

Step 14: Remove the air filter clamp from the aFe POWER air filter. Slide the air filter into the aFe POWER housing from the top opening. Then guide the filter flange through the round opening in the housing and snap in the air filter. Orient the air filter as shown in the picture. Place the clamp on the air filter flange.



**Figure L****Refer to Figure L for Step 15**

Step 15: Transfer the Mass Air Flow (MAF) sensor from the factory housing to the aFe POWER intake tube.  
Secure it with the provided black screws using a T20 Torx bit or driver.

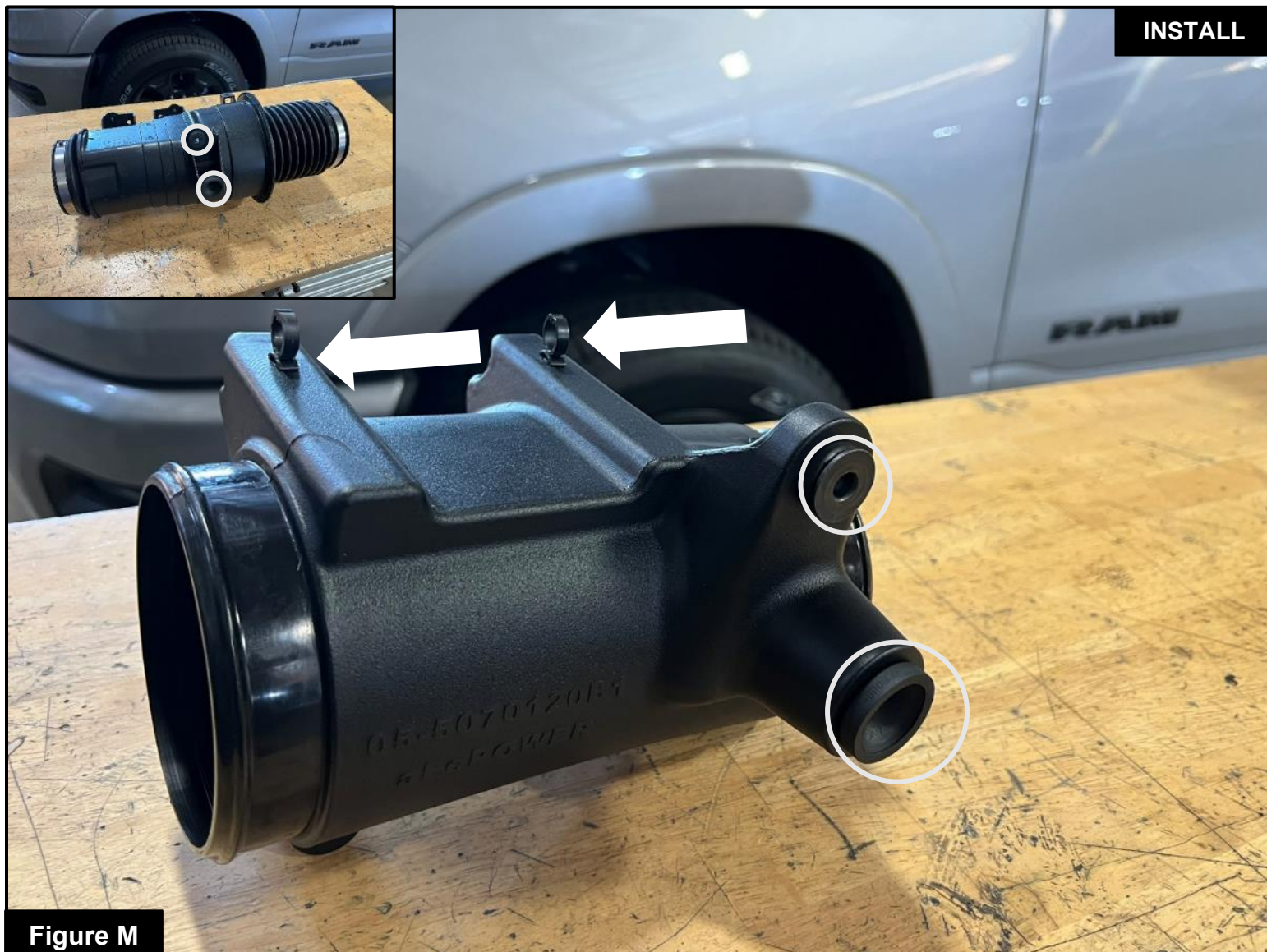

INSTALL

Figure M

### **Refer to Figure M for Steps 16-18**

Step 16: Remove the metal sleeve from the smaller grommet on the factory intake tube, then transfer the grommet to the aFe POWER intake tube that is going to be mounted on the engine.

Step 17: Transfer the larger grommet from the factory intake tube to the aFe POWER intake tube. Make sure it is fully seated and aligned properly.

Step 18: Install the two provided cable holders into the aFe POWER intake tube, press them firmly into place as shown





Figure N

## **Refer to Figure N for Step 19**

Step 19: Install reducer coupler with the smaller end positioned over the turbo inlet. Use the provided #64 clamp to secure the coupler to the turbo inlet using an 8mm nut driver. Then, loosely slide a #72 clamp over the larger end of the coupler. Do not tighten clamp at this time.





Figure O

## Refer to Figure O for Steps 20-21

Step 20: Slide the aFe POWER intake tube into the open end of the coupler, ensuring it sits fully. Then, press down on the tube so the grommet aligns and sits securely onto the factory mounting peg. Tighten the clamp to secure the intake tube.

Step 21: Use a 10mm driver or ratchet wrench to install the screw that was removed on **Step 6** to secure the intake tube.





**Figure P**

## **Refer to Figure P for Step 22**

Step 22: Pre-install the two #72 clamps onto each end of the bellow coupler. Then, slide the coupler onto the end of the intake tube.



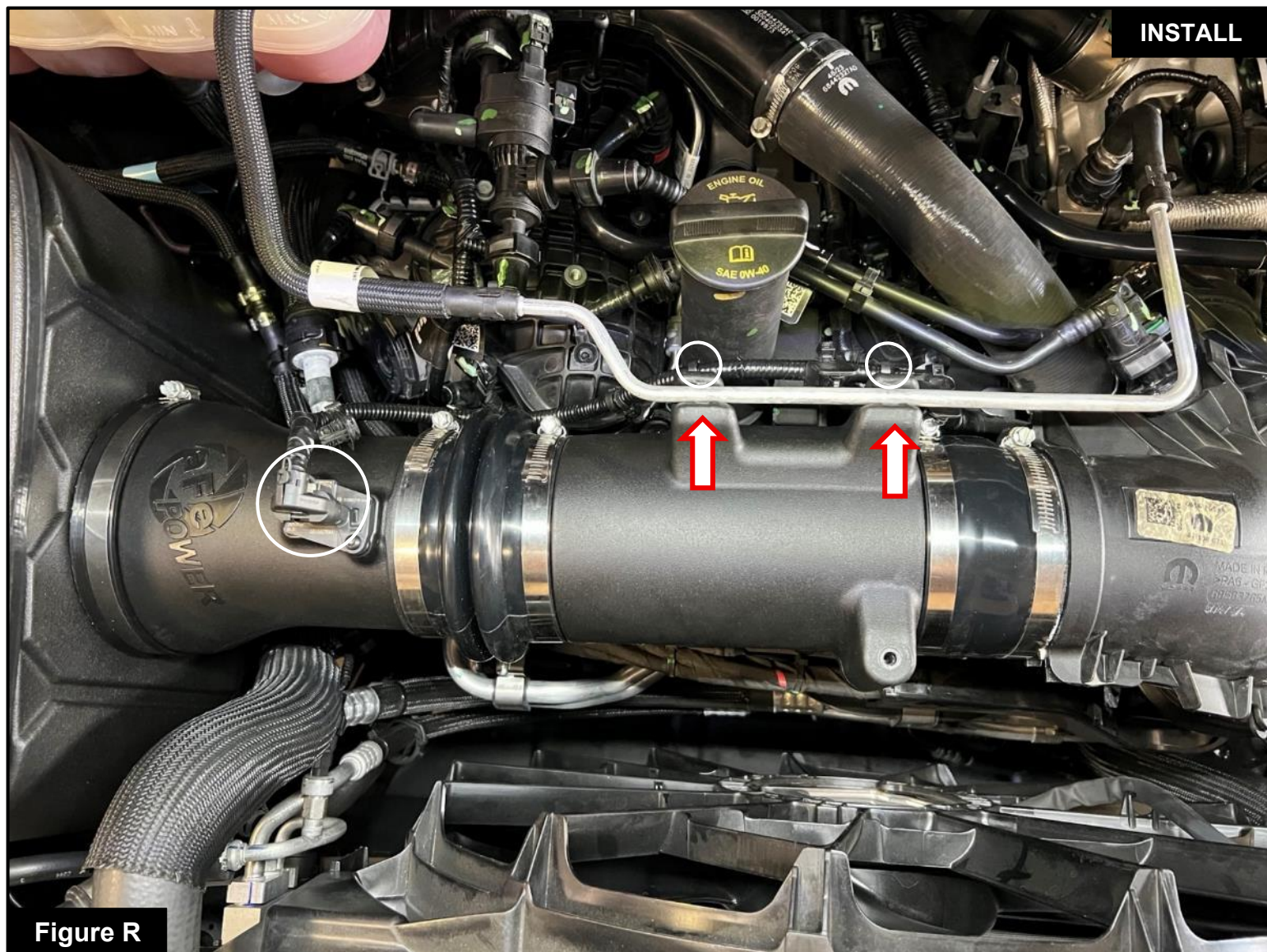

Figure Q

### **Refer to Figure Q for Step 23**

Step 23: Install the intake tube with the sensor by first sliding it into the coupler, then into the air filter. Ensure both ends are fully seated, and make sure the MAF sensor is pointing straight up. Once properly aligned, tighten all clamps securely using an 8mm nut driver.





**Figure R**

## **Refer to Figure R for Steps 24-25**

Step 24: Secure the MAF sensor harness onto the clips installed on Step 18, then reconnect the harness to the MAF sensor by pressing the connector in until it clicks.

Step 25: Clip the coolant line onto the intake tube.



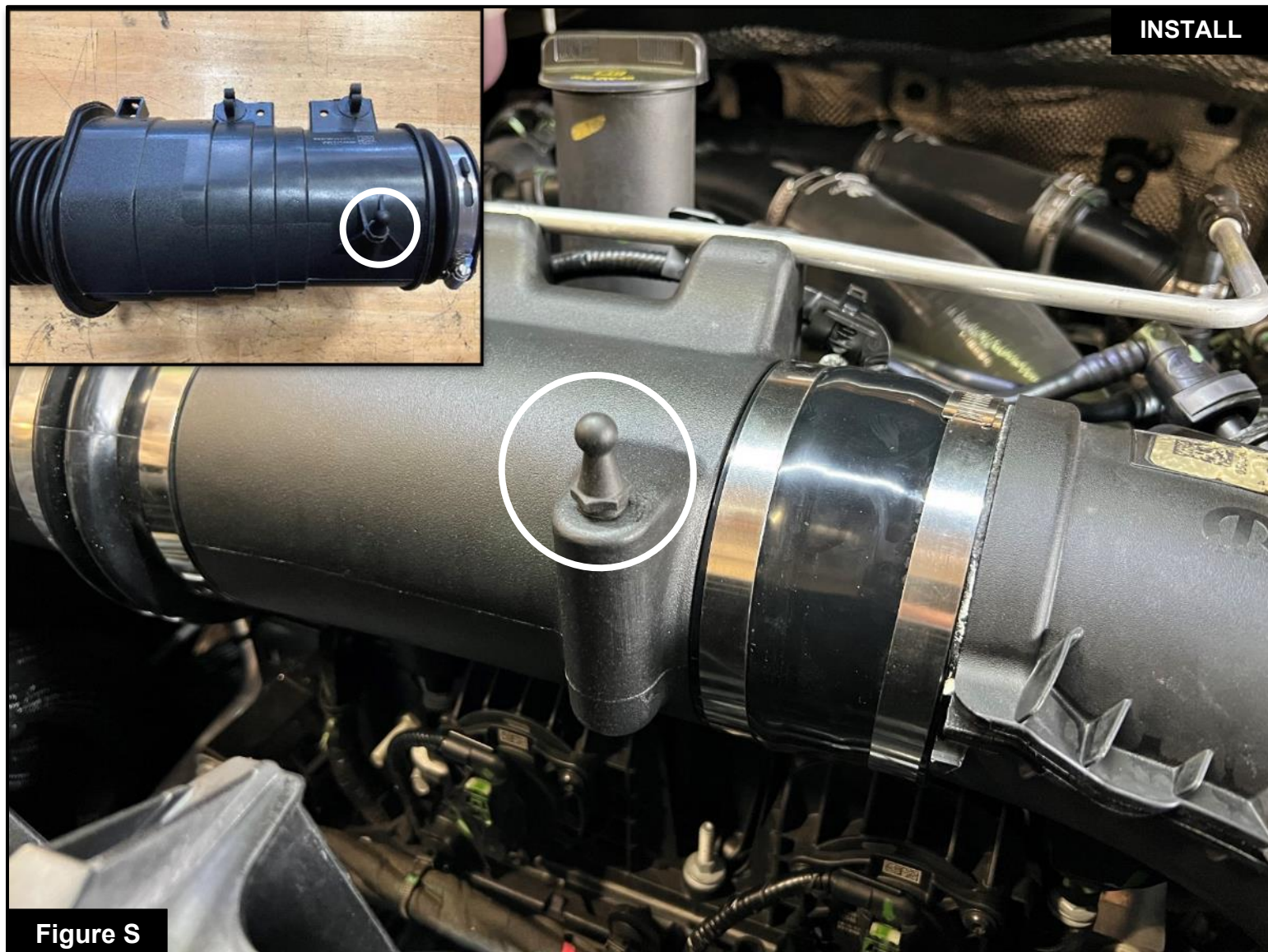

**Figure S**

## **Refer to Figure S for Step 26**

Step 26: Using an adjustable wrench, carefully remove the engine cover mounting peg on the factory tube. Then screw it onto the hole on the aFe POWER intake tube.





**Figure T**

### **Refer to Figure T for Step 27**

Step 27: Re-install the engine cover by securing it onto the peg on the bracket then using the nut that was removed on **Step 1**.

**Your installation is now complete. Thank you for choosing aFe POWER!**

**NOTE: Check to ensure that all screws, clamps, and connectors are secure after 100-200 miles.**



***advanced FLOW engineering, inc.***

Corona, CA 92879

<https://afepower.com/contact>