

advanced FLOW engineering BladeRunner – Cold Side Charge Pipe Kit

Instruction Manual P/N: 46-20819-B

Make: RAM

Model: 2500

Year: 2025–2026

Engine: L6-6.7L(td)

Make: RAM

Model: 3500

Year: 2025–2026

Engine: L6-6.7L(td)



- Please read the entire instruction manual before proceeding.
- Ensure all components listed are present.
- For technical support please call 951-493-7185.
- Ensure you have all necessary tools before proceeding.
- Do not attempt to work on your vehicle when the engine is hot.
- Retain factory parts for future use.

Label	Qty.	UoM	Description	Part Number
A	1	Ea.	Tube, Cold Side: 46-20819-B	05-61736B
B	1	Ea.	Coupling, Silicone Reducer:(3-1/2"x3")ID x 3-1/2"L	05-60097
C	1	Ea.	Coupling, Silicone Elbow: 3"ID x 45 Deg	05-60433
D	3	Ea.	Clamp, Spring Loaded T-Bolt: (3.25" - 3.5") (ss)	05-60530
E	1	Ea.	Clamp, Spring Loaded T-Bolt: (3.75" - 4") (ss)	05-60024
F	2	Ea.	Plug, Hex Hd Socket: 1/8" NPT (Zn Plt)	03-50029

Installation will require the following tools:

- Torque Wrench
- 1/4" Socket Wrench
- 6"-12" Extensions
- 8mm Deep Socket
- 10mm Deep Socket
- 11mm Deep Socket
- 7/16" Deep Socket
- 3/16in Hex Driver
- Flat Head Screwdriver
- Trim Removal Tool Set
- Pick Set
- Thread Sealant

Emissions Disclaimer:

This product is not currently CARB exempt and is not available for purchase in California or for use on any vehicle registered with the California Department of Motor Vehicles.

Warranty Information available at <https://afepower.com/contact#warranty>

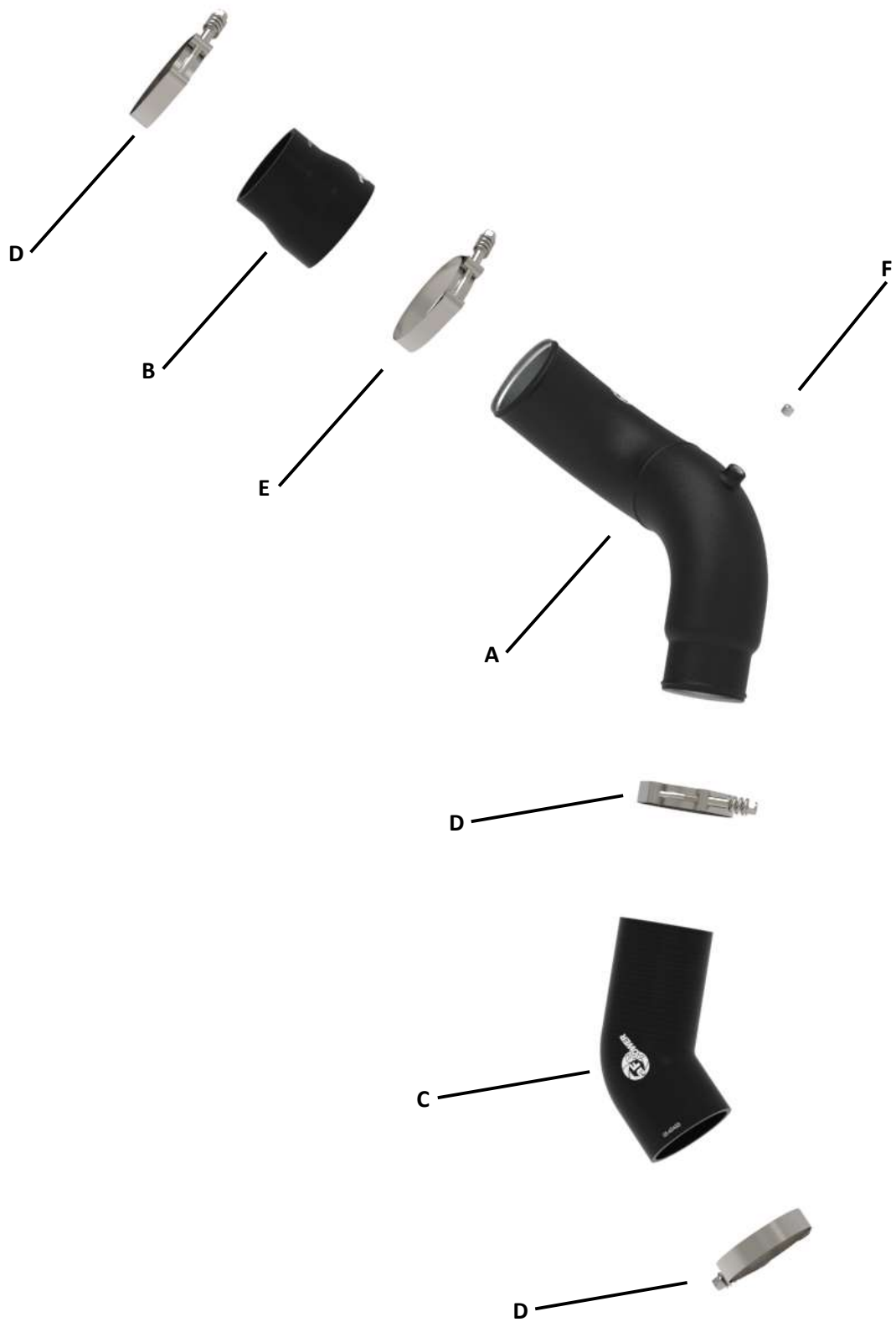

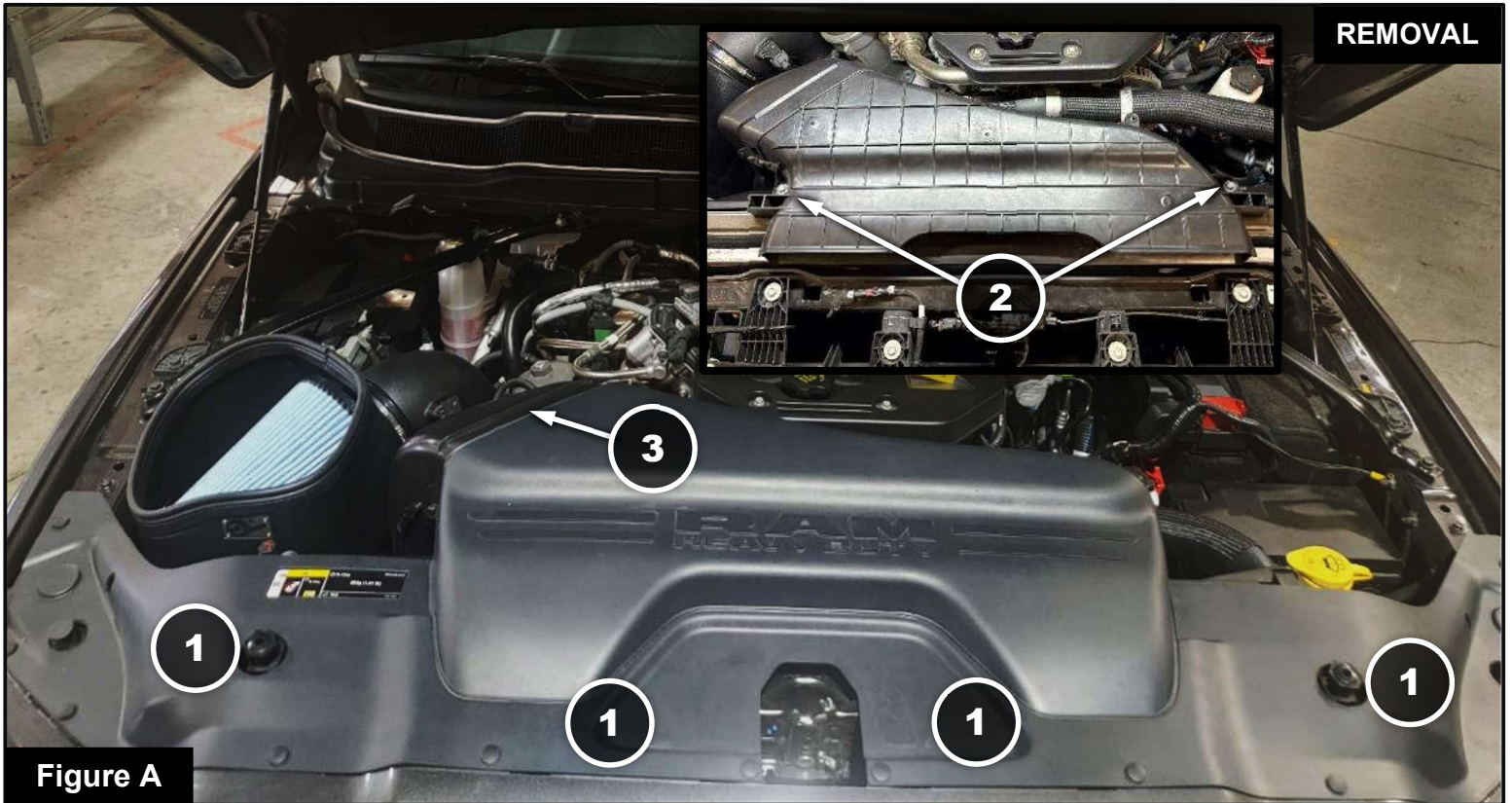

Figure A

Refer to Figure A for Steps 1-6

Step 1: Park vehicle on level ground and engage the parking brake.

Step 2: Disconnect both negative battery cables.

Step 3: Remove the radiator cover by removing the fourteen (14) clips securing it onto the vehicle. (1)

Step 4: Remove the two (2) screws securing the air intake scoop onto the vehicle. (2)

Step 5: Release the air intake scoop from the air intake housing. (3)

Step 6: Remove the air intake scoop from the vehicle.

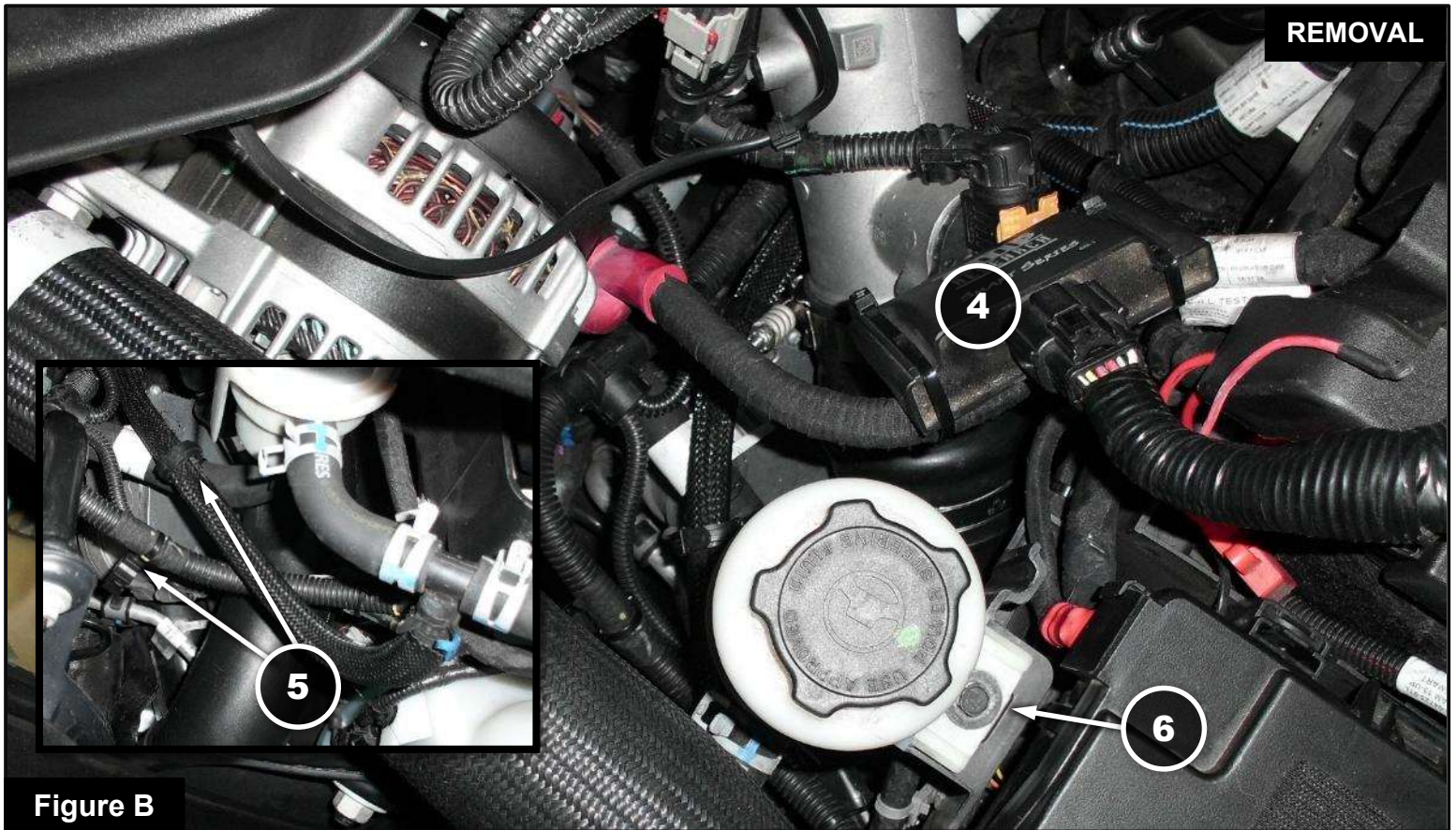

Figure B

Refer to Figure B for Steps 7-10

Step 7: Disconnect the engine harness link and move the connectors aside. ④

Step 8: Disconnect the engine harness and hose routing clips and move aside. ⑤

Step 9: Remove the screw securing the power steering reservoir to the vehicle. ⑥

Step 10: Move the reservoir aside towards the engine to increase access to the cold side charge pipe (wire ties or zip ties may be useful).

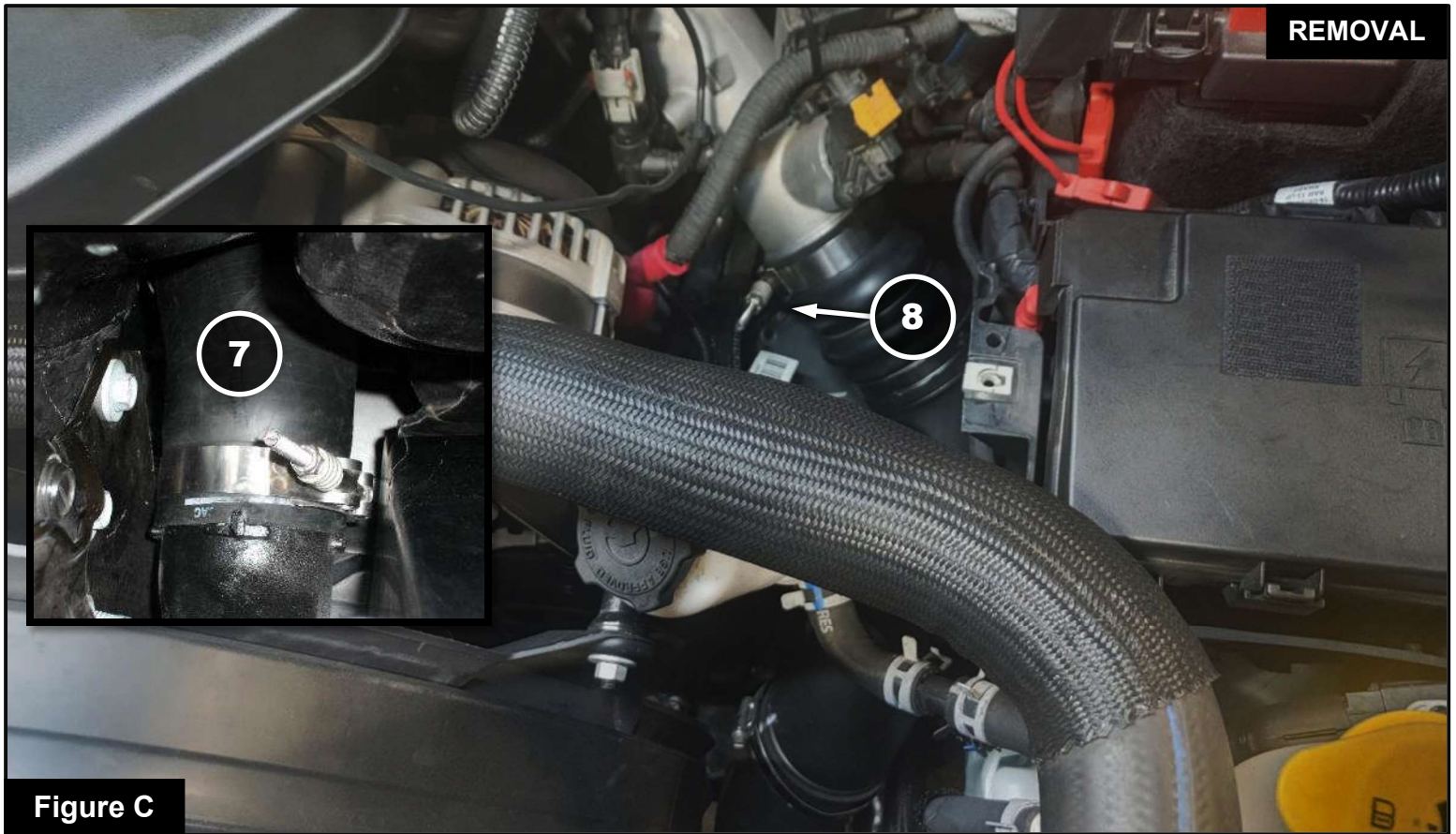

Refer to Figure C for Steps 11-14

Step 11: Underneath the vehicle, loosen the clamp securing the cold side charge pipe coupling to the intercooler. (7)

Step 12: Remove the cold side charge pipe coupling from the intercooler outlet.

Step 13: Loosen the clamp securing the cold side charge pipe to the engine inlet. (8)

Step 14: Disconnect the cold side charge pipe coupling from the engine inlet and remove the cold side charge pipe assembly from the vehicle.

**Figure D****Refer to Figure D for Steps 15-18**

NOTE: Be sure to use thread sealant on the plug or sensor to prevent any leaks.

Step 15: If you are not using any aftermarket sensors, install the supplied 1/8" NPT plug into the threaded fitting on the aFe POWER cold side charge pipe. (9)

Step 16: Install one (1) 3.25"–3.5" spring-loaded T-bolt clamp and the longer side of the aFe POWER 3"ID x 45 Deg silicone elbow coupling onto the 3" reduced end of the aFe POWER cold side charge pipe; leave the clamp loose. (10)

Step 17: Install one (1) 3.75" - 4" spring-loaded T-bolt clamp and the aFe POWER silicone reducer coupling onto the 3-1/2" side of the aFe POWER cold side charge pipe, pushing the coupling as far onto the charge pipe as possible; leave the clamp loose. (11)

Step 18: Adjust the couplings in a similar orientation to the original cold side charge pipe.

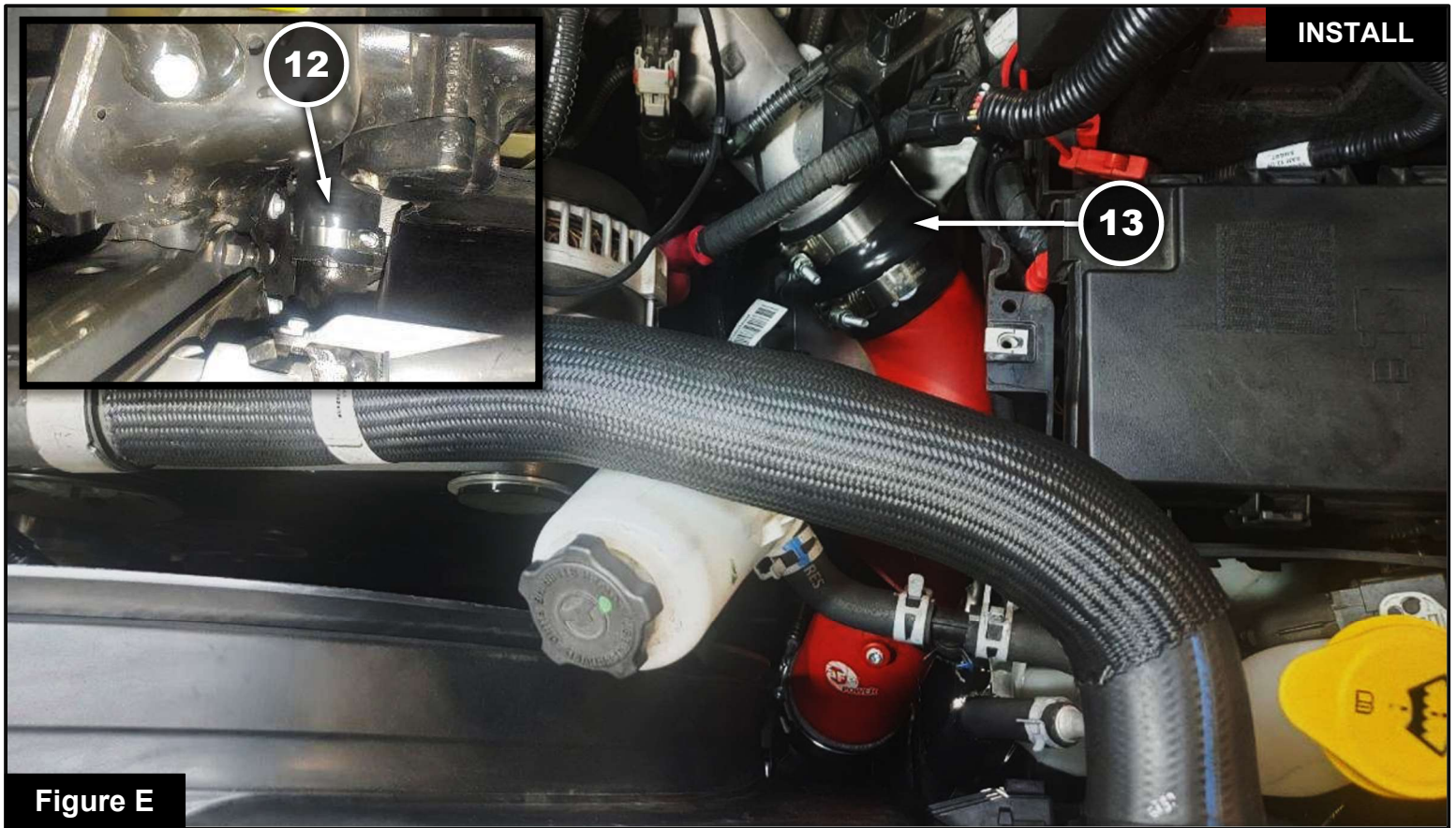

Refer to Figure E for Steps 19-25

Step 19: Install the aFe POWER cold side charge pipe into the vehicle from the top.

Step 20: Install one (1) 3.25"–3.5" spring-loaded T-bolt clamp onto the intercooler outlet; leave the clamp loose.

Step 21: Connect the elbow coupling to the intercooler outlet; leave the clamp loose. ⑫

Step 22: Install the remaining 3.25"–3.5" spring-loaded T-bolt clamp over the reducer coupling.

Step 23: Connect the aFe POWER coupling to the engine inlet; leave the clamp loose. ⑬

Step 24: Adjust all couplings to ensure they are fully seated, properly aligned, and do not interfere with any surrounding components before tightening clamps.

Step 25: Torque all spring-loaded T-bolt clamps on both charge pipes to 10 ft-lbs (120 in-lbs) or until the spring is fully compressed. Do not over-tighten.

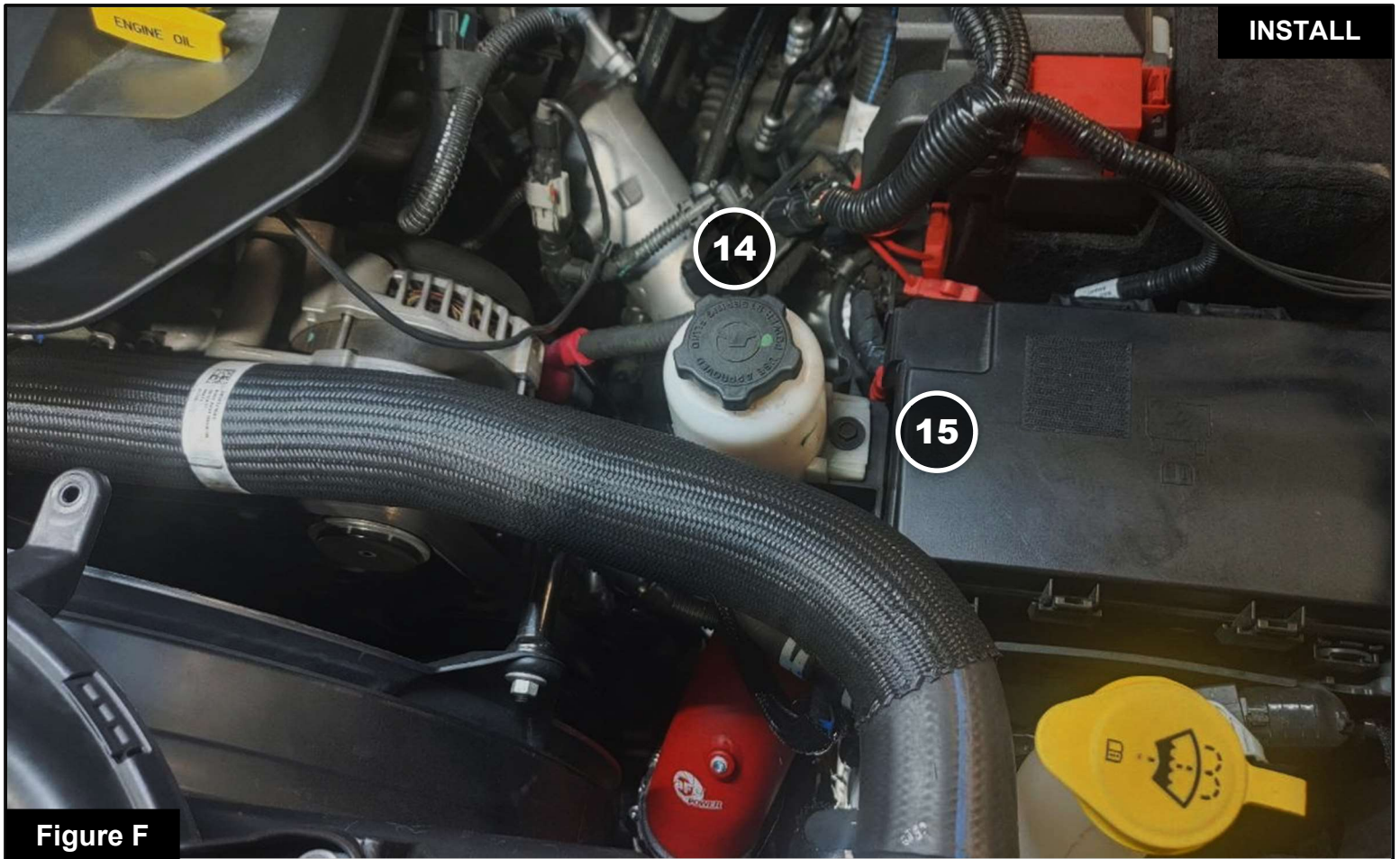

Refer to Figure F for Steps 26-28

Step 26: Reconnect the engine harness link in the reverse order of removal. ⑭

Step 27: Reconnect all routing clips for the engine harness and hoses in the reverse order of removal.

Step 28: Reinstall the power steering pump reservoir in the reverse order of removal. ⑮

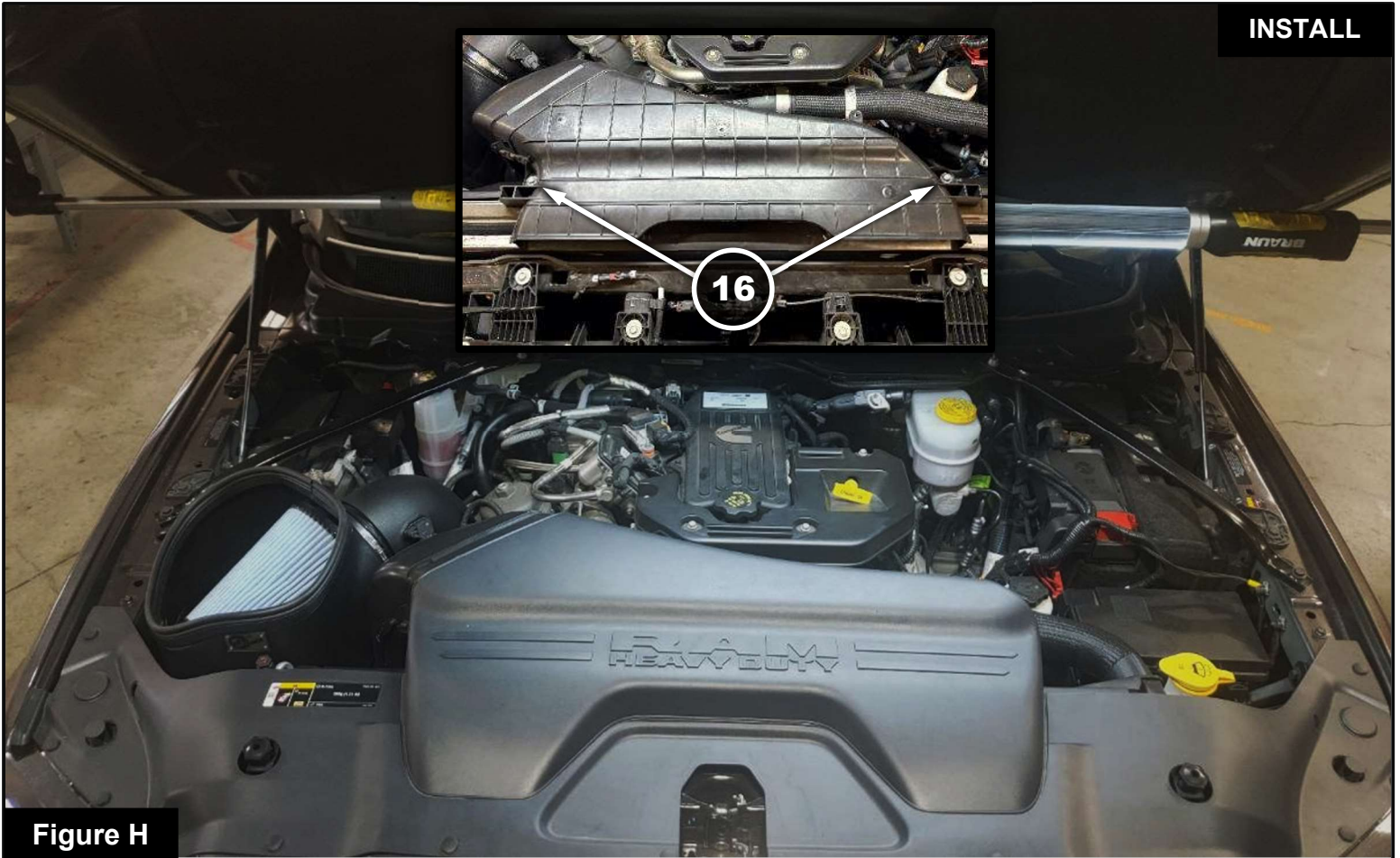
**Figure H****Refer to Figure H for Steps 29-33**

Step 29: Reinstall the air intake scoop in the reverse order of removal and torque screws to factory specifications. (16)

Step 30: Reinstall the radiator cover in the reverse order of removal.

Step 31: Reconnect both negative battery cables.

Step 32: Start the vehicle and check for any air leaks, abnormal noises, or loose components.

Step 33: Installation is now complete.

NOTE: Check that all clamps and connectors are secure after 100–200 miles.



This Page Was Left Intentionally Blank



advanced FLOW engineering, inc.

Corona, CA 92879

<https://afepower.com/contact>