

TAURUS PLATFORM FRONT CAMBER KIT

This part should only be installed by personnel who have the necessary skill, training and tools to do the job correctly and safely. Incorrect installation can result in personal injury, vehicle damage and / or loss of vehicle control.

Plan Ahead - Read All Instructions BEFORE installing part.

Check for loose or worn parts, proper tire pressure, and odd tire wear patterns before beginning alignment.

1. Take alignment readings and determine amount of camber change needed.
2. Raise vehicle by frame so suspension hangs free. Remove tire and wheel assembly.
3. Mount SPC 81139 magnetic camber gauge (or similar) to measure camber change.
4. Remove the upper strut-spindle bolt.
5. Line up formed upset on washer with cam on bolt. **Install bolt & washer into upper strut mounting hold with large tab out (toward wheel) for positive camber or in (away from wheel) for negative camber (See Figures 1 and 2).** Install EZ Cam XR bolt into strut hole making sure formed upset on washer is in hole and washer is flush on strut. Add lock nut and snug, but do not tighten.
6. Loosen the lower strut bolt and partially remove until splines on OE bolt are no longer engaged.
NOTE: OE Splined lower bolt will prevent adjustment until it is partially removed.
7. While using magnetic camber gauge, rotate EZ Cam XR bolt to obtain desired camber change. Ensure large tab on washer does not rotate.
8. Re-install OE Lower strut bolt loosely, reinstall tire and wheel assembly and recompensate alignment equipment. Confirm camber change. If needed, repeat steps 6-7.
9. Torque lower bolt to manufacturer's specification.
10. While holding bolt steady, torque 84135 EZ Cam XR nut to 145 lb-ft (197 N-m). Do not apply anti-seize or other friction modifiers to threads.
11. Complete alignment and road test vehicle.

Always check for proper clearance between suspension components and other components of the vehicle.

US Patent Nos. 8,544,861 B2 • 8,469,375 B2 • 10,450,005 • D783,393

China Patent No. ZL 201630012294.X

Figure 1

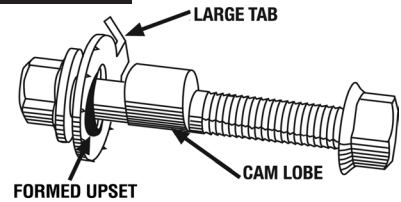
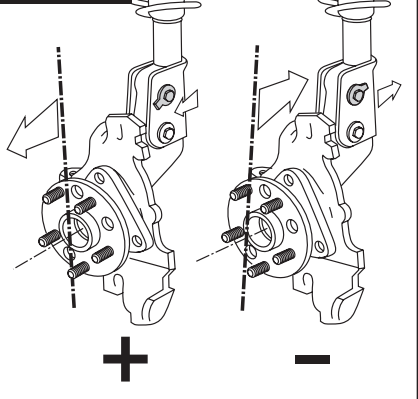

Figure 2



Specialty Products Company®

4045 Specialty PI • Longmont, CO 80504 • (303) 772-2103 • www.specprod.com

For warranty information go to: www.specprod.com/warranties

Printed in U.S.A.

Toll Free Technical Hot Line: 1-800-525-6505 • Email: info@specprod.com