



Installation Instructions

D760-0058: COLD AIR INTAKE SYSTEM

Document Revision: C
Release Date: February 3, 2026

Vehicle List:
G22/G23 M440i (2021-2026)
G26 M440i (2022-2026)
G20 M340i (2020-2026)

Thank you for being selective enough to choose a Dinan Performance Cold Air Intake System. The Dinan Team has spent many hours developing this product to assure that you will receive increased performance, durability and an aesthetic design that you as a customer will be able to enjoy for many years. Ease of installation and maintenance is important to us and has been highly considered throughout the design process.

Prior to performing the installation, familiarize yourself with these instructions, as it should help you with the process. If you feel that you do not have the required skills or tools, please arrange for a qualified repair facility to perform the installation.

If you have any difficulties during the installation, or if these instructions are not clear to you, please call Dinan's Technical Support Staff at (800) 341-5480.

Refer to BMW factory recommended procedure for further details

Again, thank you for choosing Dinan. Enjoy.

Table of Contents:

Parts List:	2
Tools Required:.....	2
Removing the Stock Intake System:	3
Assembling the Dinan Intake System:.....	5
Installing the Dinan Intake System:.....	8
Enjoy	10

Parts List:

Quantity	Part #	Description
1	D763-0163	Assembly, Lower Box
1	D401-0027	Air Filter
1	D762-0270	Airbox Lid
1	D762-0237	Turbo Inlet Hose
1	D762-0332	Turbo Inlet Hose, G20 LCI2
1	D763-0243	Inlet Tube
1	D763-0186	Brace Spacer Kit
1	D763-0164	Hardware Kit
	Contains:	
	10	D671-0236 Rivet, Push-In
	6	M4x12 FENDER M4 Washer
	3	M4 NYLOK M4 Nylok Nut
	3	D671-0143 M4x16 Button Head Screw
	2	D671-0147 M4x10 Button Head Screw
	2	#64Z Clamp 9mm 90-110
	1	#48Z Clamp 9mm 80-100

Tools Required:

- 6mm Socket
- 7mm Socket
- 8mm Socket
- Long extension for sockets
- 2.5mm Hex Key
- 3mm Hex Key
- T20 Torx Bit

Removing the Stock Intake System:

- 1) If equipped, remove the brace to access the stock intake system. Hardware will be re-used.
- 2) Remove the stock intake system from the car.
 - Unplug the Air Temperature Sensor.
 - Loosen the hose clamp attached to the inlet tube.
 - Pull straight up to remove the intake from the car.

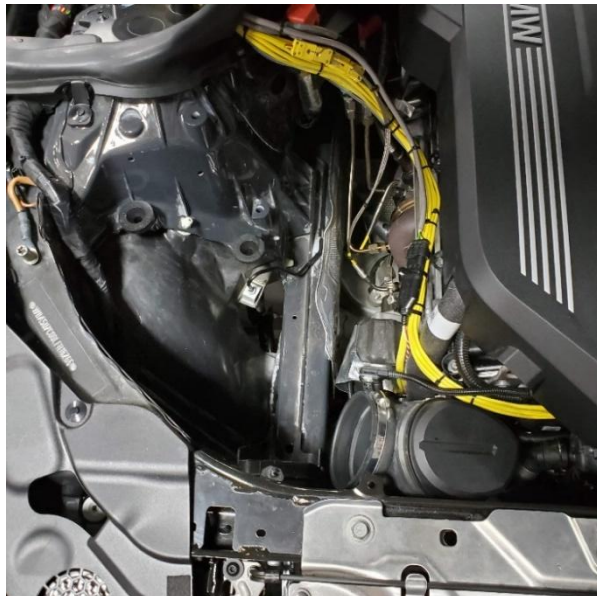
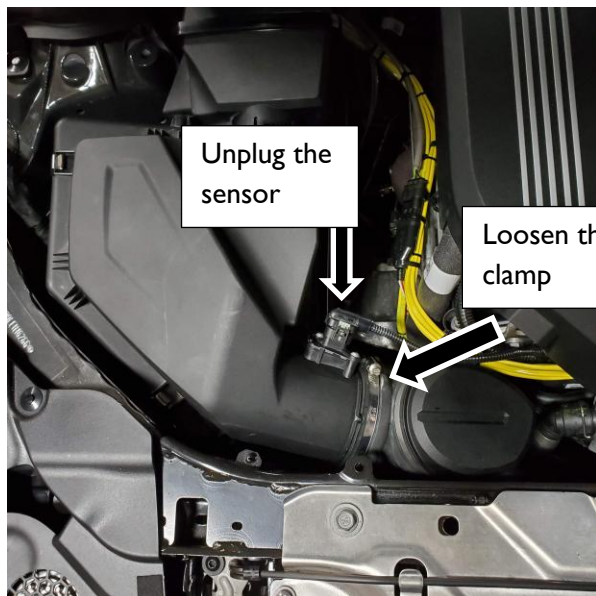

- 3) Remove the air temperature sensor from the stock intake and carefully place it to the side.

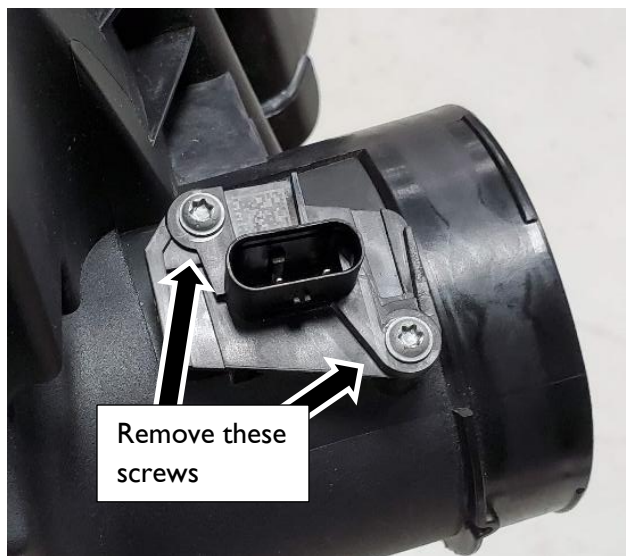

- 4) Remove the stock inlet tube.
 - Cut the lower crimp clamp on the inlet tube.
 - Remove the inlet tube.
 - **WARNING** – The turbocharger inlet is now exposed. Items that fall inside can cause severe damage to the turbo! Be sure to place a rag or towel in the inlet to protect the turbo.

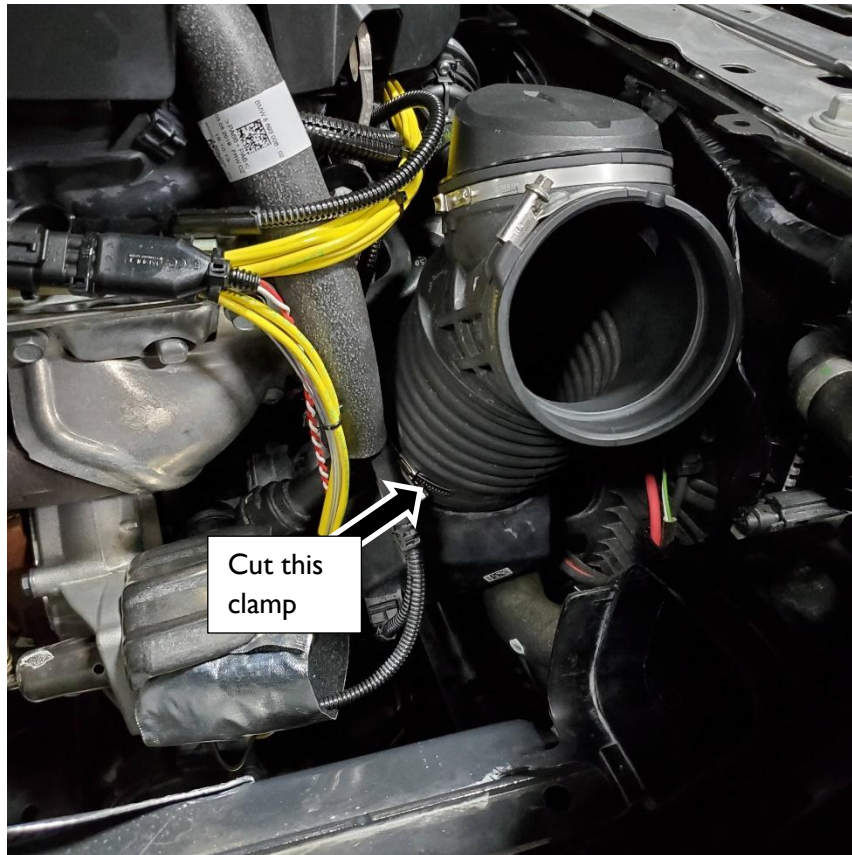

Assembling the Dinan Intake System:

1) Gather the components pictured below and attach the inlet tube to the airbox.

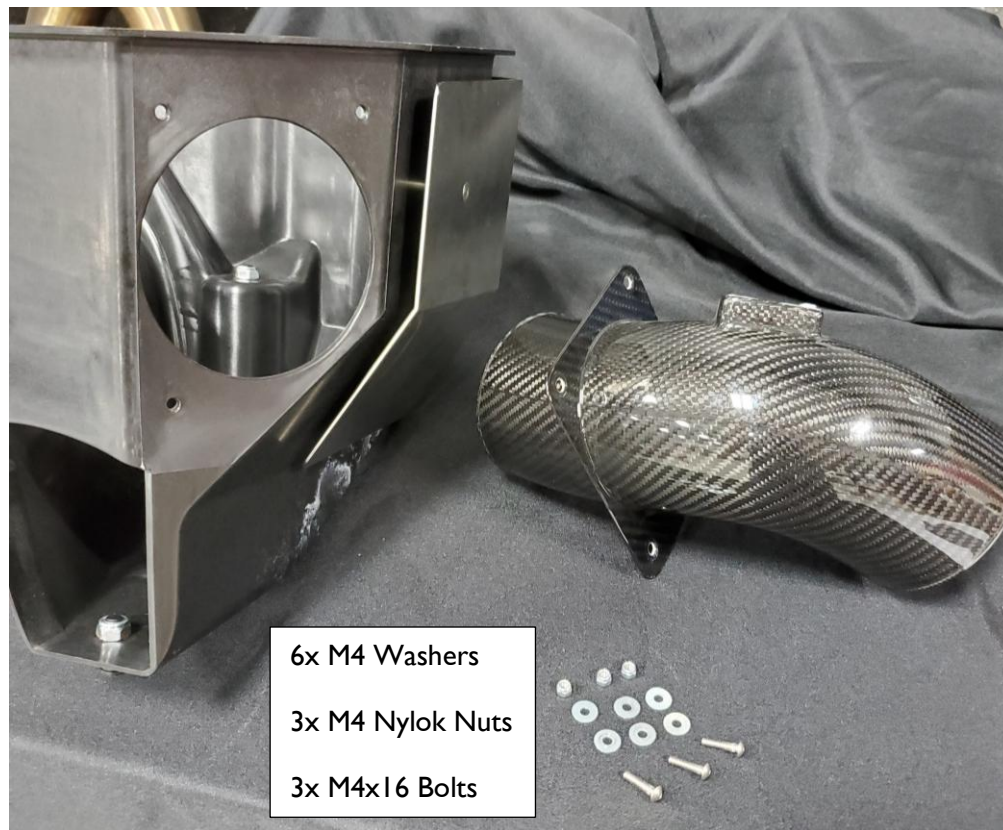

- 2) Secure the Air Filter into the Airbox with the provided clamp.
 - The filter can only be installed one way as shown below.
 - Once the filter is properly seated on the intake tube, tighten the clamp.



- 3) Insert the Air Temperature Sensor into the Dinan Inlet Tube.
- The sensor will only fit one way.
 - Secure the sensor with the 2 provided M4x10 screws.



Installing the Dinan Intake System:

- 1) Attach the Dinan Turbo Inlet Hose to the turbocharger inlet in the car.
 - Be sure the inlet hose fully seats onto the turbocharger inlet.
 - Secure the bottom clamp.
 - Note – 2025 and newer M340i/M440i will use the D762-0332 hose and #48Z clamp; all other vehicles will use the D762-0237 hose and #64Z clamp.

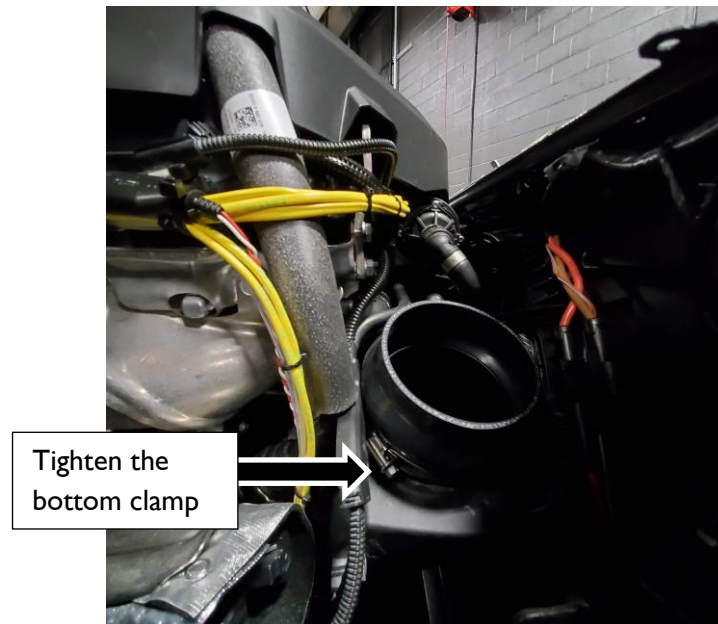

- 2) Slide the other clamp onto the top of the Turbo Inlet Hose.
 - You will need an extension to tighten the top clamp as pictured below.

This photo is for demonstration purposes only. The intake must be installed in the car before tightening the top clamp.



- 3) Install the Dinan Intake Assembly.
- The assembly will snap into the 3 rubber grommets on the vehicle.
 - Tighten the top hose clamp as shown in Step 2.
 - Reconnect the Air Temperature Sensor.



- 4) Attach the Intake Lid to the Airbox.
- Align the holes and attach the airbox lid using the push rivets.
 - Spare rivets are included for your convenience.

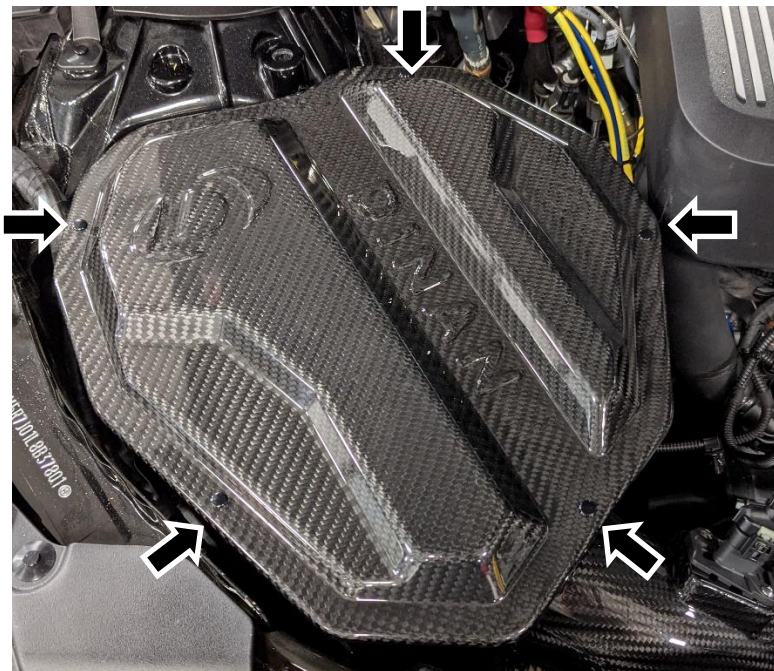

5) Re-install the brace.

- For a proper lid spacing, install the supplied spacer under the front mounting hole prior to tightening.
- Torque to 56 Nm.
- Repeat this operation on the other side for symmetry.



Enjoy

Installation is now complete. Clean the carbon fiber with a microfiber cloth and ensure all tools are removed from engine compartment prior to closing the hood.