

# INSTALLATION INSTRUCTIONS

# **EGR *ROLLTRAC***

## ELECTRIC

Vehicle Model: **Toyota Tacoma 5Ft Bed LHD**  
Year of manufacture: **2022**  
Part Number: **RT040481E**

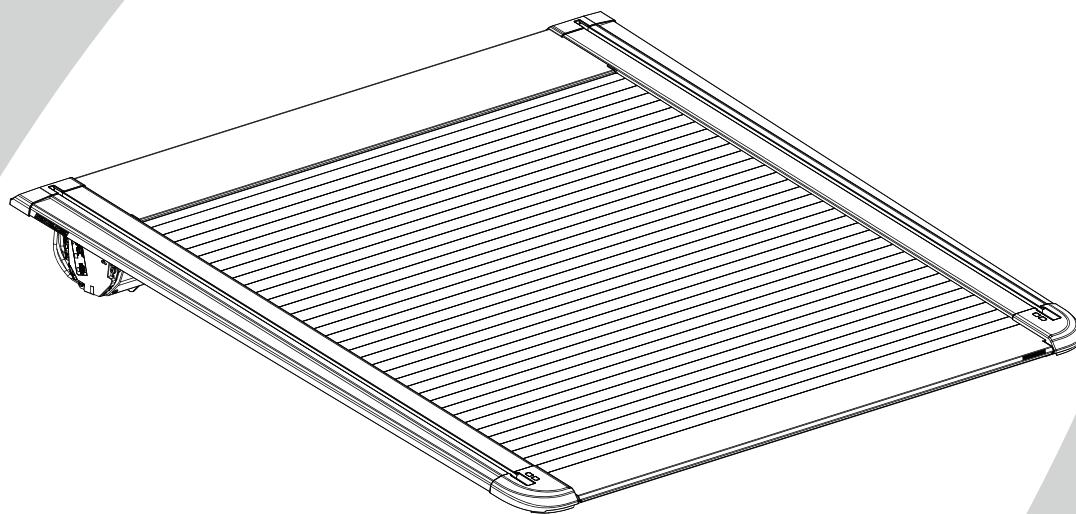

Installation time: 180 minutes

### Caution

- Do not attach EGR RollTrac in a location or by a method not specified.
- Do not use this product for any vehicle make or model, other than those specified in this document.
- Do not remove the plaque or label from this product.
- Do not modify the structure of the EGR RollTrac in any way.

### General Notes

- Read through the fitting instructions before installation of EGR RollTrac.
- Always install the accessory following the fitting instructions. Failure to do so may cause damage to the vehicle or the accessory.
- Ensure all recyclable discarded vehicle accessory components and packaging are recycled following local recycling regulations.
- It is always recommended that this accessory is fitted by a qualified Technician.
- Safely store and protect any removed vehicle components.
- Ensure all bare metal surfaces are protected using Automotive Bare Metal Primer and touch-up paint.
- Remove all metal swarf and dust from all vehicle surfaces if surface is used for accessory installation.

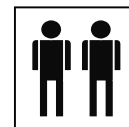

### Safety Notes

- Check that all work practices comply with safety standards.
- Please wear appropriate clothing and use safety equipment.



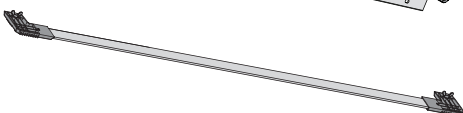
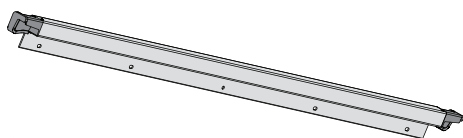
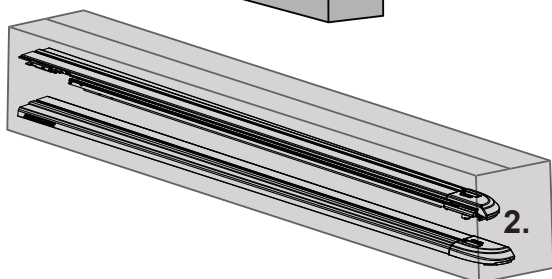
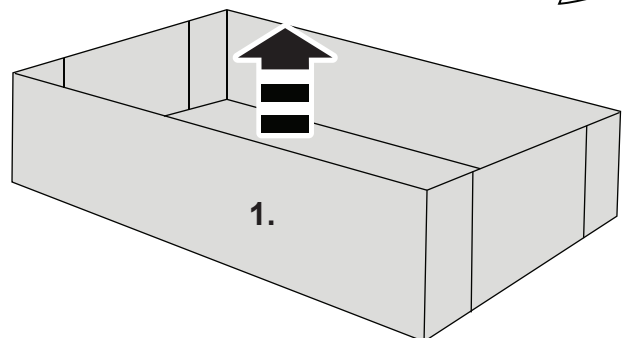
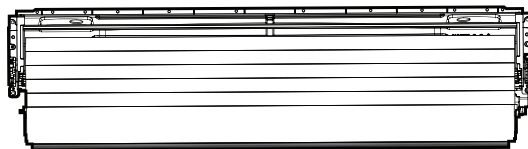
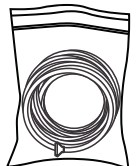
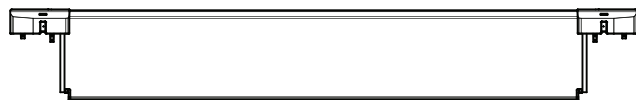
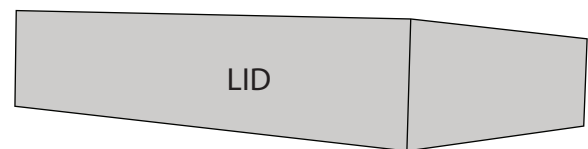
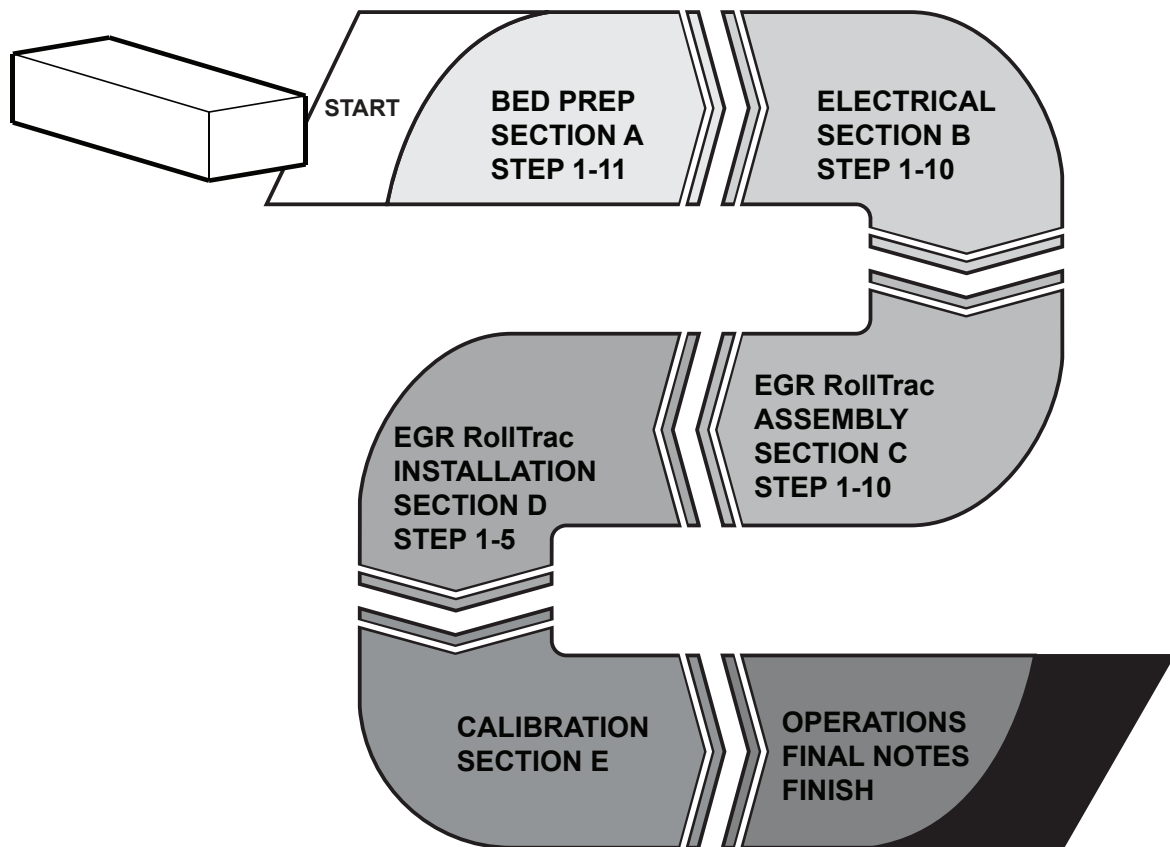



## KIT CONTENTS - COMPONENT NUMBER AND QUANTITY

1

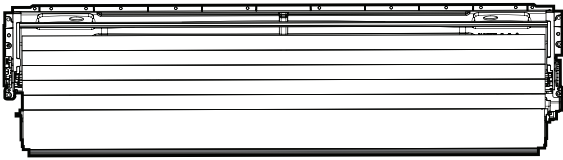

CANISTER ASM. QTY: 1

2



FRONT COVER QTY: 1

3



LHS RAIL QTY: 1

4

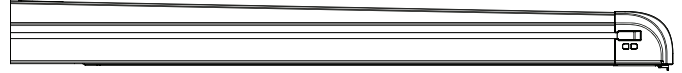

RHS RAIL QTY: 1

5

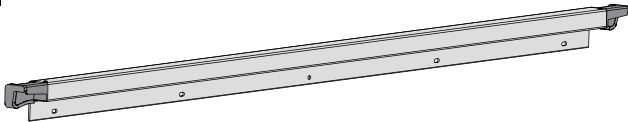

HEADERBAR QTY: 1

## EGR RollTrac FITTING KIT IN BOX

6



SCRW0973  
SCREW M6x15  
QTY: 9

7



MISC4233PC-RH  
CORNER BRACKET  
QTY: 1

8

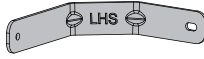

MISC4233PC-LH  
CORNER BRACKET  
QTY: 1

9

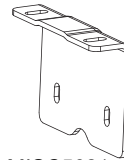

MISC5621  
SIDE RAIL BRACKET  
QTY: 6

10

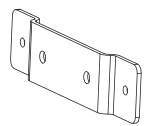

MISC5421  
MOUNTING BRACKET  
QTY: 6

11



NUTS0311  
T-NUT  
QTY: 14

12



M6x20 HEX HEAD  
SCRW0997  
QTY: 43

13



KIT040298  
REAR DRAINAGE TUBE  
QTY: 2

14

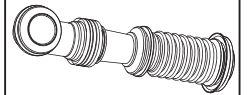

FRONT DRAINAGE TUBE  
QTY: 2

15

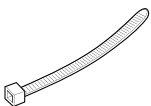

CONS70097  
CABLE TIE  
QTY: 10

## EGR RollTrac FITTING KIT COMPONENTS IN BAGS

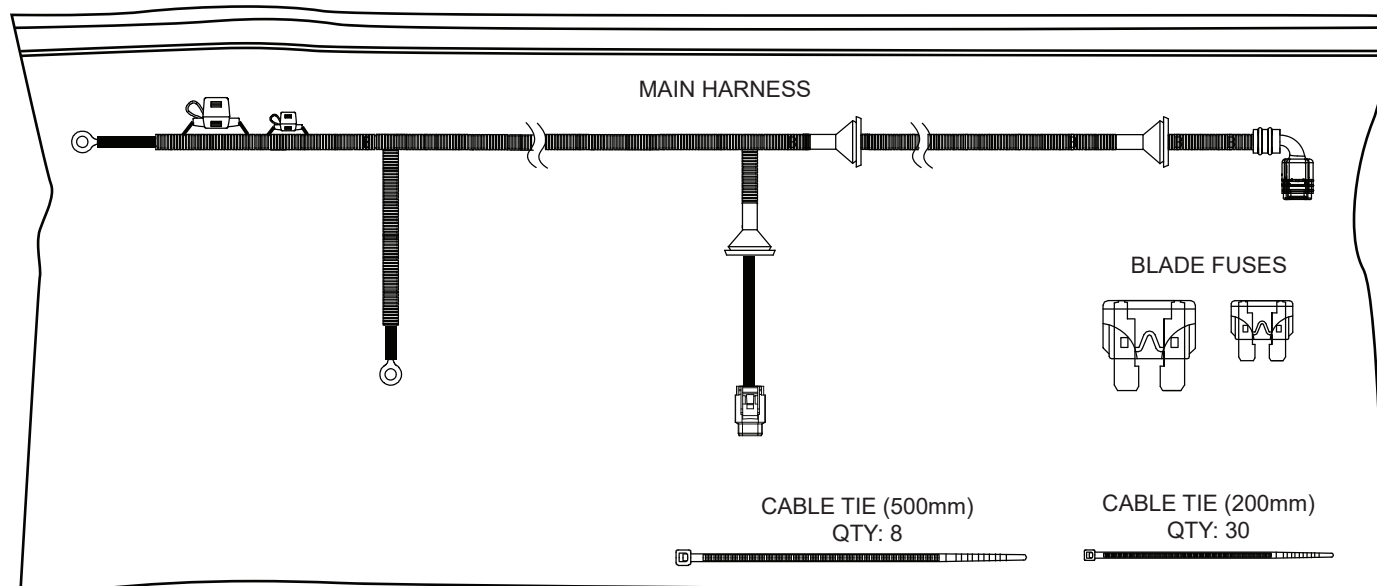

## EGR RollTrac FITTING KIT ADDITIONAL ITEMS

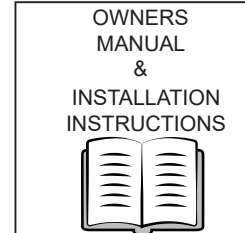
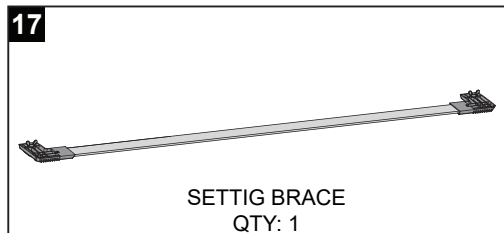
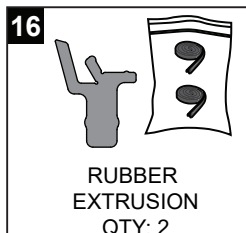

## TOOLS REQUIRED - NOT SUPPLIED IN KIT

<p>Drill</p>	<p>Holesaw Ø29mm (1 1/8") Ø38mm (1 1/2")</p>	<p>Centre Punch &amp; Hammer</p>	<p>METRIC Tape Measure</p>	<p>Scissors</p>	<p>Masking Tape Fiberglass Tape Black Cloth Tape</p>
<p>Ratchet &amp; Sockets 7mm (9/32") 10mm (25/64") 13mm (33/64")</p>	<p>Allen Key 4mm (5/32")</p>	<p>Allen Key 4mm (5/32")</p>	<p>Torque Wrench</p>	<p>Side Cutters</p>	<p>3M Primer 94 (preferred) or equivalent</p>
<p>50/50 Isopropyl Alcohol/Water</p>	<p>Ruler x2</p>	<p>Silicone</p>	<p>Silicone Spray</p>	<p>T40 Torx Key</p>	

### GLOSSARY:

- 1** Number inside a square indicate part number
- 1** Number inside circle indicate the sequence within a step
- 1** Number inside the hexagon indicate torque instruction

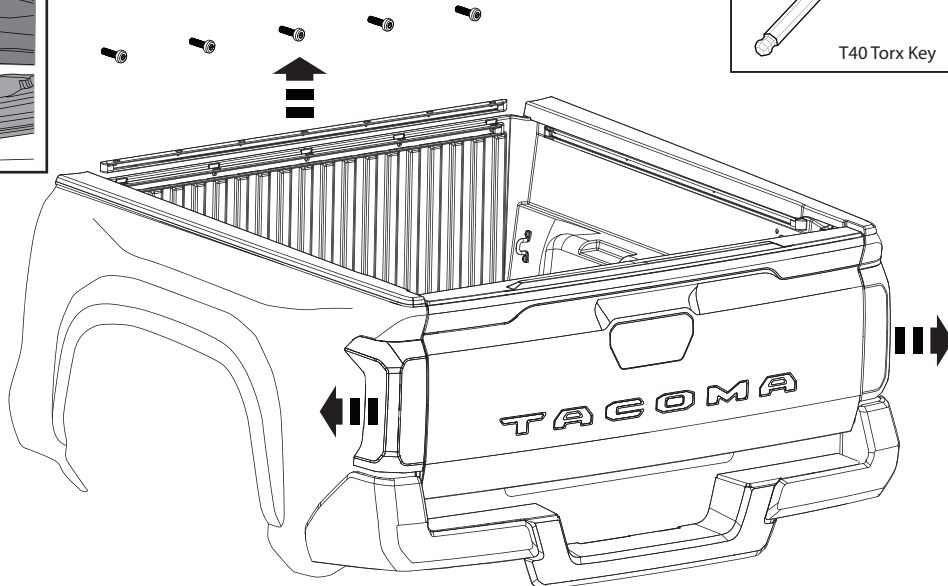
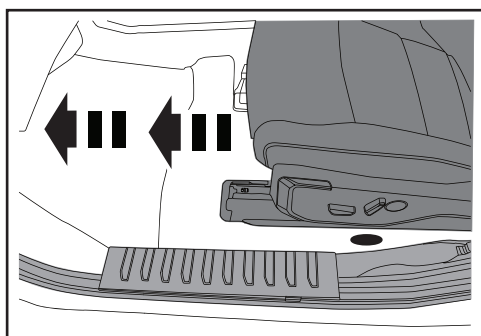

- 1** Thoroughly wash the vehicle and bed and ensure that all dirt and grease is removed. Allow to dry. Clean the top surfaces of the bed and tailgate and allow to dry. Carefully remove both Rear Tail Lamps with the appropriate tools and store in safe place. Retain all hardware for re-installation.

Remove and discard the front utility rail. Retain the 5 Torx screws.

**IMPORTANT:** Move the driver seat all the way forward, before disconnecting battery negative terminal.

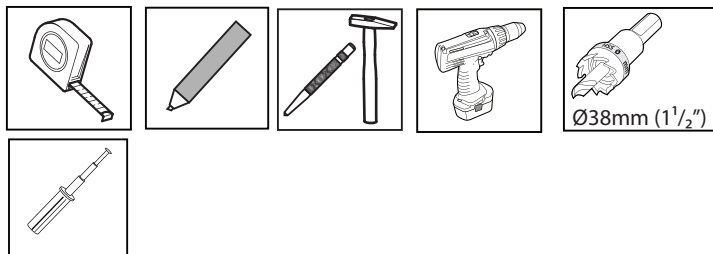

### HOLES FOR FRONT DRAIN TUBES RHS & LHS

#### ATTENTION



Ensure that the diameter of the hole does not exceed  $\varnothing 38\text{mm}$  ( $1\frac{1}{2}''$ ). Larger hole size will lead to water ingress into the bed

### INSTALL FRONT DRAIN TUBES TO BED

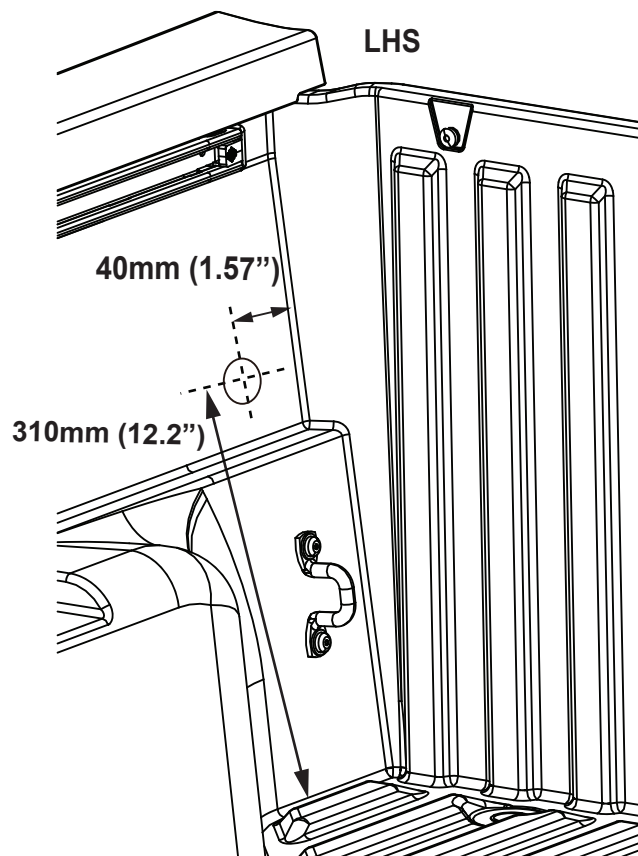
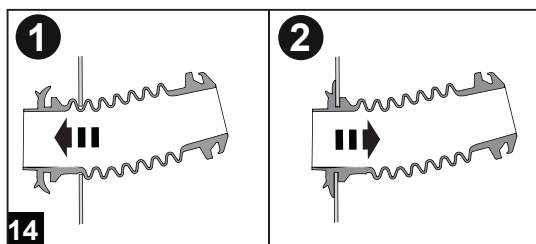

- 2** Mark the position of the front drain tubes holes in the bed front panel and drill with  $\varnothing 38\text{mm}$  ( $1\frac{1}{2}''$ ) holesaw. LHS shown, repeat on the RHS. Clean all burrs and coat the exposed metal with a suitable rust preventative (not supplied). Fit front drain tubes (14).

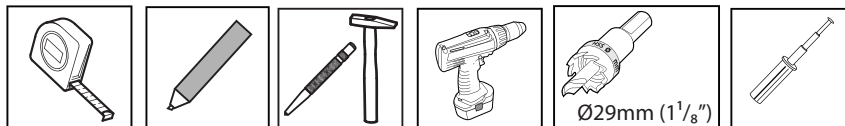

## HOLE FOR VEHICLE HARNESS LHS ONLY

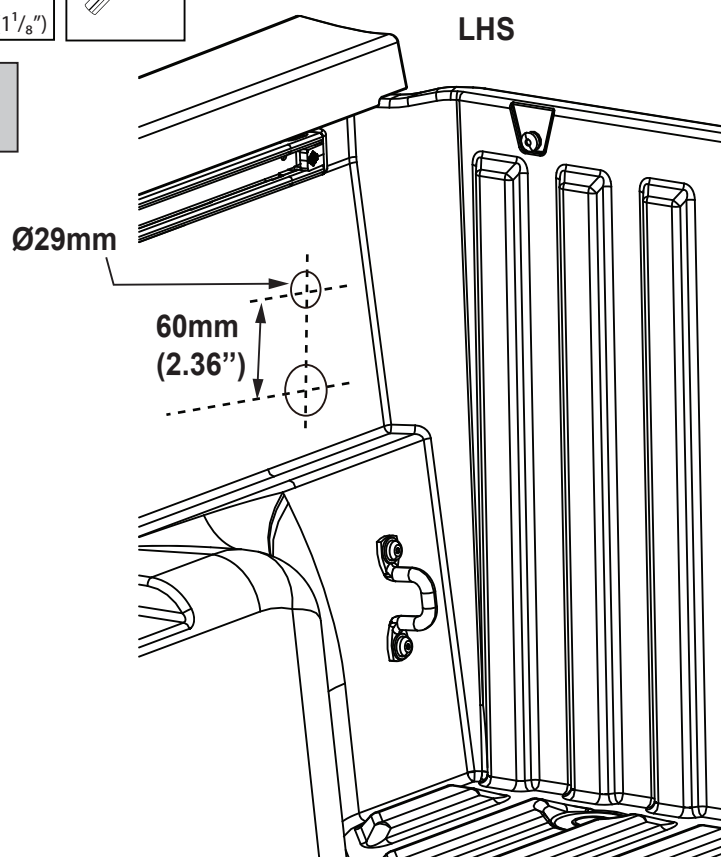

- 3** Mark the position for the Vehicle Harness on the LHS of the tub. The distance is 60mm PCD from the drain tube hole.

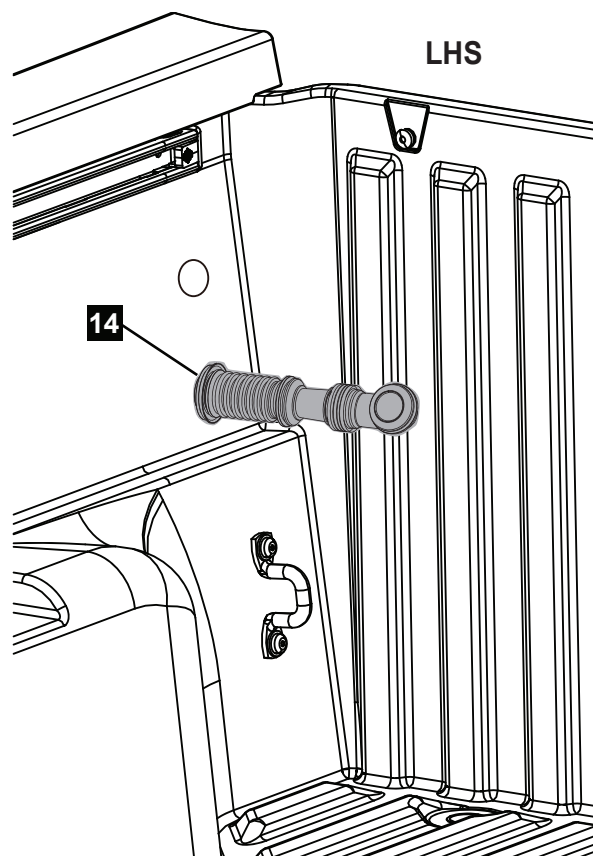

- 4** Fit the front drain tubes to the tub.

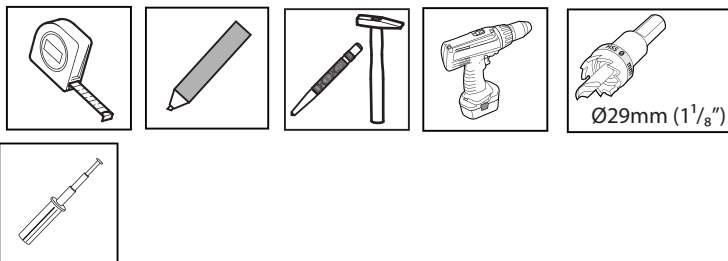

## HOLES FOR REAR DRAIN TUBES RHS & LHS

### ATTENTION



Ensure that the diameter of the hole does not exceed  $\text{Ø}29\text{mm}$  ( $1\frac{1}{8}\text{''}$ ). Larger hole size will lead to water ingress into the bed

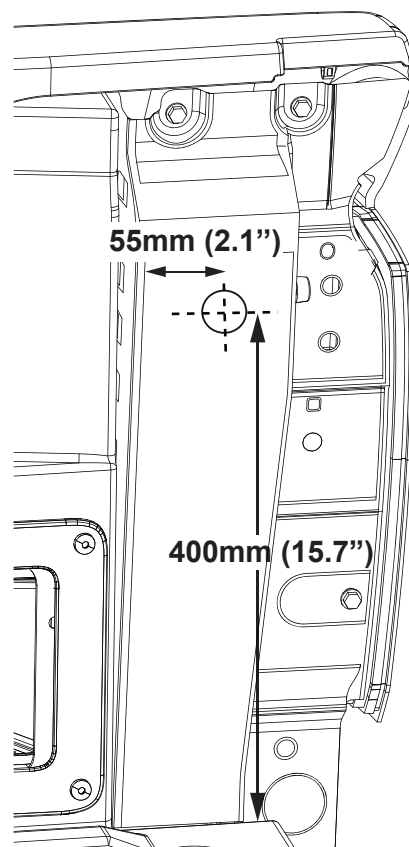

- 5** Mark the position of the rear drain tubes holes in the bed rear panel and drill with  $\text{Ø}29\text{mm}$  ( $1\frac{1}{8}\text{''}$ ) holesaw. RHS shown. Repeat on the LHS. Clean all burrs.

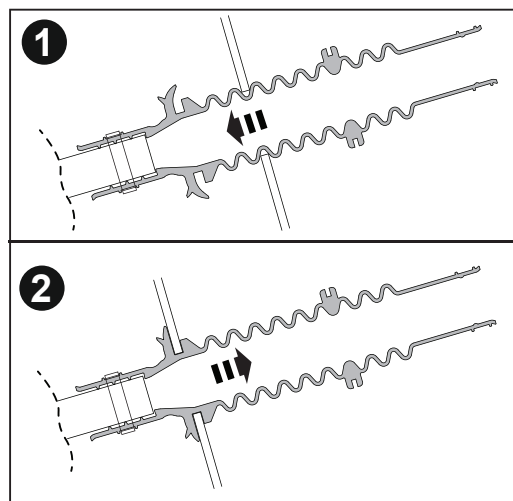
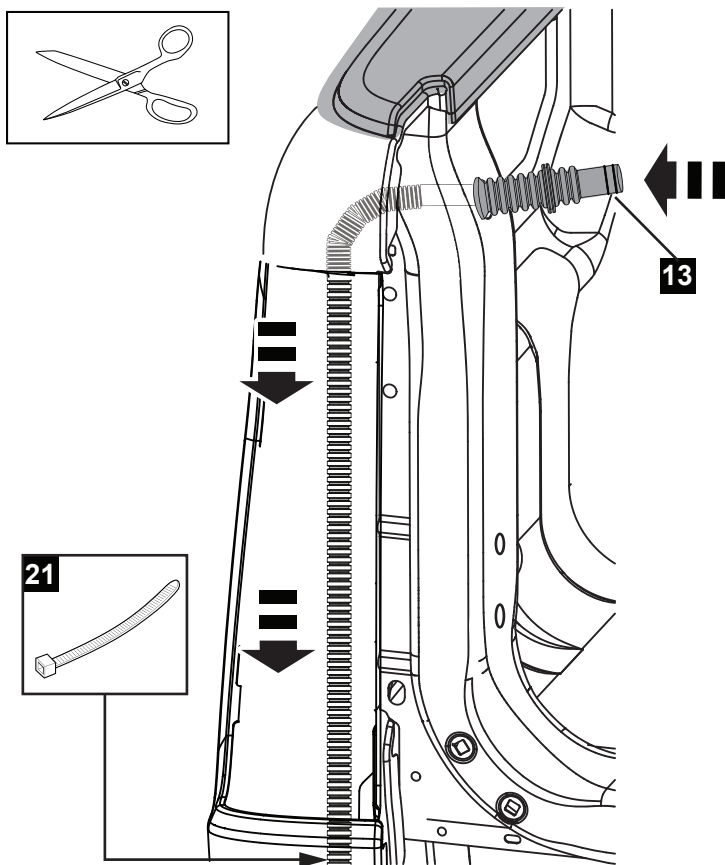

- 6** Feed the rear drain tube into the drilled hole. Guide the plastic tube inside the tail light cavity towards the ground. Push the rubber tube in until it sits firmly in the hole as shown. Secure the drain tube to the existing harness inside the tail light cavity using 1 cable tie. Trim 200mm from the bottom of the drain tube. Refit Rear Tail Lamps.

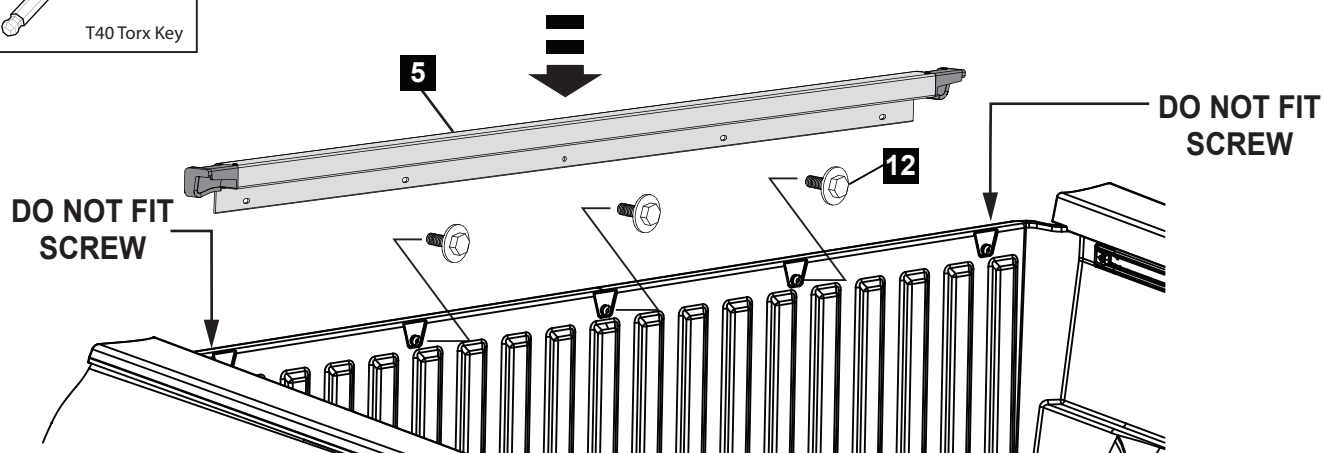
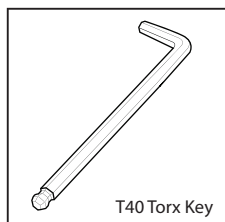

- 7** Place the header bar (5) on top of the tub front panel, press down and secure with 3 screws (12). Torque to 5.5Nm.

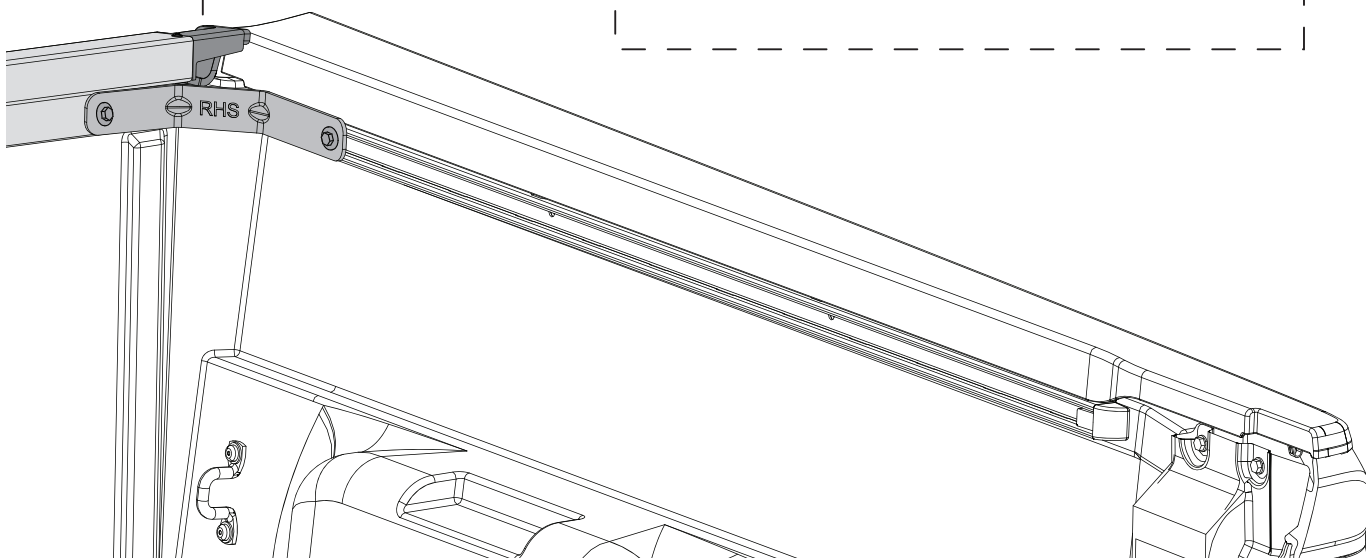
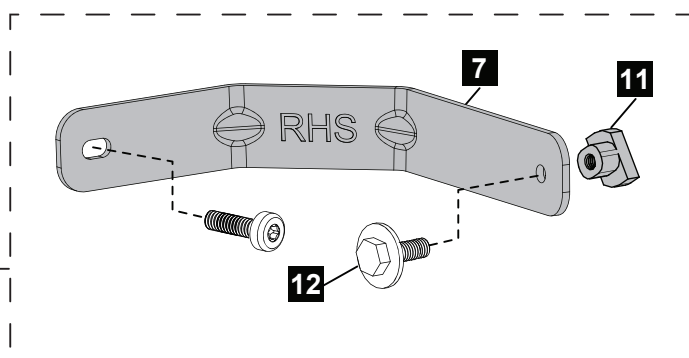
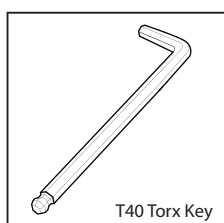
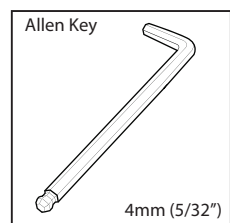

- 8** Assemble the corner bracket to the rail using T-Nut (11), screw (12) and one Torx screw (removed in step 1) as shown on the RHS.



**IMPORTANT:** DISCONNECT CAR BATTERY NEGATIVE TERMINAL.  
FIT THE FUSE AT THE END OF INSTALLATION.  
WHILE ROUTING THE VEHICLE HARNESS AVOID ANY VEHICLE COMPONENTS  
THAT HEAT UP, SUCH AS EXHAUST AND ENGINE COMPONENTS.  
DO NOT ATTACH HARNESS TO MOVING PARTS, FUEL LINES, BRAKE LINES,  
MOVING PARTS AND AVOID PINCH POINTS.



## HARNESS ROUTING OVERVIEW FOR PETROL VEHICLE

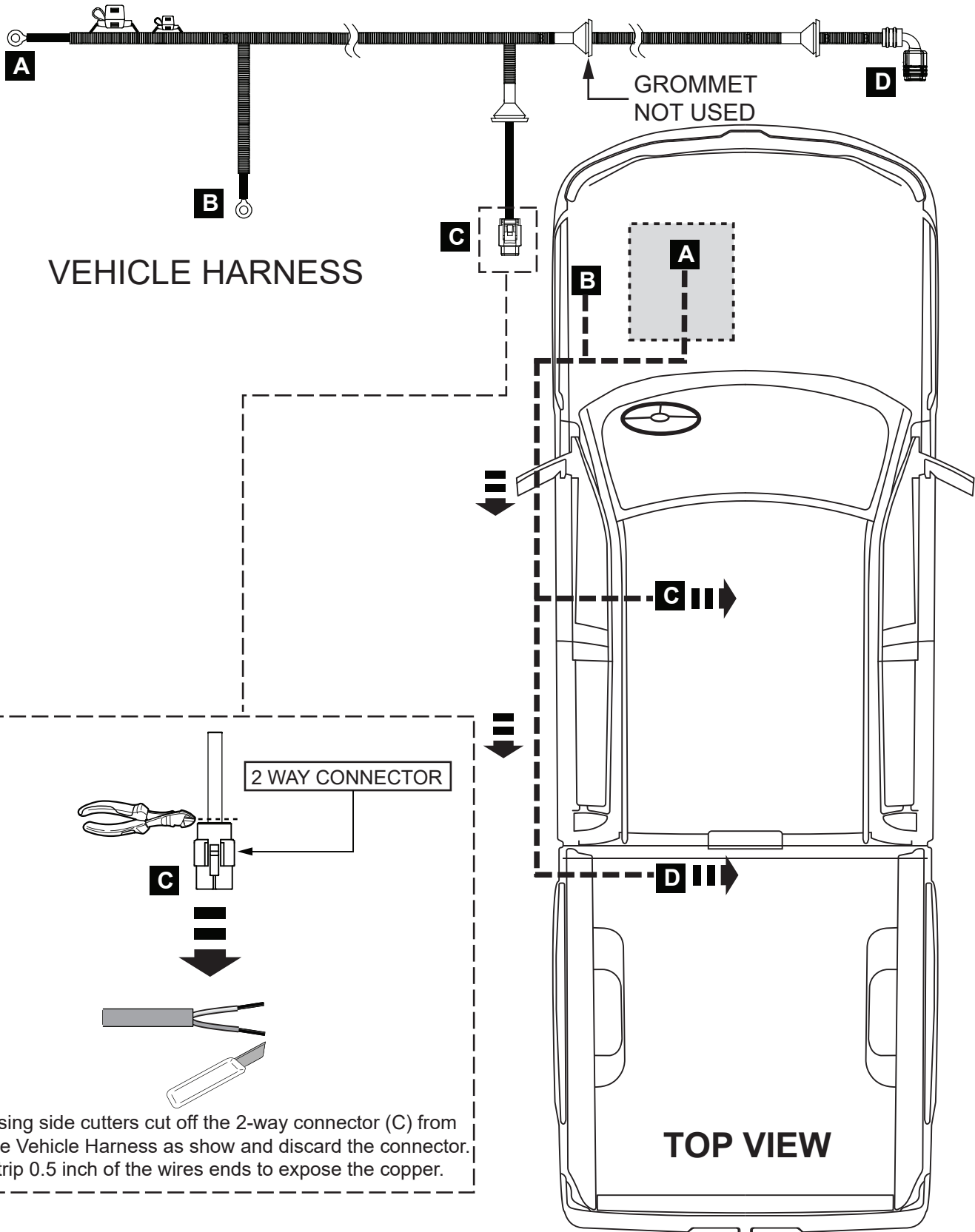



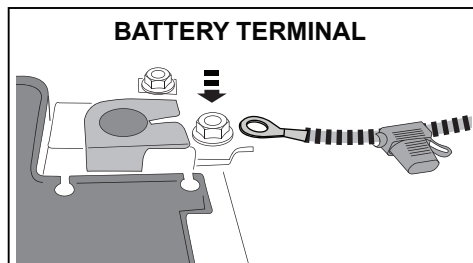

USE DRAW WIRE TO  
PULL VEHICLE HARNESS  
INTO THE ENGINE BAY

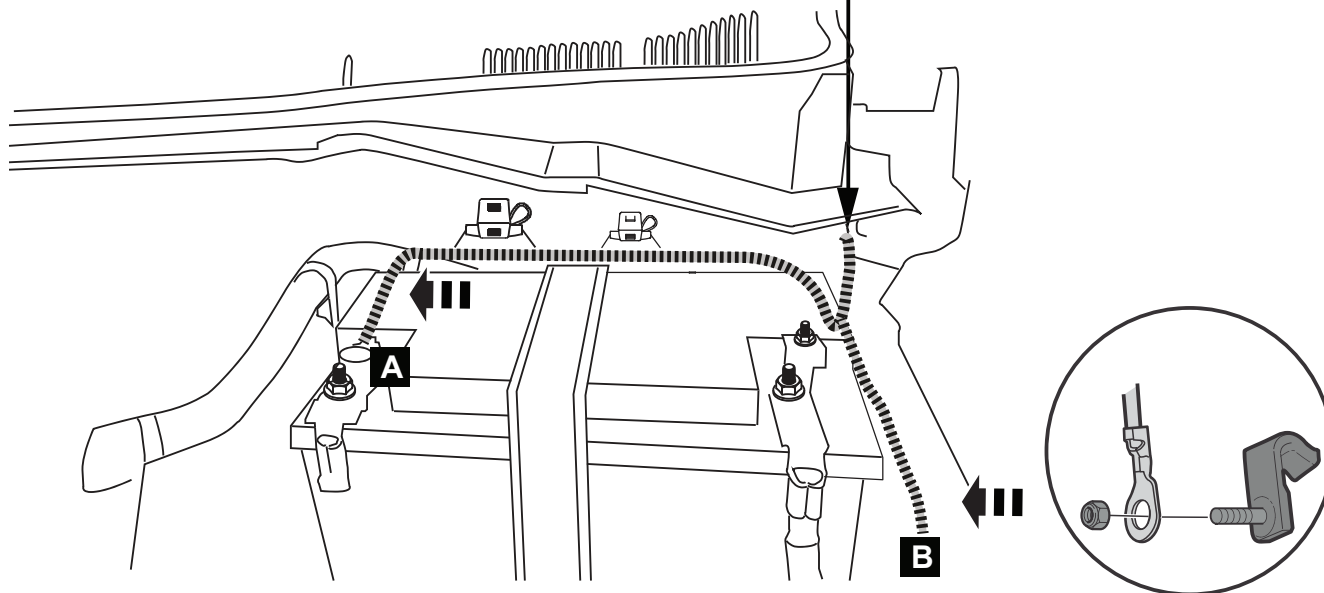

- 1 IMPORTANT:** Make sure fuses are not fitted before making connection.  
Feed the harness into the engine bay on the LHS along the fire wall from underneath the vehicle. Use draw wire first by pushing it down from the engine bay. Attach the two main harness terminals (A&B) using tape and pull gently into the engine bay. Connect the vehicle harness branch (A) to the battery positive terminal. Connect the vehicle harness negative branch (B) to the stud on chassis as shown next to the battery.

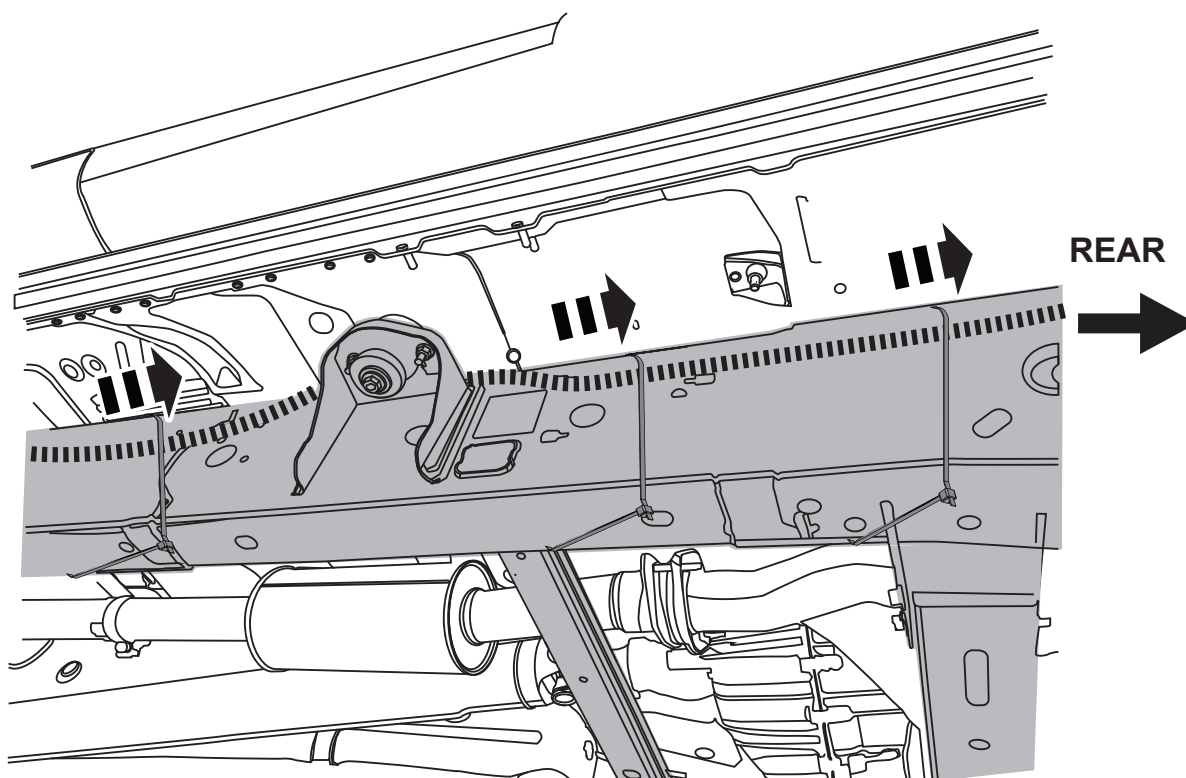
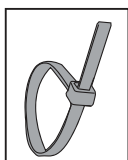

- 2** From underneath the vehicle, route the Vehicle Harness connector C&D towards the rear of the vehicle, following outside the chassis rail. Use the supplied cable ties and retain the harness every 200mm (8") to the chassis rail.

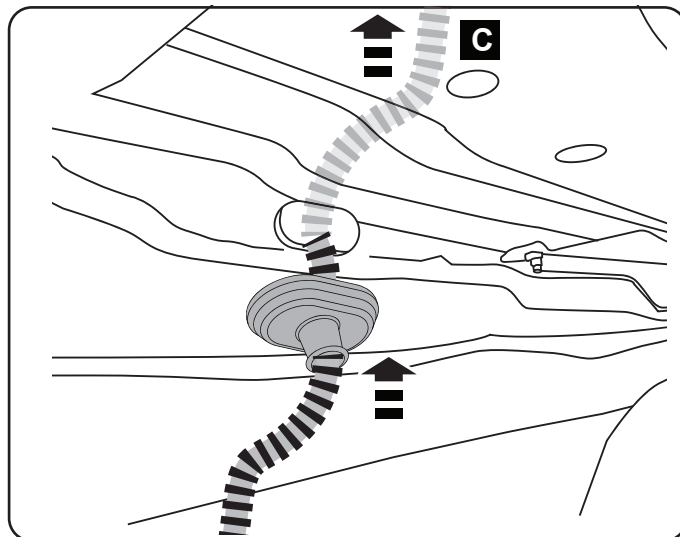
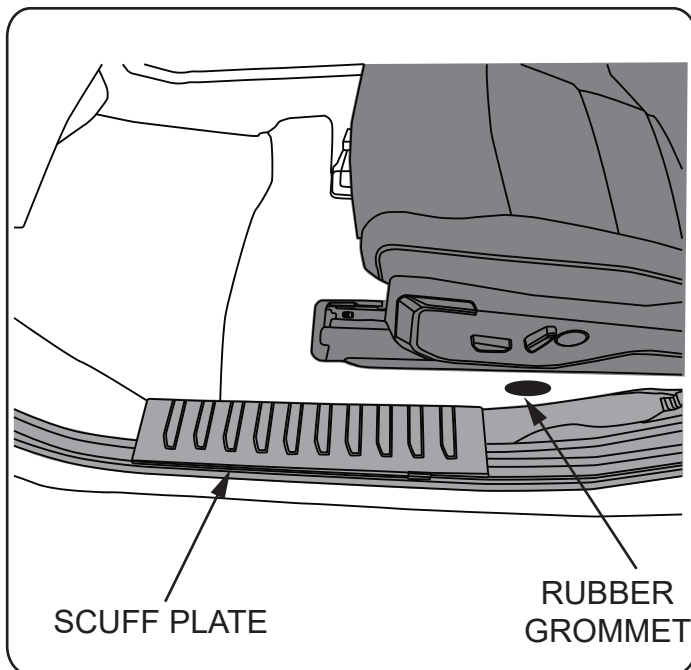

- 3** Inside the vehicle (LH) side, lift the scuff plate to allow lifting the carpet under the seat in order to expose the rubber grommet in the floor. Remove and discard the grommet. Feed the vehicle harness branch (C) into the cabin. Pull the harness until the grommet on the harness is sited securely in the floor hole.

## LHS

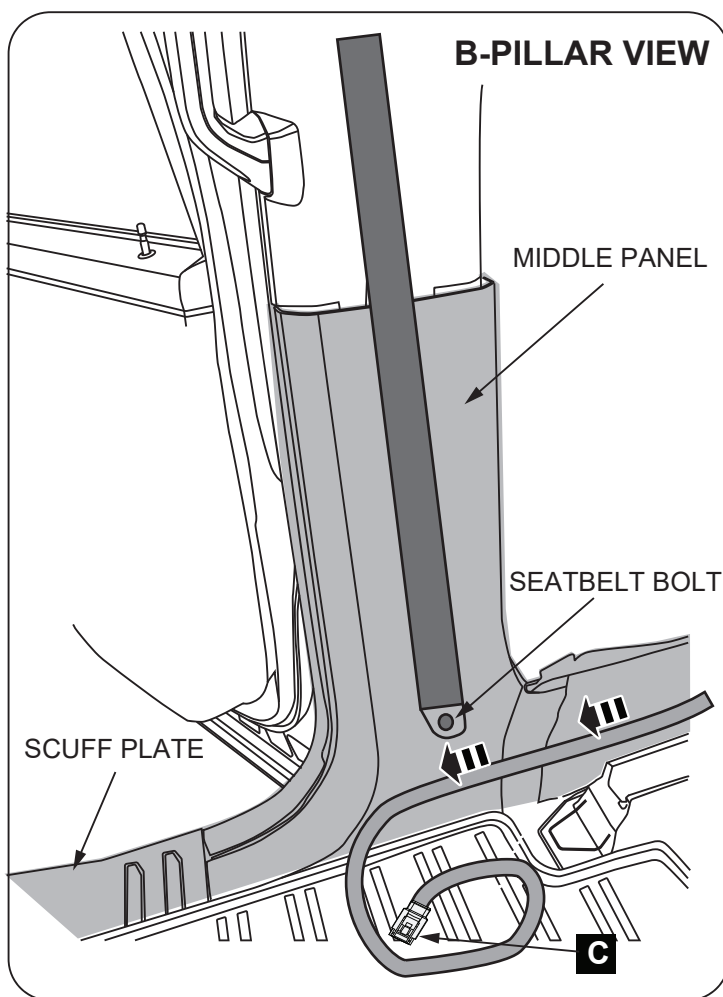
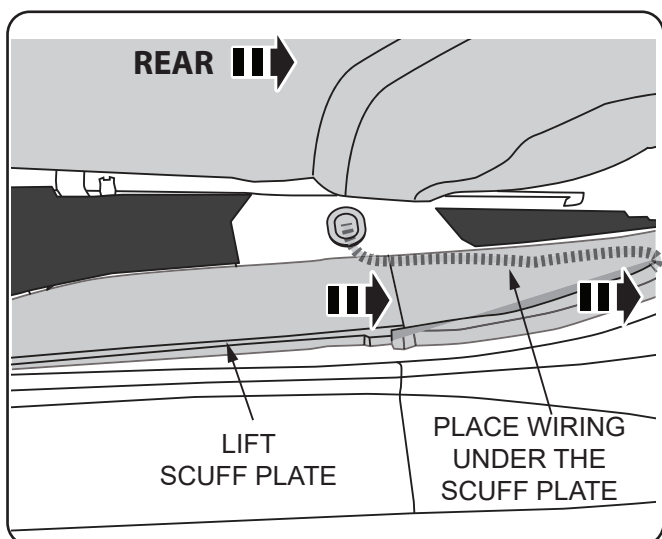

- 4** Lift the rear scuff plate. Remove the middle panel on the B-pillar as shown above. **IMPORTANT:** Remove the seatbelt bolt in order to remove the middle panel). Place the wiring under the scuff plate and run to the base of the B-pillar.

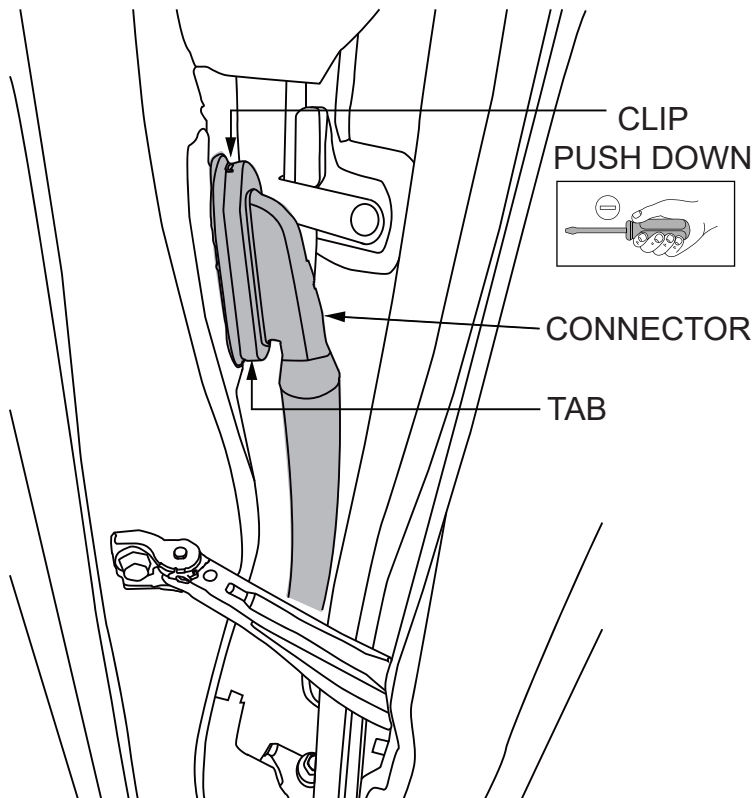

- 5** Locate the connector on the outside of the B-pillar and disconnect as shown.  
NOTE: Pull the tab under the rubber boot to remove the boot.

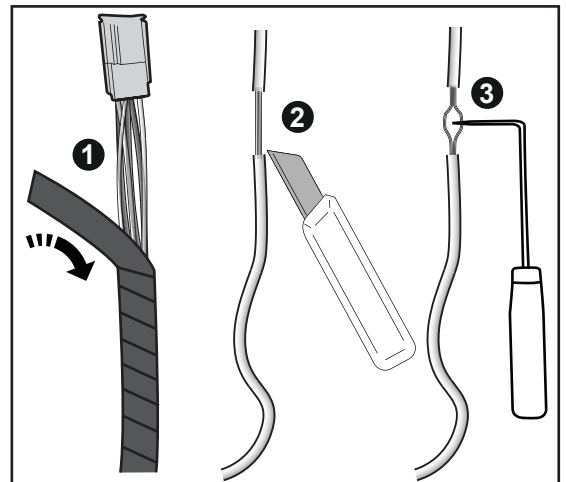
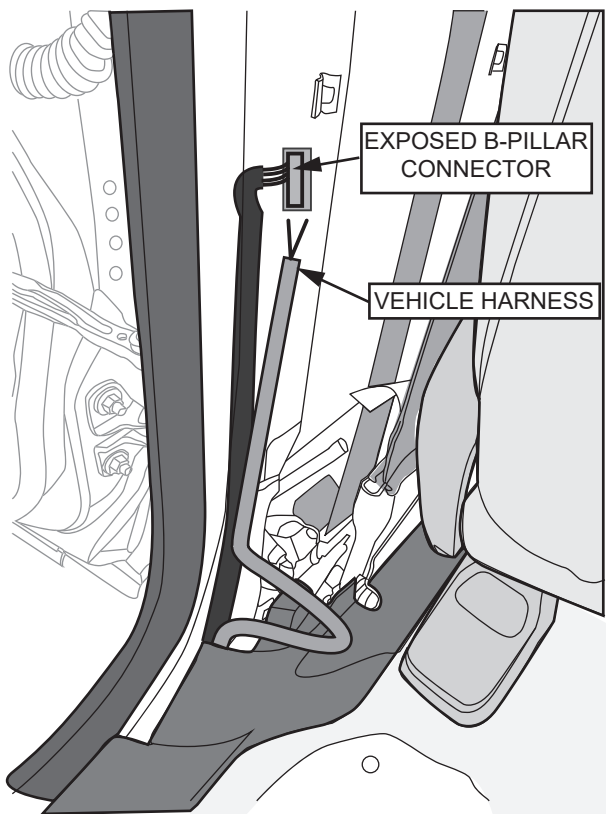

- 6** Locate the B-pillar harness plug and select the X and Y wires from the factory wiring. Strip 0.5 inch to expose copper as shown. Feed the Rolltrac vehicle harness up to the exposed wires on the B-pillar.

VEHICLE HARNESS	B-PILLAR HARNESS
ORANGE	PINK / RED
BROWN	PINK / GREEN

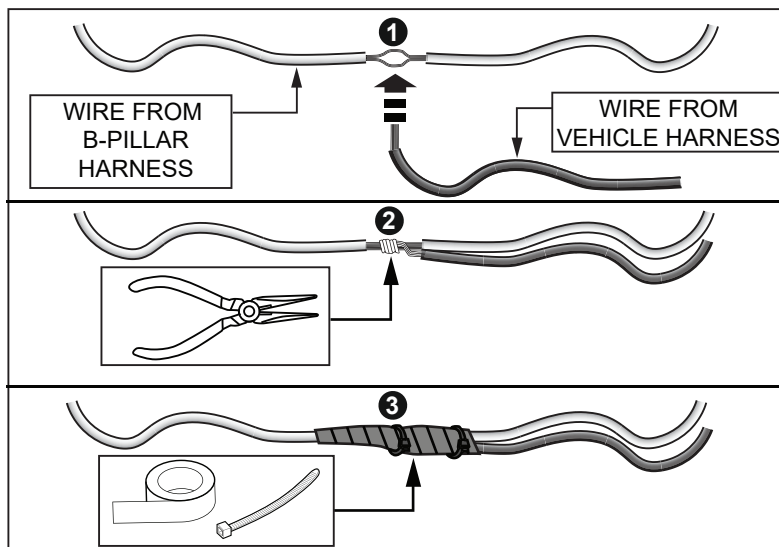

- 7** Insert stripped wires from vehicle harness unit through the hole in the factory wiring and wrap around it tightly. Use needle nose pliers to clamp down on the connection. Wrap the wires with 3M super 33+ or equivalent electrical tape. Zip ties can be added for additional security. Rewrap the harness back as it was originally. Secure Rolltrac harness to the existing harness using zip ties and refit the trim panel and scuff plate. Important: secure the Rolltrac vehicle harness neatly under the scuff plate.

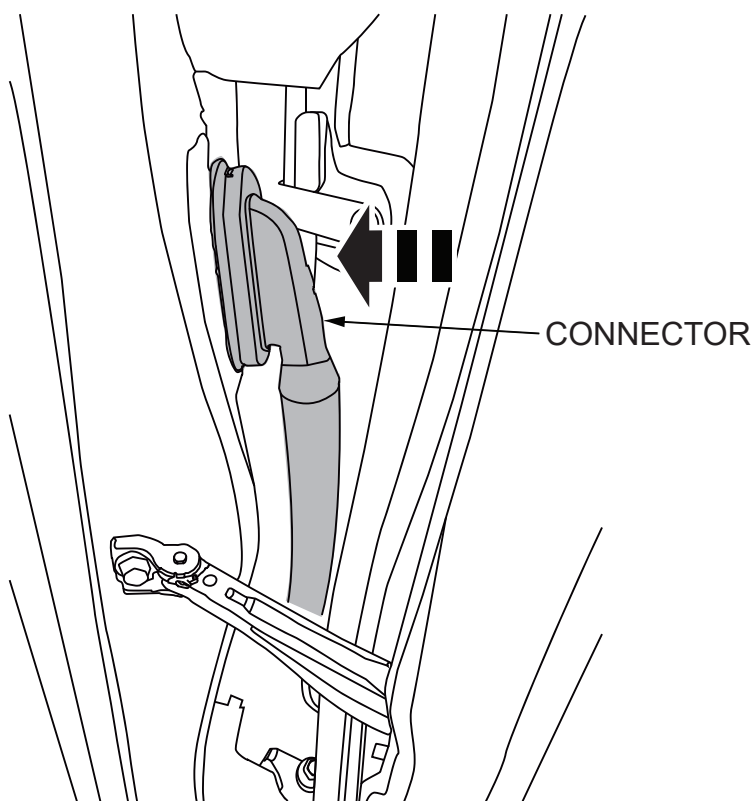

- 8** Refit the connector on the outside of the B-pillar as shown.

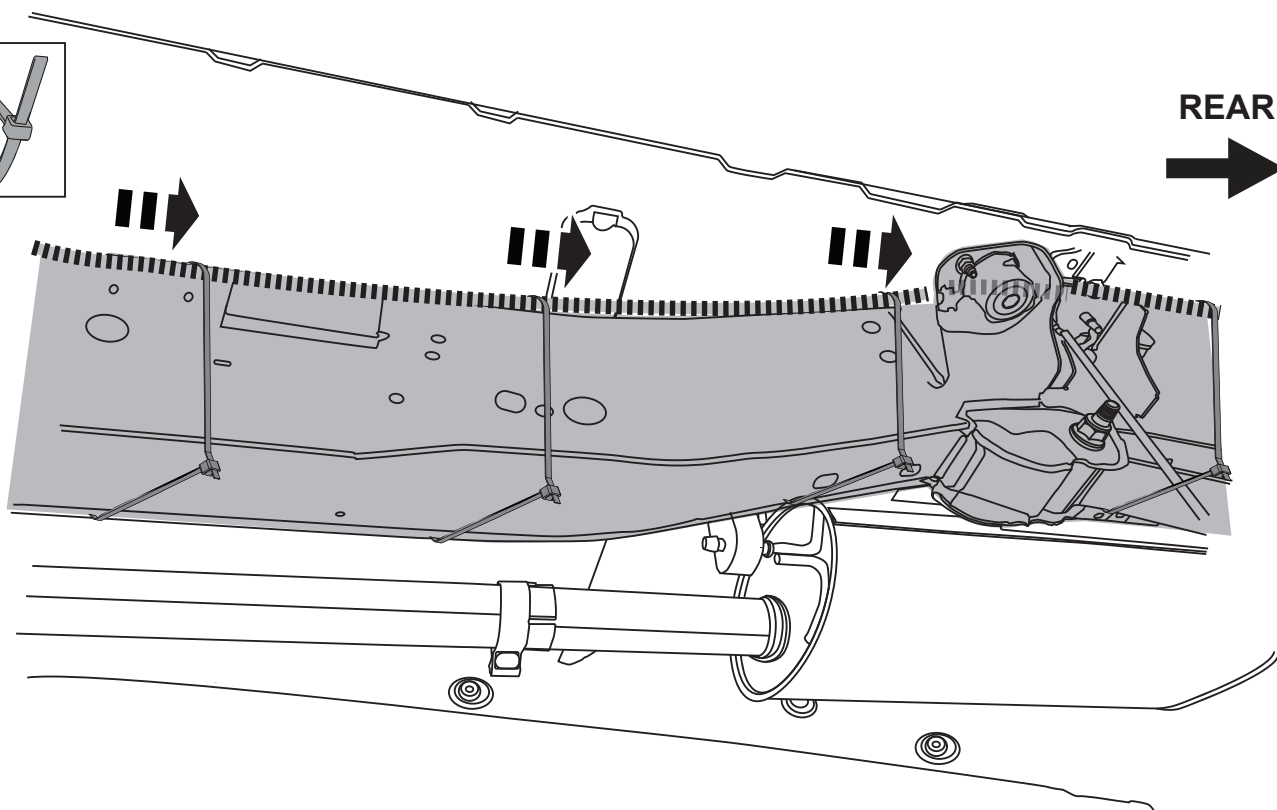
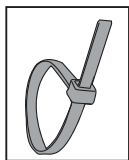

- 9** From underneath the vehicle, route the Vehicle Harness connector D towards the rear of the vehicle, following outside the chassis rail. Use the supplied cable ties and retain the harness every 200mm (8") to the chassis rail.

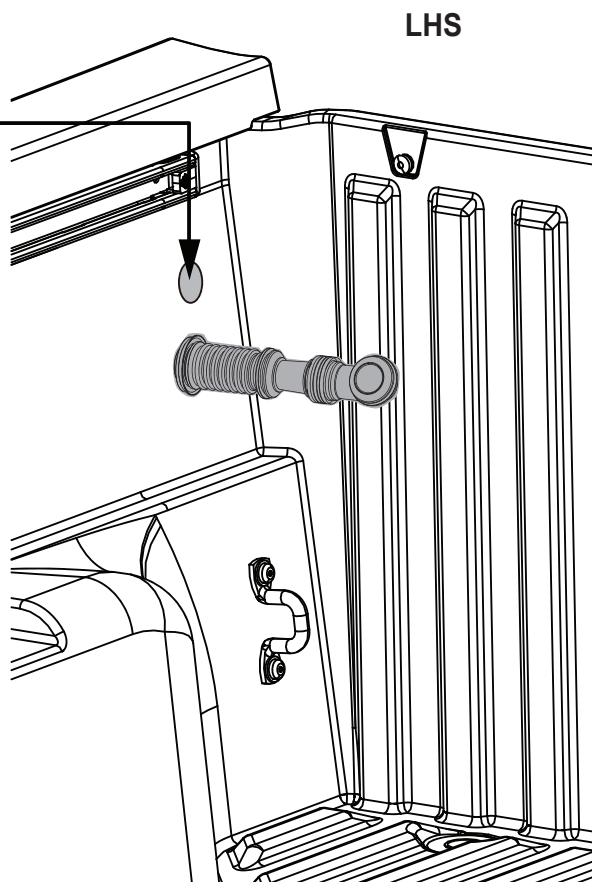
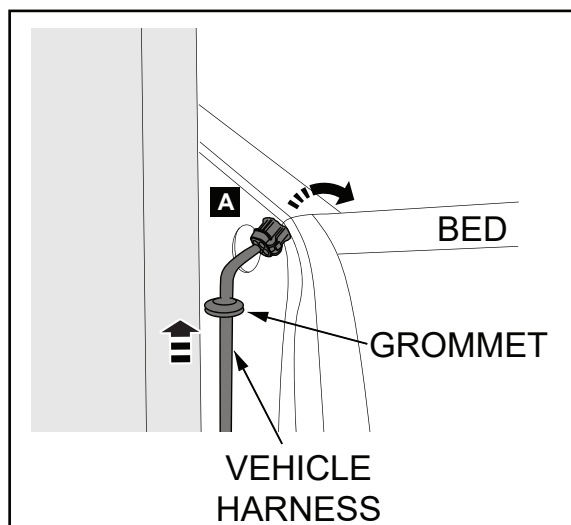
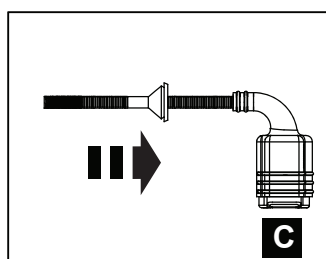

- 10** Pull up the connector (C) into the truck bed into the previously drilled hole in the front LHS of the bed, until the rubber grommet sits firmly in the hole.  
**IMPORTANT:** use draw wire to pull up the connector.



DURING ASSEMBLY PROCEDURE SUPPORT AT CENTER OF CANISTER ONLY,  
PLACE ON TOP AND BASE CARTON (OR SIMILAR), COVER WITH FOAM BLANKET.  
TO AVOID SCRATCHING POWDERCOATED SURFACES.  
DO NOT LOAD ELECTRICAL CONNECTORS OR MOTOR COVER.

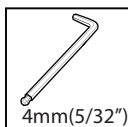
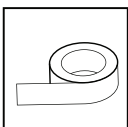

**FIT RHS  
FIRST**

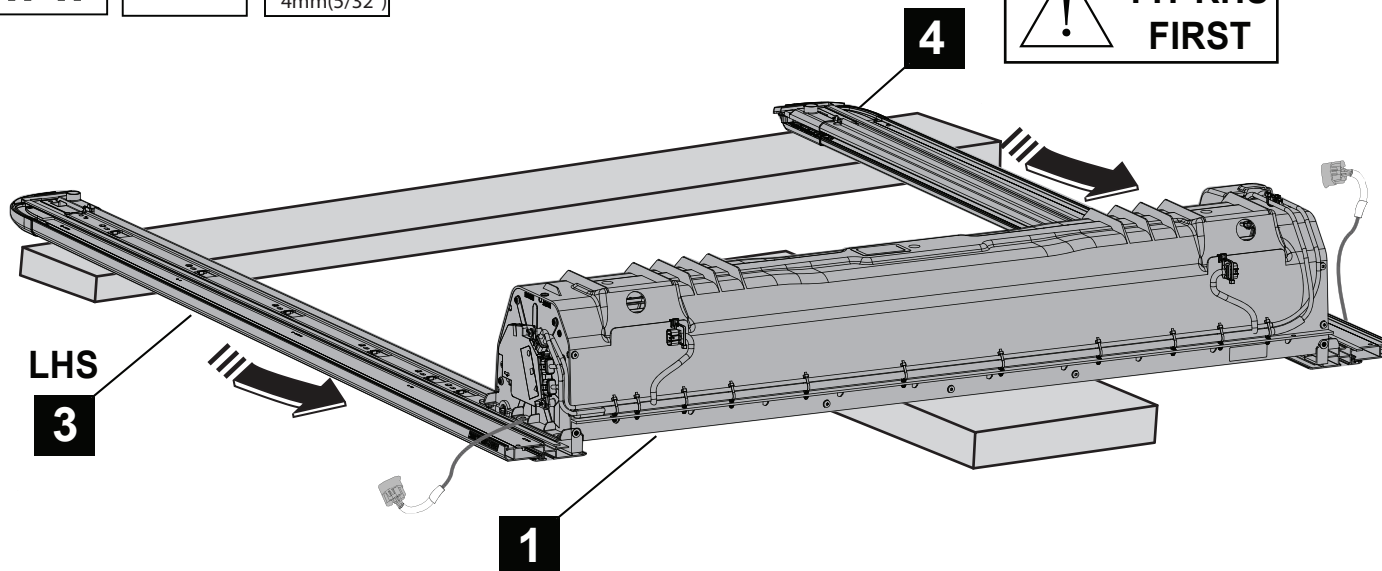

**1**



**ATTENTION: SEAL MUST FACE IN THE  
DIRECTION AS SHOWN. WARRANTY VOID IF  
ASSEMBLED INCORRECTLY.**

HOLD SEAL FLAT  
USE CLOTH TAPE

**RHS SHOWN**

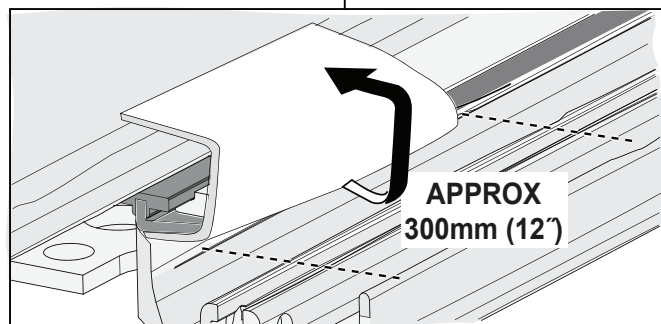
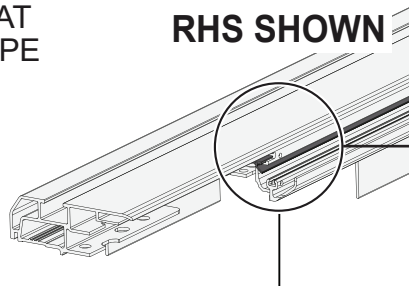
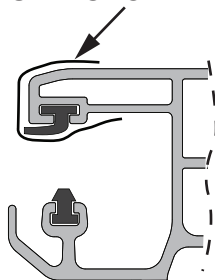

**APPROX  
300mm (12")**

**2**



**ATTENTION: EXPOSE 3 SLATS PRIOR TO  
FITTING SIDE RAILS.**



ENSURE ENDS ARE  
ALIGNED

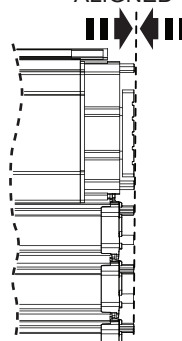

**ATTENTION: WIPE THE SEAL AND SIDE RAIL  
WITH WAX & GREASE REMOVAL TO ENSURE  
THE CLOTH TAPE WILL ADHERE TO THE SIDE  
RAIL AND SEAL**

- 1** Place the canister (1) on two protected boxes as shown, ensure hand rail and slat ends are aligned. Tape up the seal on the Side Rail (3) as shown.  
**IMPORTANT:** Carefully align and slide the rail over the handrail endcap and canister endplate taking particular care to ensure that the siderails are slid straight and no undue force is applied to the electrical contact. Details in following steps.



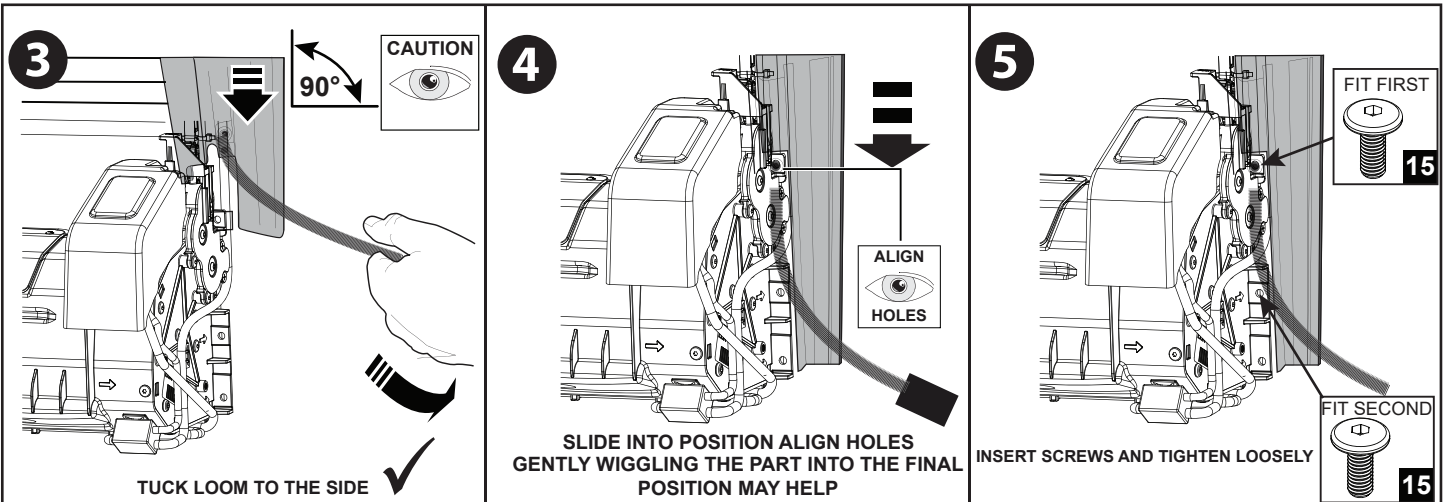

**2** Pull hand rail to expose 3 slats. Slide the RHS Rail over slat ends and onto endcap location pins. Align the holes and secure loosely with two screws (15). Do not tighten. Repeat for LHS Rail (4).

! DURING ASSEMBLY PROCEDURE SUPPORT AT CENTER OF CANISTER ONLY, PLACE ON TOP AND BASE CARTON (OR SIMILAR), COVER WITH FOAM BLANKET. TO AVOID SCRATCHING POWDERCOATED SURFACES. !

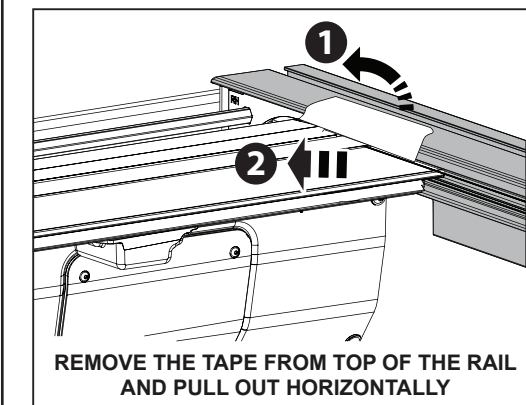
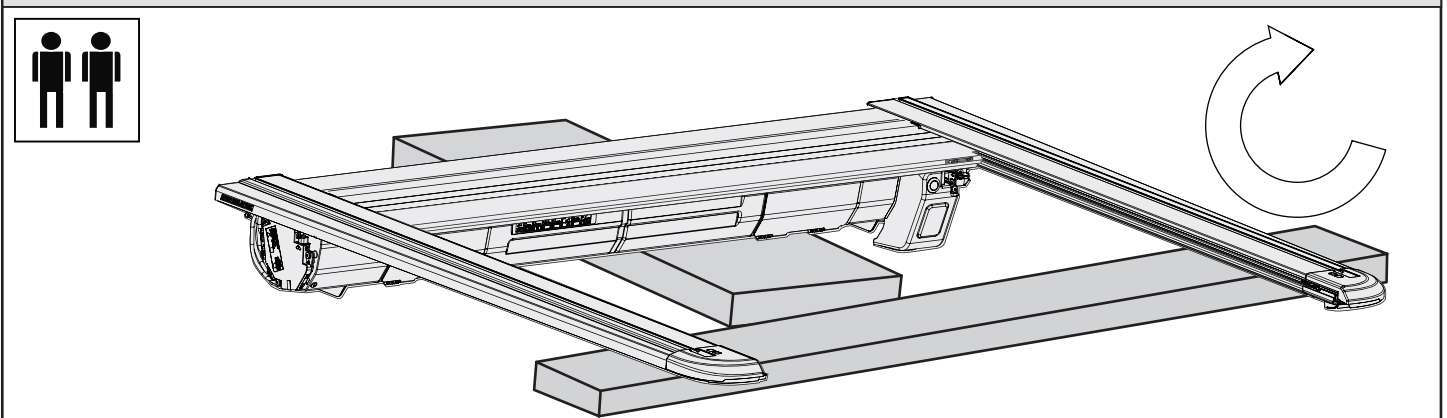

! ATTENTION: SEAL MUST FACE IN THE DIRECTION AS SHOWN. WARRANTY VOID IF ASSEMBLED INCORRECTLY.

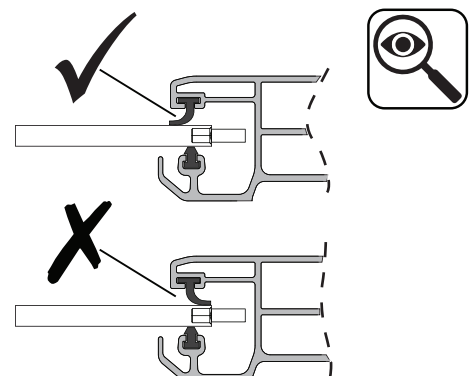
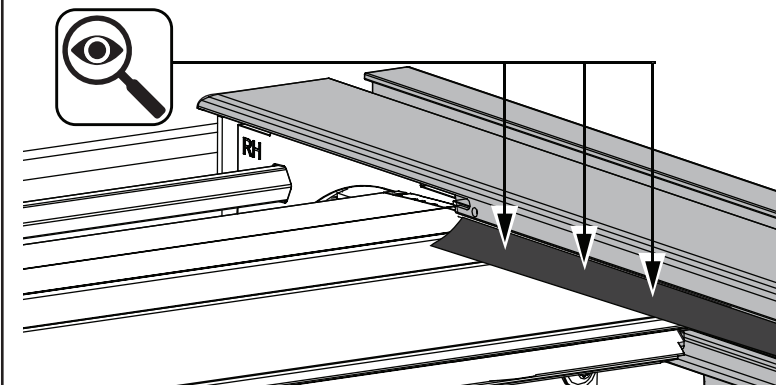

CHECK SEAL IS IN POSITION AND NOT DAMAGED

**3** Carefully turn the assembly over and place onto a protected surface. Remove the tape holding the rubber seal and check the seal position as shown. Repeat for LHS Rail.



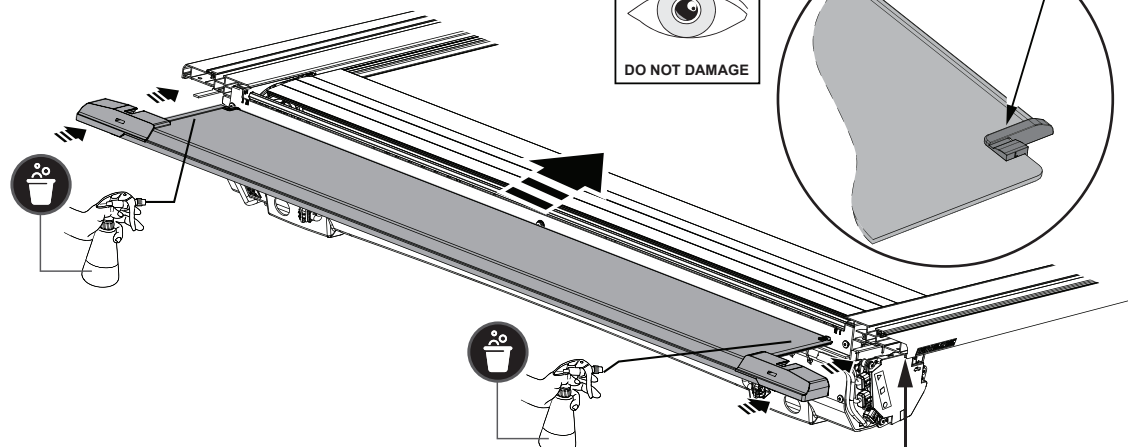
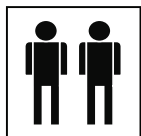

REMOVE TAPE SECURING  
THE RUBBER CORNER SEAL

**CAUTION**



DO NOT DAMAGE



**ATTENTION:** Remove  
foam tape end from the  
side rail before fitting into  
front cover

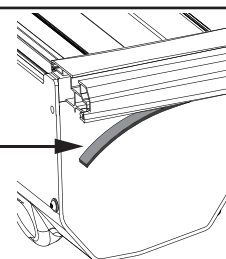

- 4** Slide the Front Plate (2) over the canister and into the side rail channels ensuring that the foam side rail tape is pulled out of side rail and the small rubber corner seal on the RHS and LHS of the front plate are not damaged.  
**IMPORTANT:** Spray the front cover edge with soapy water to allow it to slide easily into the sides, twisting side rails outwards will also help.

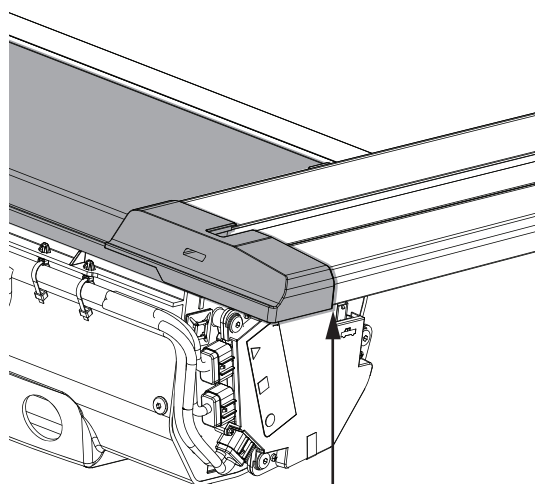
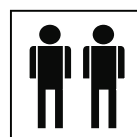

**CAUTION**



DO NOT DAMAGE

LHS SHOWN

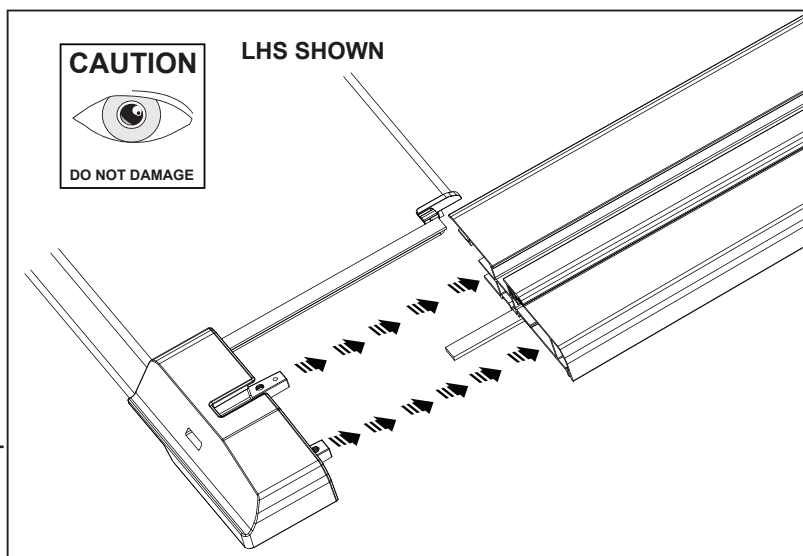

- 5** While sliding the front cover ensure the cast connectors are align.

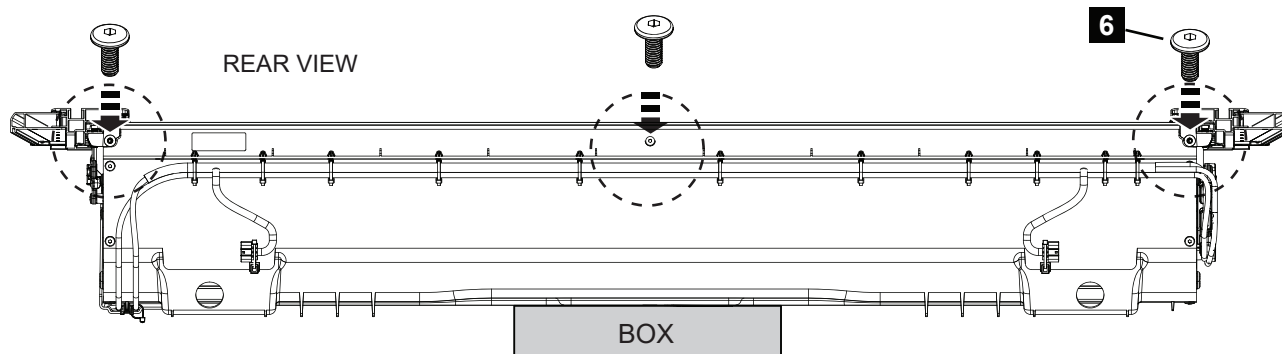
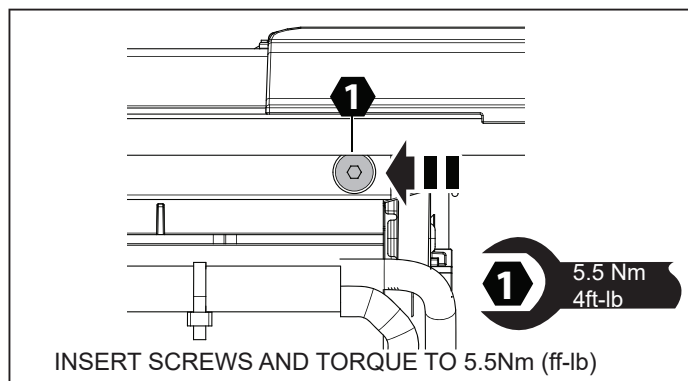
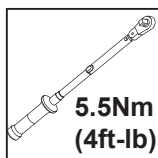
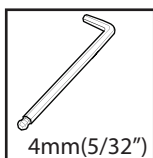

**6** Using 3 screws (6), secure the Front Plate (2) to the Canister Assembly (1) and torque to 5.5Nm (4ft-lb).

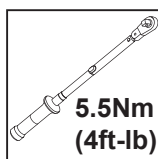
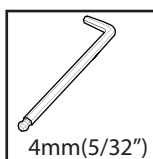

SIDE VIEW



LHS

RHS

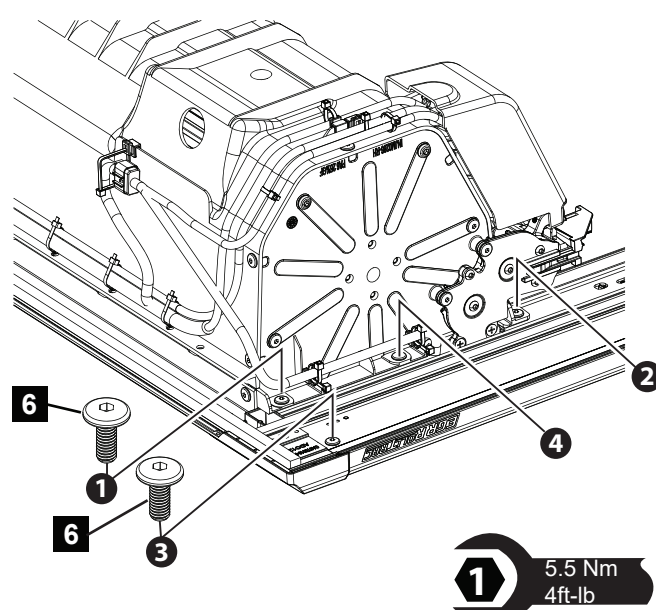
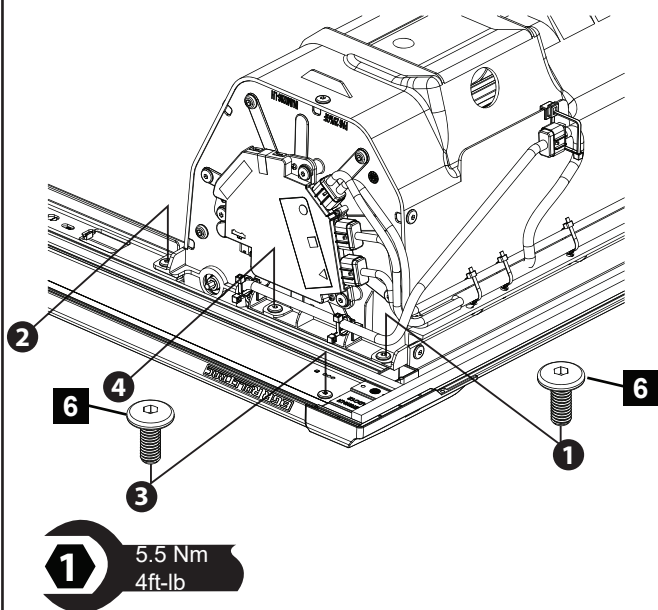

**7** Carefully flip the assembly over onto a flat protected surface which will not damage the cover or scratch the paint work. Install the 2 screws (6) on each side through the canister and side rail into front cover. Torque all screws in order shown to 5.5Nm (4ft-lb).

## LHS SHOWN - RHS IS A MIRROR IMAGE

CLEAN WITH  
ALCOHOL FIRST

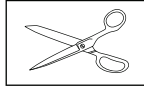
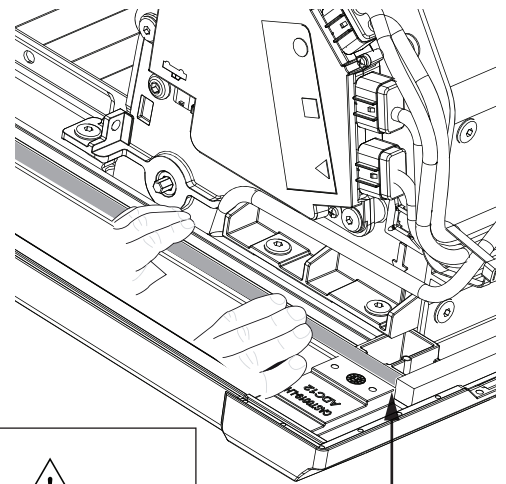
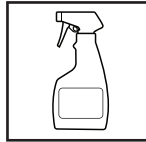

**TAPES MUST CONTACT**

- 8** Clean powder coated surface first with alcohol spray. Trim foam tape length to ensure the end will butt against front cover seal - avoiding any gap. Peel the protective liner from the foam tape, adhere to the channel in the side rail, Press down firmly to secure. Repeat on RH side rail.

**CONNECT**



**1 PUSH**



**2 CLICK**



**3 PULL** ✓



**LHS**

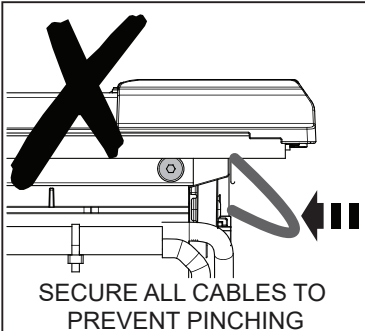
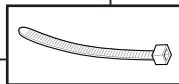
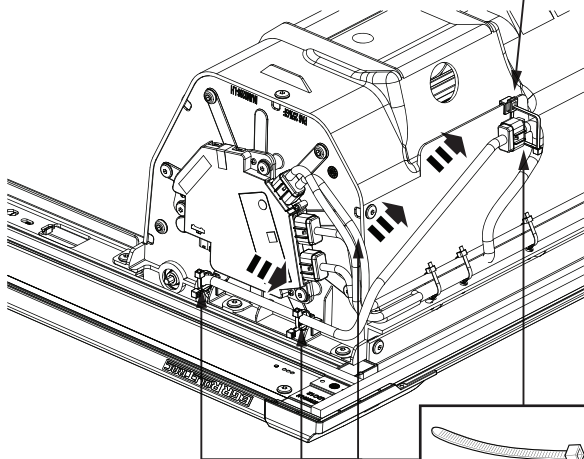

**CONNECT**



**1 PUSH**



**2 CLICK**



**3 PULL** ✓



**RHS**

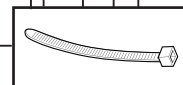
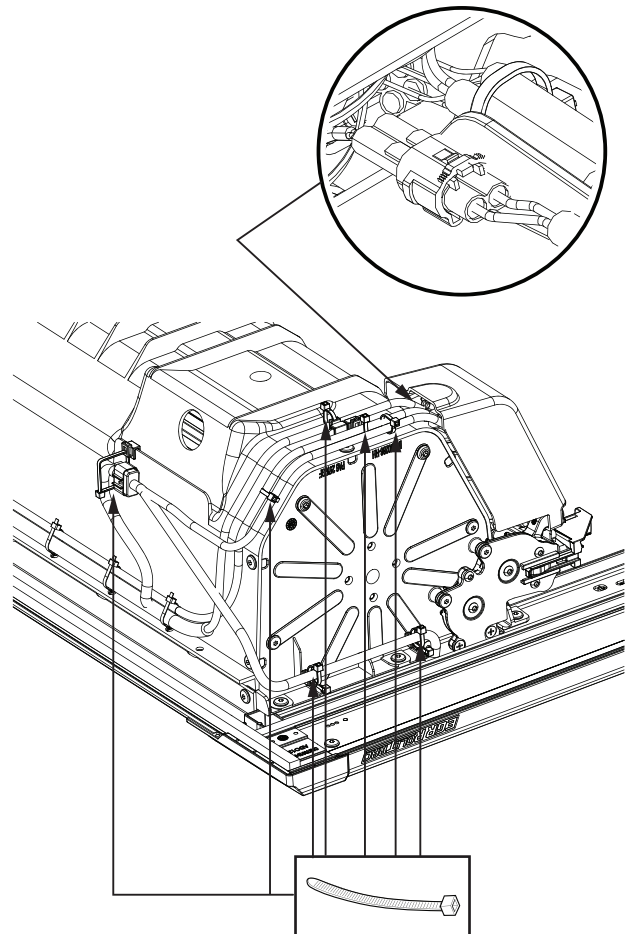

- 9** Connect side rail harness connectors to the connectors on the canister on the LHS and RHS. Connect the lamp connector as shown next to the motor on the RHS. Secure the harness to the canister using cable ties and pads as shown. Ensure all cables are retained to prevent pinching during installation.

INSTALL RUBBER SEAL  
IN SIDE RAILS

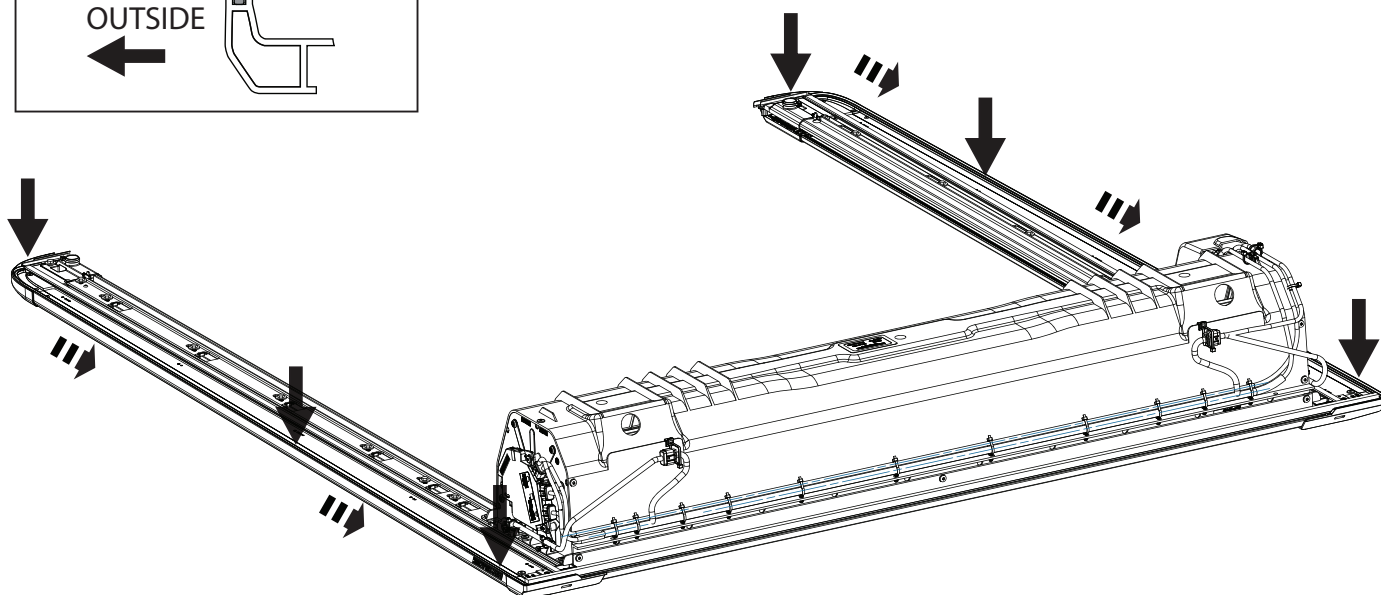
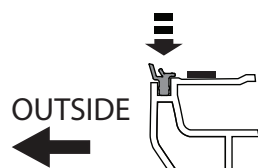
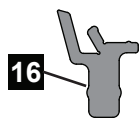

- 10** Install the Rubber Perimeter Seal (16) into each side rail and ensure seal is firmly seated (note the seal orientation).  
**Important:** do not stretch the seal while fitting.

CONTINUE ON THE NEXT PAGE

## SETTING BRACE - USER GUIDE

- NOT TO BE USED AS LIFTING DEVICE
- DIAGONAL MEASUREMENTS ARE REQUIRED AS PER THE FITTING INSTRUCTIONS
- SETTING BRACE SHOULD BE REMOVED ONLY WHEN SET UP IS COMPLETED

Setting Brace comes assembled. Fit the taped plates with washers and wing screws to both ends of the Setting Brace. Place the Setting Brace over the rear of the side rails and slide the taped plates into the key holes as shown. Once in position, slide the brace backwards till the plastic part of the brace comes to contact with the edge of the rear End cap. Tighten the wing bolt (finger tight only).



**HEAVY**

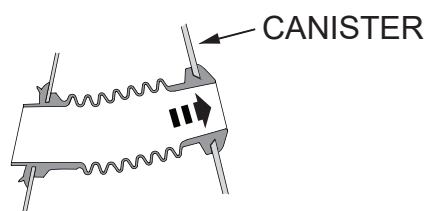
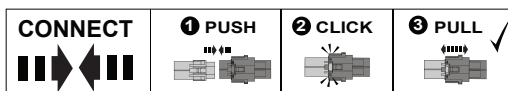
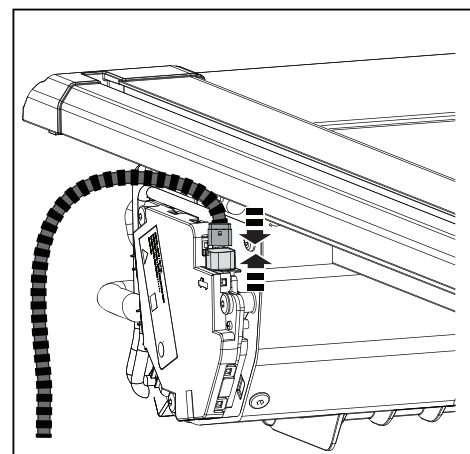
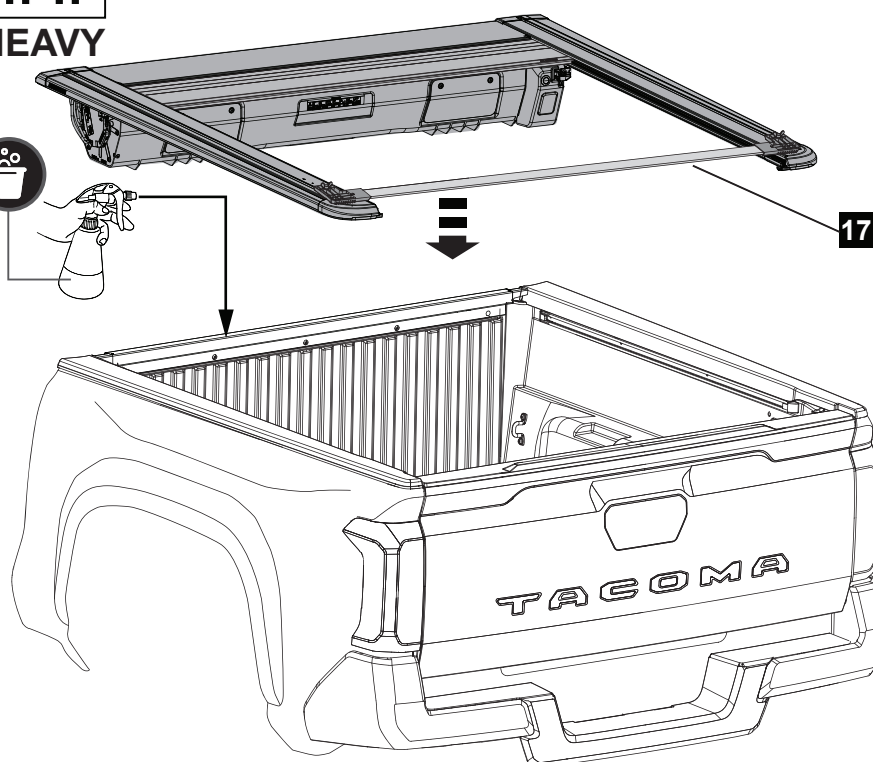

INSTALL FRONT DRAIN TUBES

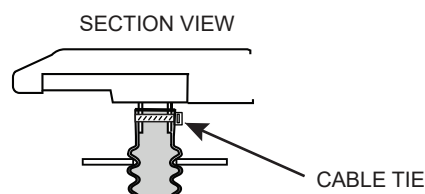

FIT REAR DRAIN TUBES TO SIDE RAILS

- 1 Spray the top surface of the tub liberally with a soapy water solution to enable the Cover to slide easily. Using two people to lift the cover from both sides and carefully lower it onto the tub. Before dropping onto the tub, place two cardboard packers to hold the RollTrac off the final position in tub to support electrical connection and to allow gentle final placement of RollTrac onto tub. Connect the vehicle harness to the ECU as shown. Drop the RollTrac straight onto tub. Connect the front drain tubes to the canister. Connect the rear drain tubes and secure with cable ties.



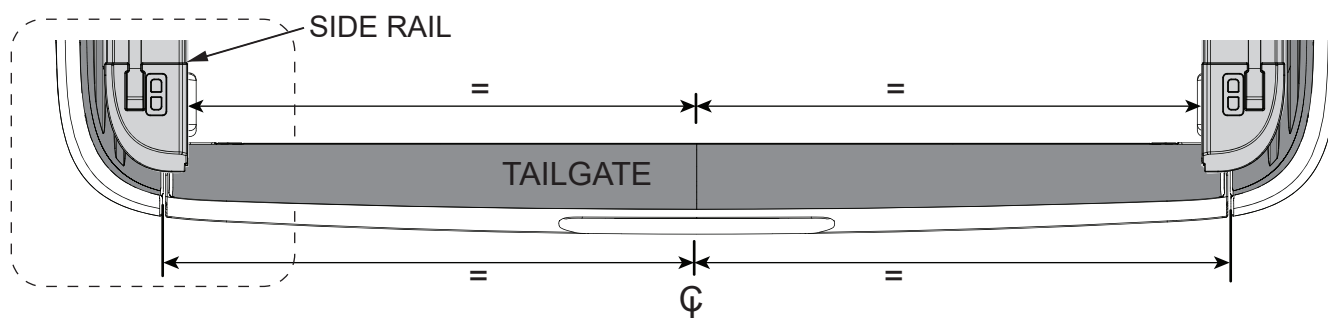

CENTRALISE AND ALIGN THE COVER TO THE MARKINGS

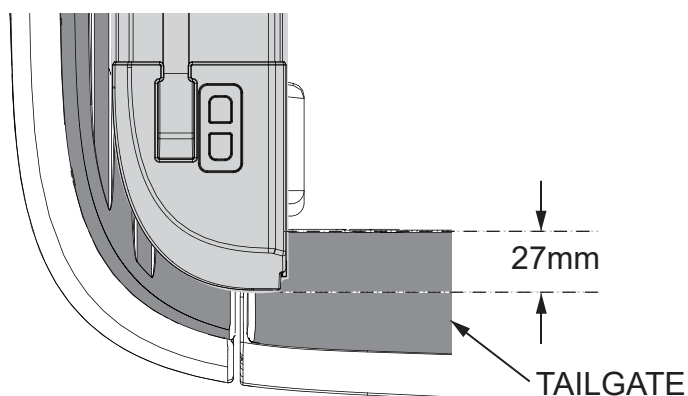

COVER POSITION REARWARDS

FRONT SEAL

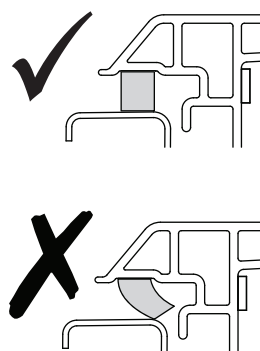

- 2** Apply masking tape at the centre of the tailgate. Measure the distance between the rear corners of the tub and draw a centre line on the masking tape. Measure the distance from the marked centre line to both rear corners of the RollTrac and ensure it is equally distanced.

Adjust the cover so that it is aligned with the markings as shown. Ensure seals are not deformed by lifting cover and dropping vertically on tub.

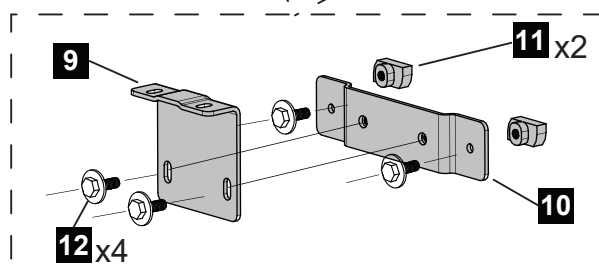
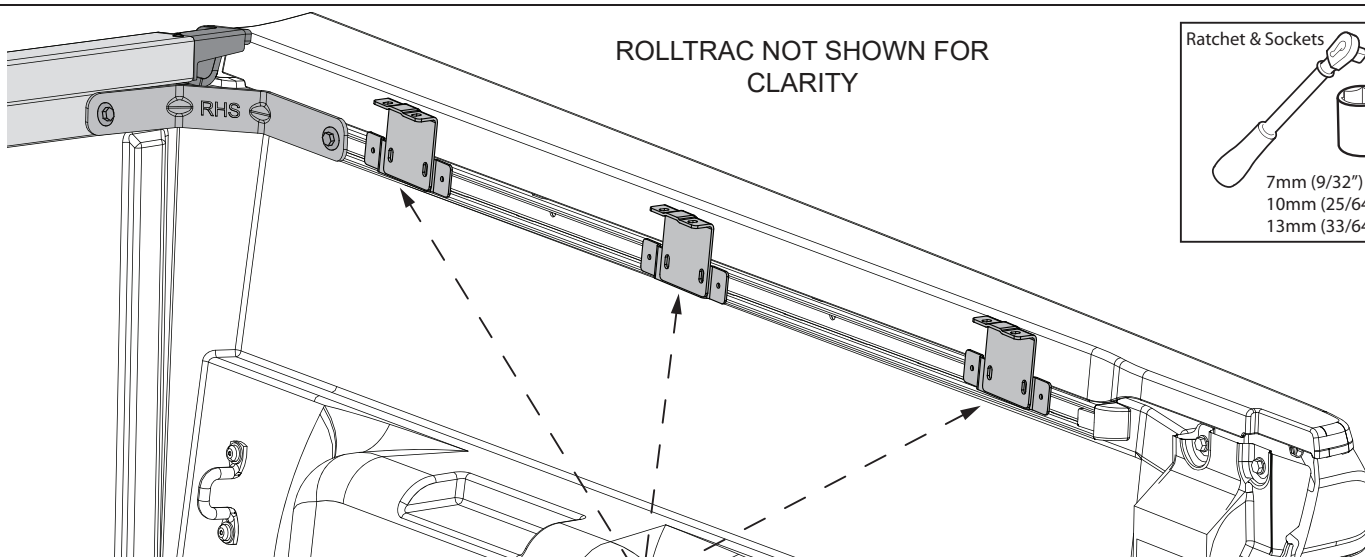

- 3** Fit the side rail brackets (10&9) to the utility rail using T-nuts (11) and screws (12) as shown in 3 locations. Align the top holes in the bracket (9) with the holes in the side rail. Do not tighten the screws.

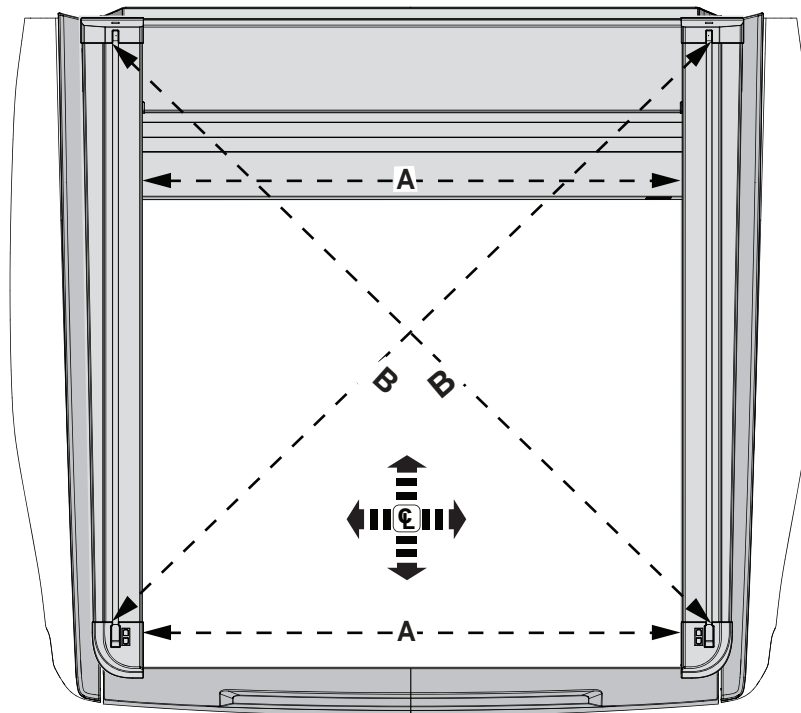
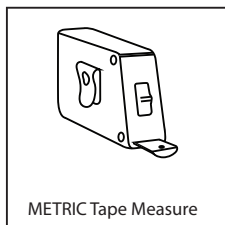

A = A B = B

### PERFORM FITMENT CHECK

**4** Perform diagonal fitment check.

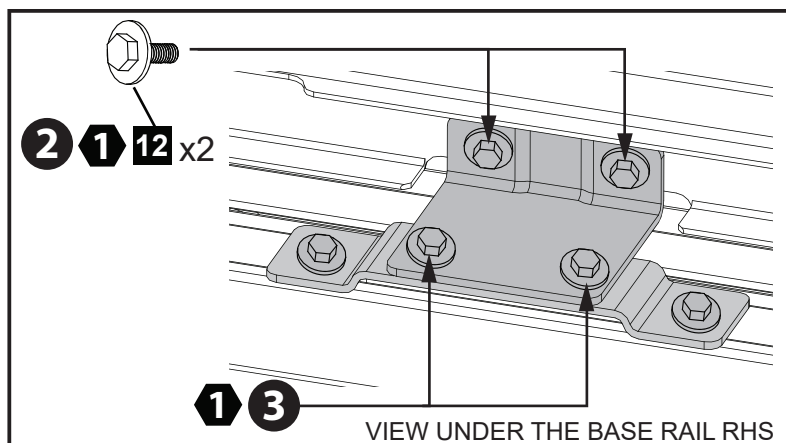
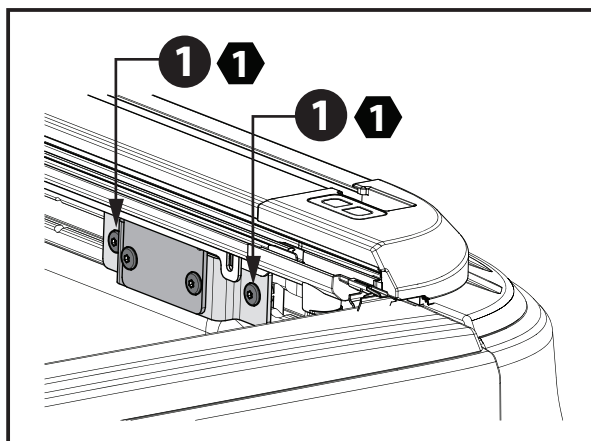

### Bolt Tightening Sequence

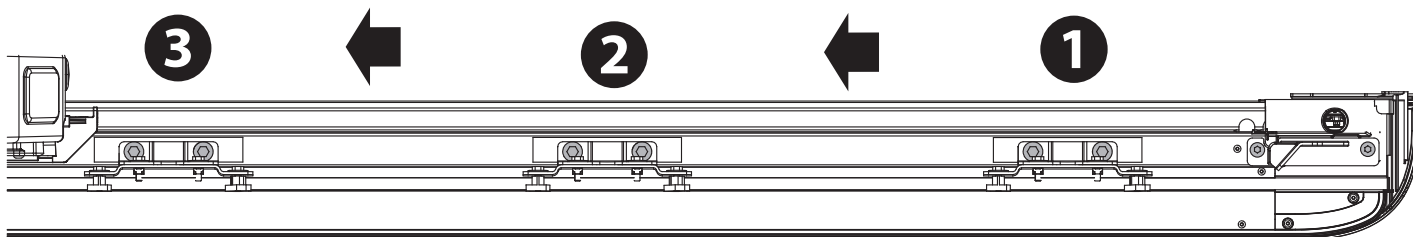

**5** Fit the side rail brackets to the base rails with two screws (12) as shown in top detail. Torque the screws following the sequence in the detail. Work from the rear to the front as shown.



## SILICONE LUBRICATION TO THE SPIRALS (MODELS MAY VARY, IMAGES FOR REFERENCE ONLY)

- 1** Open tailgate and EGR RollTrac

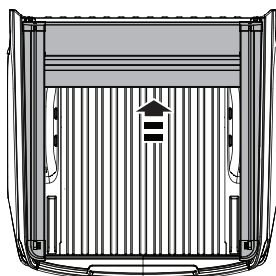
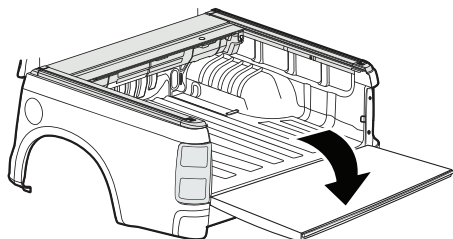

### TOOLS REQUIRED:

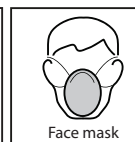
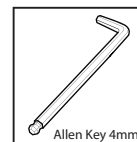

- 2** Using a 2.5mm Allen Key remove the 4 screws and open the inspection covers.  
**WARNING:** Keep clear of moving parts and avoid unnecessary operation of the EGR RollTrac while inspection covers are open.

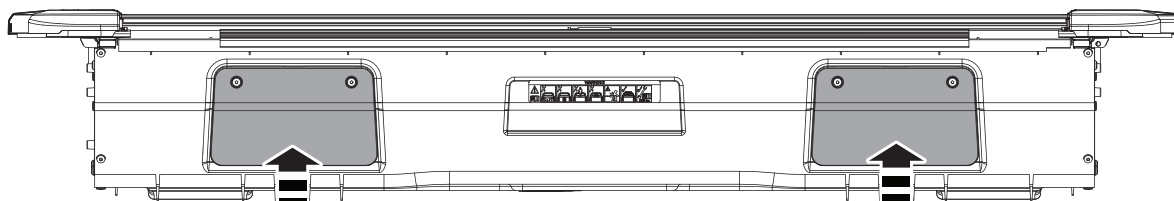

INSPECTION COVER

INSPECTION COVER

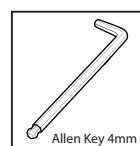

- 3** Close the EGR RollTrac to access canister internals

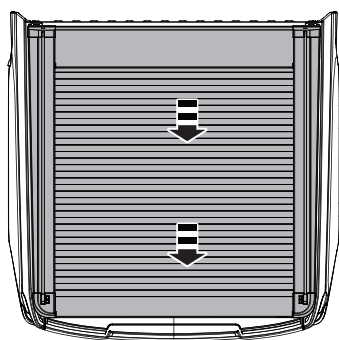

- 4** To avoid water leaks, look into the inspection points and check that the flanges of both front drain tubes are correctly engaged to the canister cover (without any kinking etc.), readjust if required.

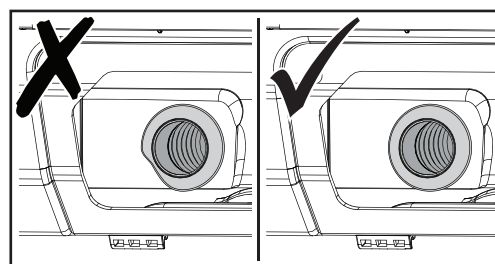

- 5** Using plastic compatible 100% Silicone Spray (ONLY) spray onto the spirals on both ends of the canister through the inspection points.

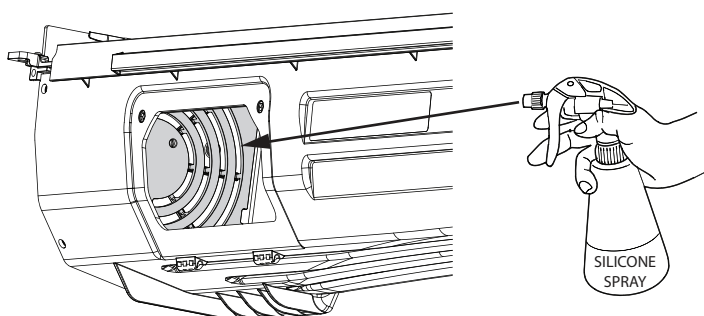

- 6** Open the EGR RollTrac

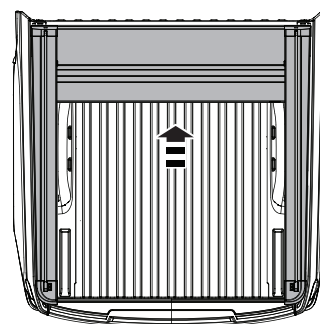

- 7** Close the inspection covers and secure with retained screws. Open and close the EGR RollTrac to distribute lubricant and check operation.

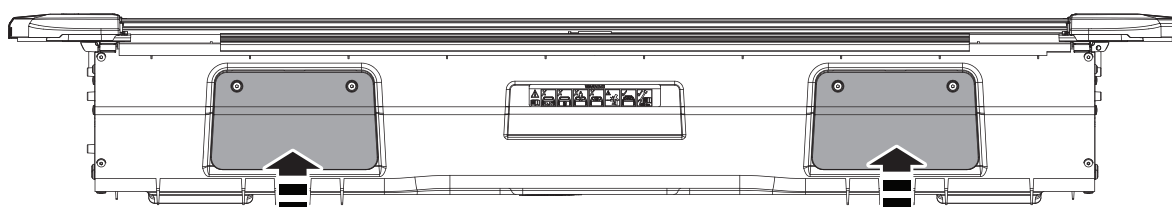

INSPECTION COVER

INSPECTION COVER

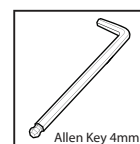

1. Insert fuse to EGR RollTrac harness.
2. Make sure the tailgate is closed.
3. Engage motor, pull out lever (clutch).
4. Make sure the vehicle is unlocked and driver door open.
5. Press both buttons and hold for 5 sec. until light illuminates.



**WARNING:** Keep obstructions clear of cover during calibration mode.

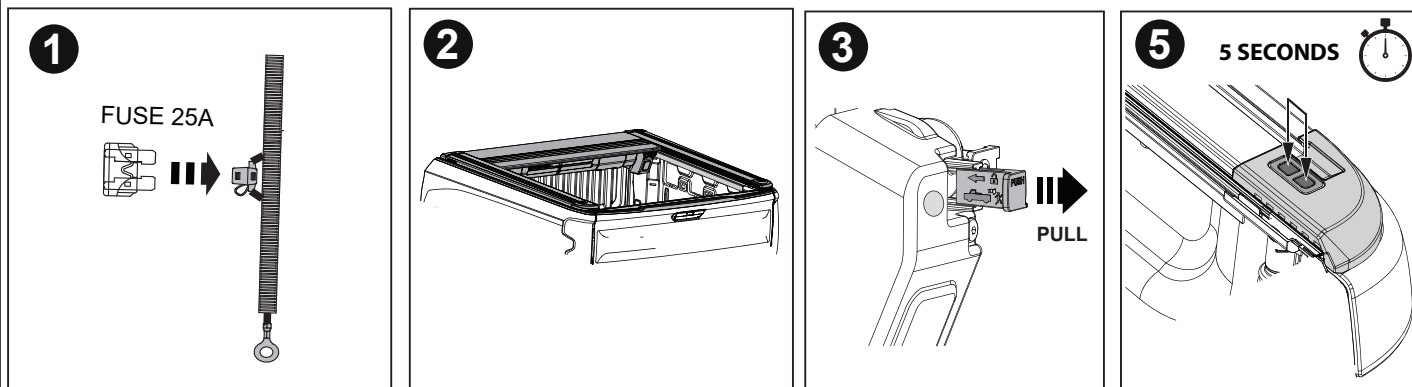

- Cover will CLOSE and OPEN once automatically.
- The EGR RollTrac internal LED light will pulse slowly during calibration and stop pulsing when calibration is complete.

START OF CALIBRATION

2 SECOND PULSE  
DURING CALIBRATION

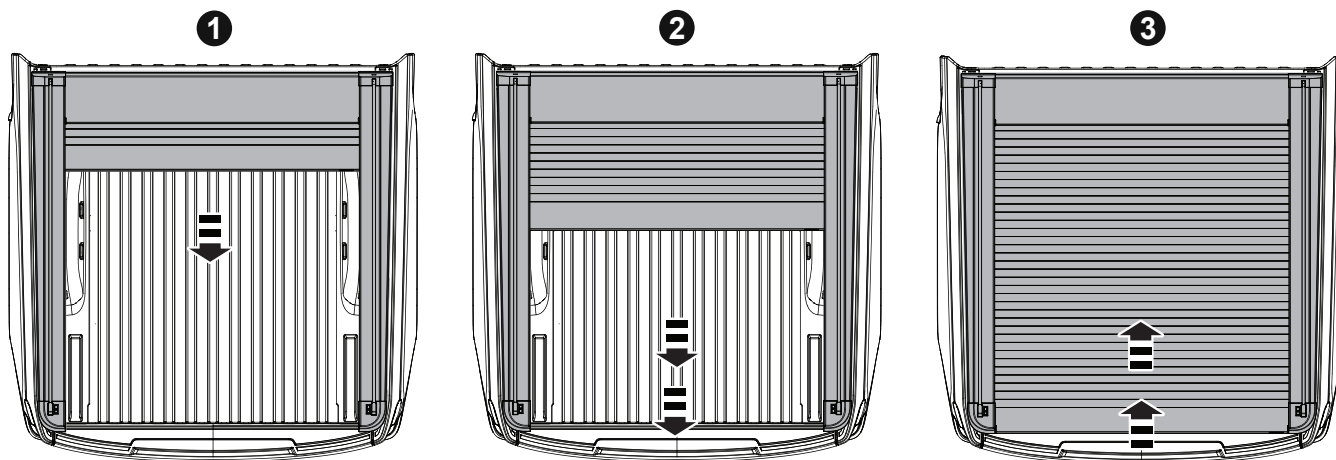

END OF CALIBRATION

## OPENING AND CLOSING PROCEDURE

### Electric Opening Procedure:

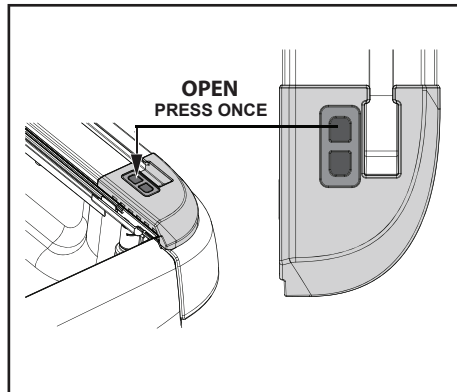
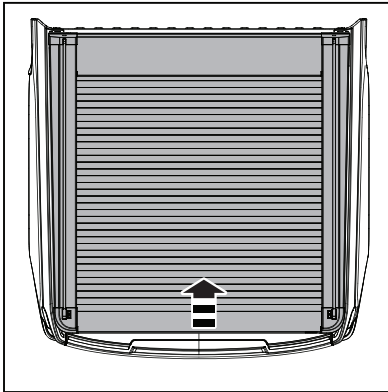

1. Press the front button on the EGR RollTrac side rail as shown.

### Electric Closing Procedure:

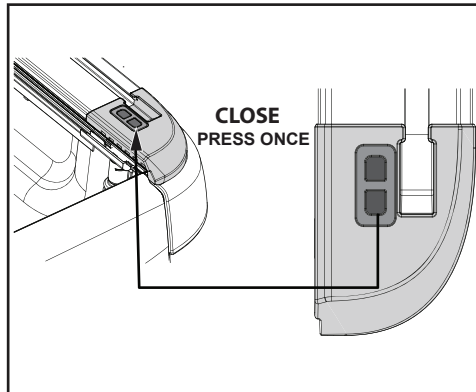
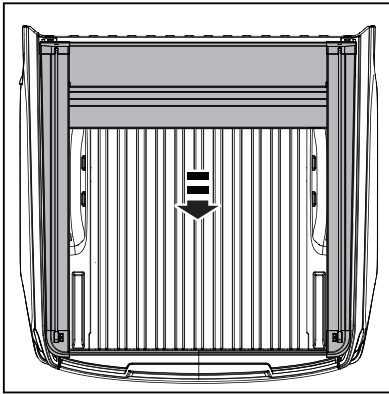

1. Press the rear button on the EGR RollTrac side rail as shown.

**NOTE:** EGR RollTrac should open and close smoothly. If cover does not lock or open correctly, please refer to the trouble shooting section in the Owners Manual. If the EGR RollTrac closing is slow, clean the siderails and ensure that no dirt or debris is inside the drive rail.

### Manual Opening and Closing Procedure:

Locate the Clutch Disengagement Lever on the RH side of the cover and push the Clutch inward to disengage the motor. Pull the cover rearward or forward as required. Before driving vehicle ensure you re-engage the clutch.

**IMPORTANT:** If clutch was disengaged, calibration procedure needs to be re-run prior to electric operation.

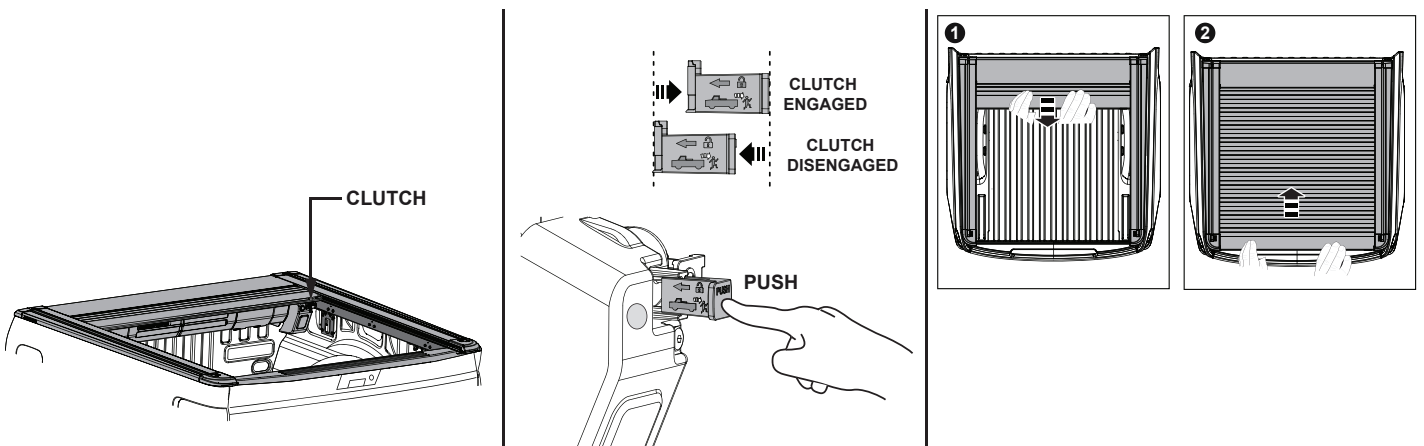

# KEY FOB OPERATION

**IMPORTANT:** We recommend that you program your key fob to lock and unlock all doors using one click only. This function can be set on your infotainment screen using the vehicle system control function/setup:

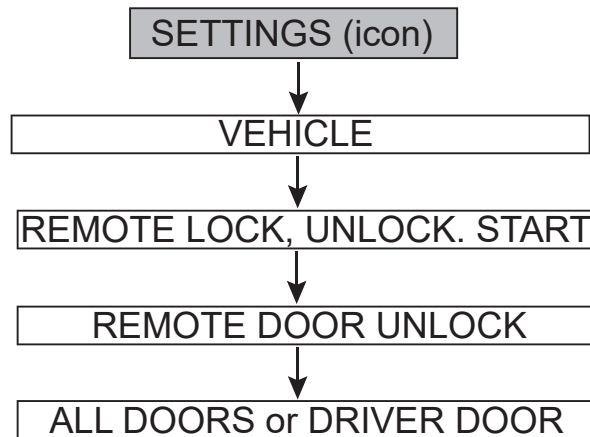

## LOCKING / AUTO CLOSE PROCEDURE

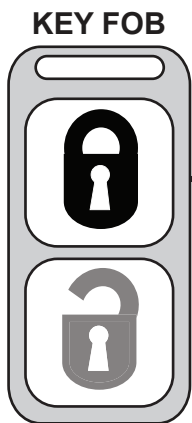

1. Press lock **twice within 2 seconds**, the vehicle will lock, if closed the RollTrac will lock, if open it will auto close.
2. To pause while in auto close motion, press lock **once** and the RollTrac will stop.
3. To resume auto close, press lock **twice within 2 seconds**.
4. When auto close is complete the RollTrac will auto lock.

## UNLOCKING / AUTO OPEN PROCEDURE

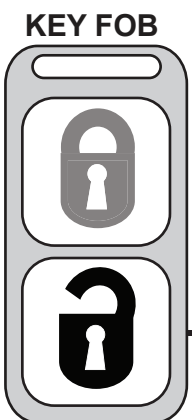

1. Press unlock **4 times within 3 seconds**, the vehicle will unlock and the RollTrac will auto open.
2. To pause while in auto open motion, press unlock button **once** and the RollTrac will stop.
3. To resume auto open, press unlock **twice within 2 seconds**.
4. When auto open is complete the RollTrac will remain open until operated by either the key fob or the RollTrac buttons.

## NOTES

- If pause is activated by the fob whilst auto closing, the RollTrac can be closed and paused using the RollTrac close button. Reactivate both Rolltrac buttons by unlocking the vehicle.
- If the RollTrac is open and the lock button is only pressed once, the vehicle and the RollTrac will lock.