

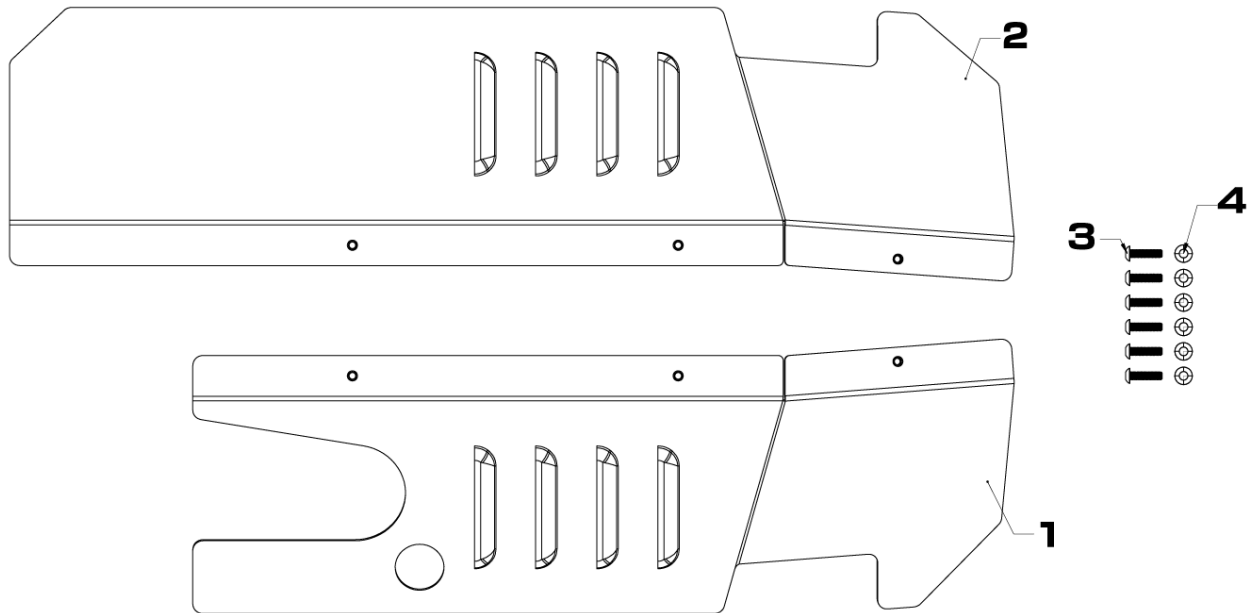

79C27024
aFe Power Gravel Guards
Subaru Outback 20+ BT Platform



Item	Description	P/N	Qty
1	Shield, LH	05-61652	1
2	Shield, RH	05-61653	1
3	Screw, Btn Hd Socket: M5x.8x15, S/S Black	03-50797	6
4	Washer, Wavy: M5	03-50805	6

Fitment Note

Our Gravel Guards are a direct fit for the following aFe POWER Terra Guard Bumpers

- 79-27009
- 79-27012
- 79-27015
- 79-27016

Requires Engine Skid Plate (**79C27020**). Not included



- Please read the entire instruction manual before proceeding.
- Ensure all components listed are present.
- For technical support please call 951-493-7185.
- Ensure you have all necessary tools before proceeding.
- Retain factory parts for future use.

Procedure:

1. This engine skid plate is a direct fit for our aFe POWER Terra Guard bumpers for the 20+ Subaru Outback BT platform. This skid plate is only compatible with aFe bumpers. The aFe gravel guards must be installed with aFe engine skid plate (**79C27020**)
2. Lift the vehicle using floor ramps or a lift. Observe the layout of the (6) mounting holes.

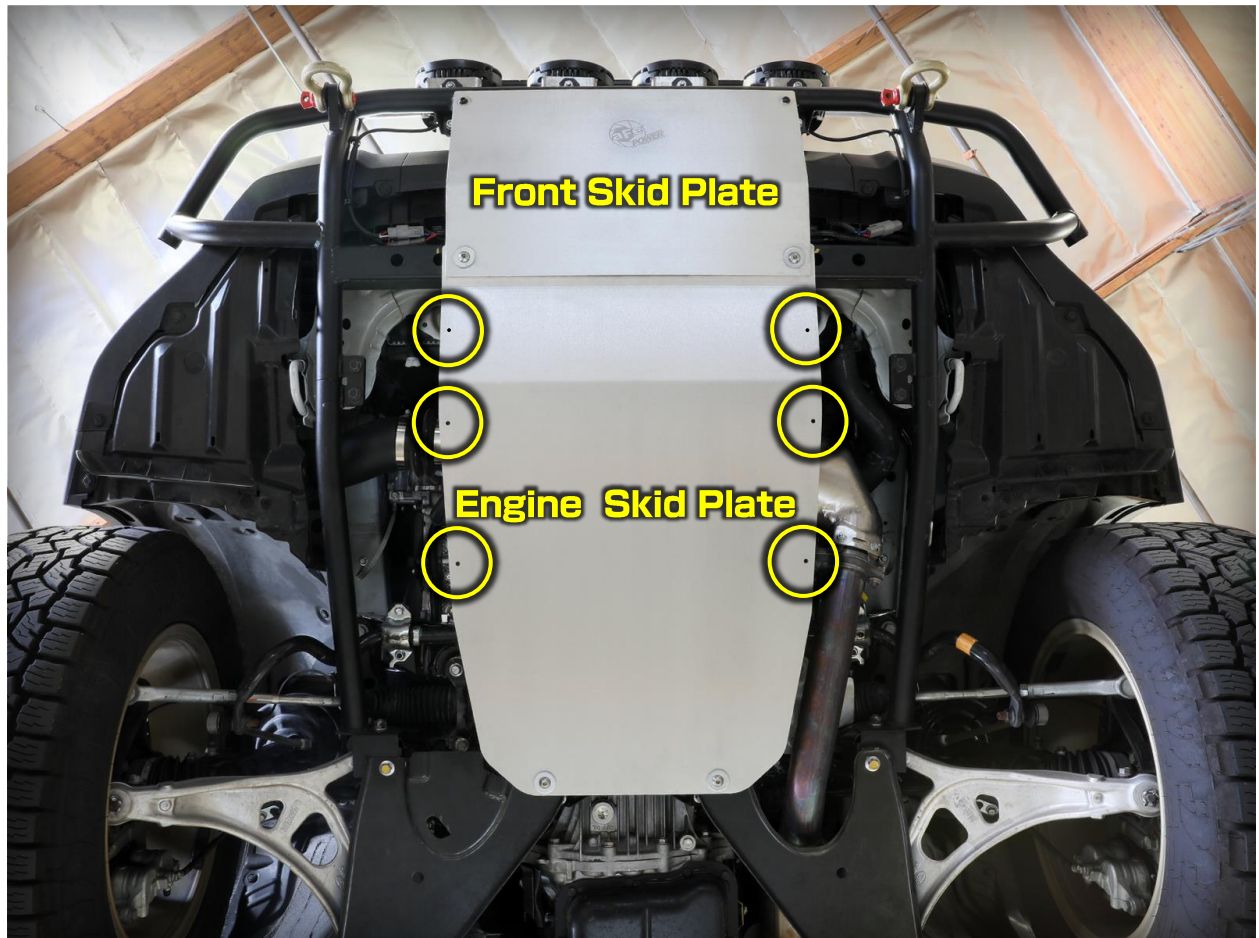



3. Install the gravel guards as shown below.

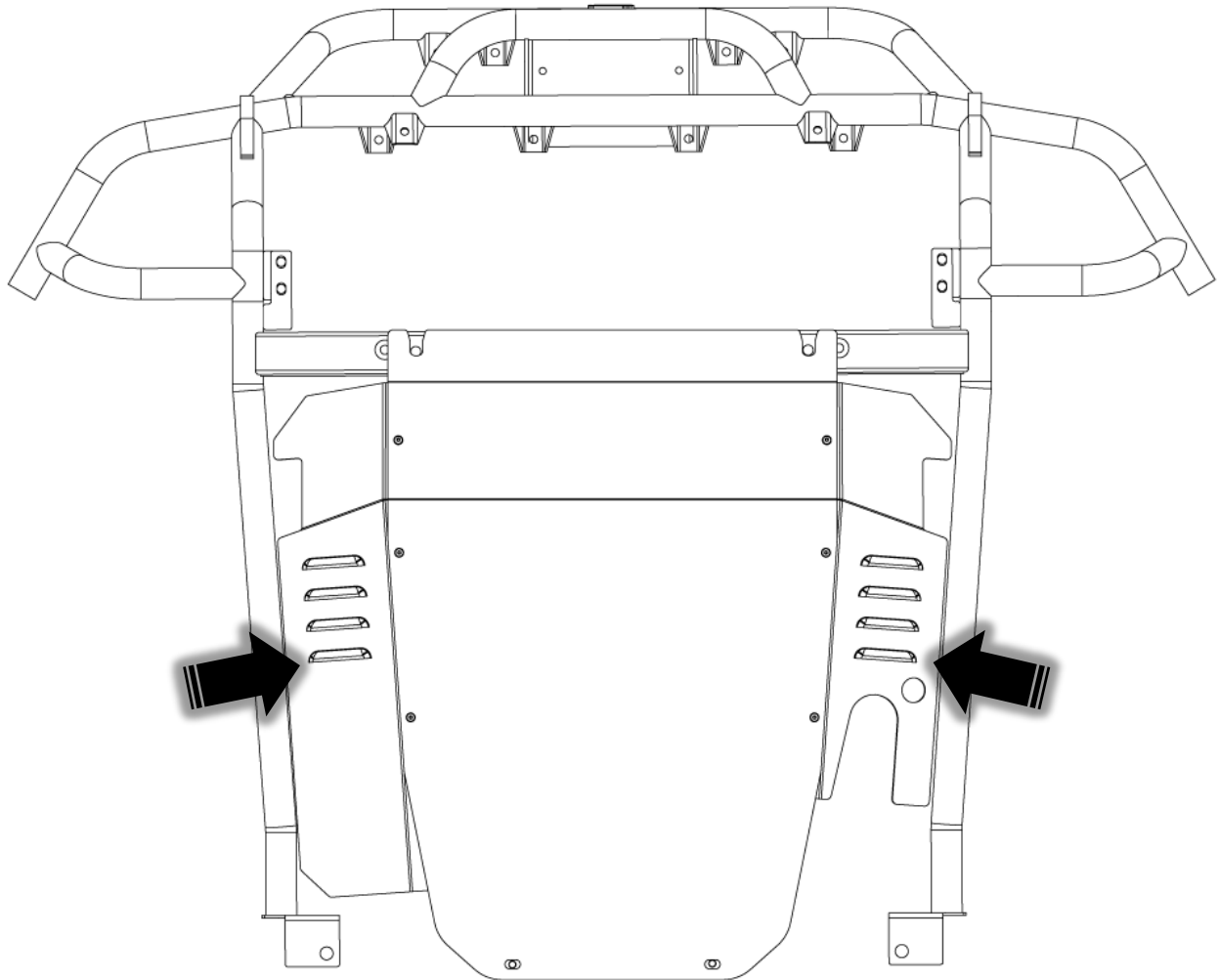



4. Install the included M5 screws and washers. Torque to **4 ft-lbs (48 in-lbs)**.

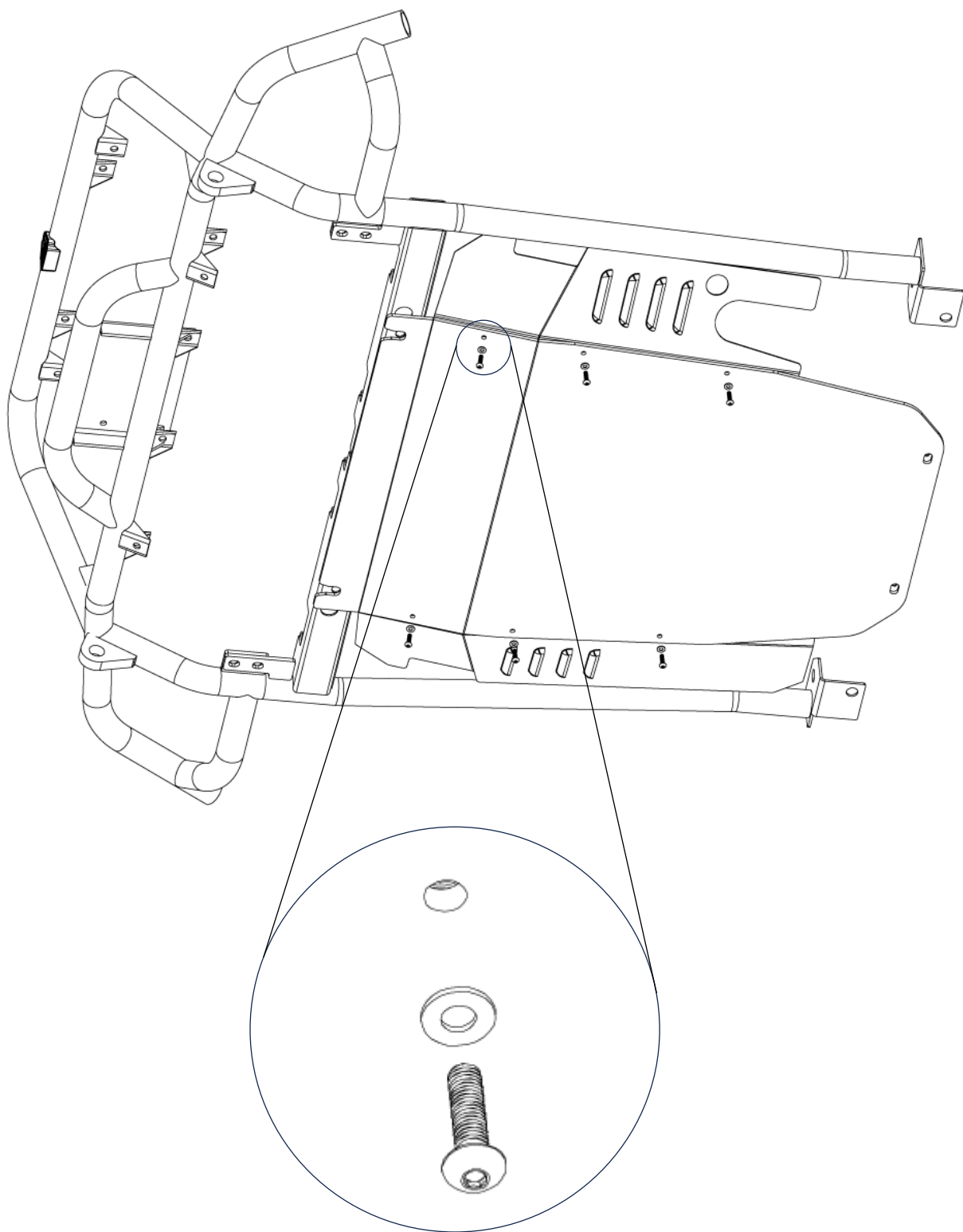



5. You finished with the installation.





Left intentionally blank.



Left intentionally blank.



advanced FLOW engineering, inc.