

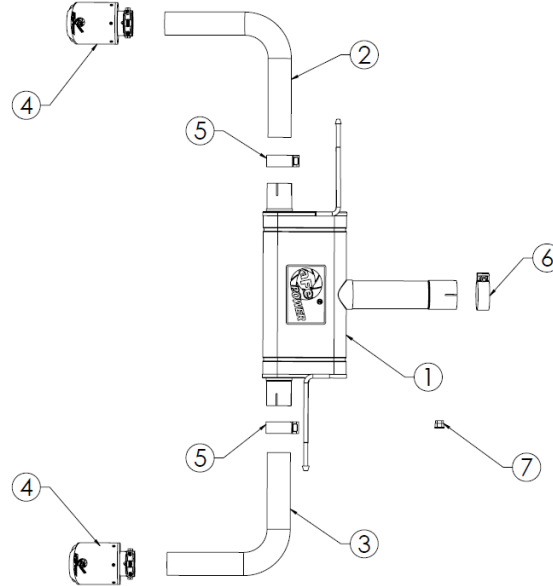

INSTALLATION INSTRUCTIONS

MAKE: BMW
MODEL: 228i Gran Coupe
YEAR: 2021-2024
ENGINE: L4-2.0L(t)

Axle-Back Exhaust
49-36355-B (Black Tip)
49-36355-P (polished Tip)
49-36355-C (Carbon Tip)



Item	Description	Part Number	Quantity
1	Muffler Assy	05-245626	1
2	Tailpipe Drivers side	05-245627	1
3	Tailpipe Passenger side	05-245628	1
	EXH Tip 2-1/2 In x 4-1/2 Out x 7L Bolt-On Blk	49T25454-B071	2
4	EXH Tip 2-1/2 In x 4-1/2 Out x 7L Bolt-On Pol	49T25454-P071	2
	EXH Tip 2-1/2 In x 4-1/2 Out x 7L Bolt-On CF	49T25454-C07	2
5	Clamp, Band: 2 1/2"	05-41061	2
6	Clamp, Band: 3"	05-41055	1
7	Cap, Wire Harness (BMW)	05-46600	1

aFe POWER recommends professional installation on this product. Thoroughly inspect the aFe POWER exhaust system to make sure there is no damage from shipping (if damage is noted, immediately contact aFe POWER customer service). Allow time for your vehicle to cool down prior to installation. When working on your vehicle proceed with caution. Wear protective safety equipment; eye goggles and gloves to ensure a safe installation.

Install band clamps to proper torque specifications of 40-45 ft-lb.





INSTALLATION INSTRUCTIONS

MAKE: BMW
MODEL: 228i Gran Coupe
YEAR: 2021-2024
ENGINE: L4-2.0L(t)

Axle-Back Exhaust
49-36355-B (Black Tip)
49-36355-P (polished Tip)
49-36355-C (Carbon Tip)

1. **(Read instructions prior to installation.)** It is recommended to not fully tighten the exhaust until it has been fully installed. Leave loose for adjustability.
2. Secure vehicle on jack stands (refer to your manual for specified jack stand positions).
3. For faster installation, spread out the parts of the exhaust alongside your vehicle as shown in the diagram above.
4. Secure the stock exhaust with jack/stands.
5. Unplug the connector at the exhaust valves and use the cable ties and the Wire harness cap provided in the hardware kit to secure the Passenger side exhaust valve harness out of the way. (Make sure it is clear of the exhaust).
6. Cut the Front Pipe 8" from the very rear cross member (See Images below).



7. Un-Bolt both Rubber Hanger Mounts for easier removal of O.E. exhaust. Retain Mounts and bolts. Remove the O.E. Exhaust from the Car.
8. Install aFe Power Muffler Assy with provided 3" band clamps. Reinstall all Rubber hangers mount back on to aFe Power Muffler Assy.
9. Install aFe Power Driver's side Tailpipe with provided 2.5" band clamps.
10. Install aFe Power Passenger's side Tailpipe with provided 2.5" band clamps.
11. Then, install tips, Line up exhaust tips so they are flat and square to each other.
12. Ensure that all the components of the aFe POWER exhaust system are aligned and are at a safe clearance from all wires, hoses, brake lines, body parts, and tires.
13. Start from the front of the aFe exhaust system and evenly tighten all clamps and fasteners.
14. Start the vehicle and check for any leaks. If any leaks are found, determine cause and repair as necessary.
15. Remove vehicle from jacks stands.
16. It is recommended to re-tighten all clamps and hardware after 50-100 miles.