



INSTALLATION GUIDE



HONDA ACCORD (10th & 11th GEN)

REAR APPLICATION

Kit 76508

For maximum effectiveness and safety, please read these instructions completely before proceeding with installation.

Failure to read these instructions can result in an incorrect installation which could result in damage to the vehicle, minor to severe personal injury or death.

Protect your Air Lift Performance Purchase by Completing your Warranty Registration

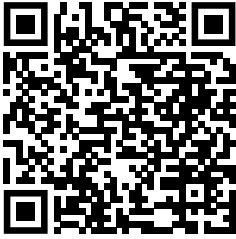

Thank you for purchasing an Air Lift Performance product!

Take a photo of your sales receipt and then scan the
QR code to complete your online warranty registration.

TABLE OF CONTENTS

P.02

Introduction

Notation Explanation

P.03

System Overview

P.04

Install the System

Important Safety Notices

Section 1. Prepare the Vehicle

Section 2. Stock Suspension Removal

Section 3. Install the Kit Components

Section 4. Route the Air Lines

P.10

Before Operating

Set the Ride Height

Torque Specifications

Suggested Driving Air Pressure

Maximum Air Pressure

Check for Binding

Installation Checklist

Damping Adjustment

P.12

Limited Warranty and Return Policy

Introduction

Air Lift Performance thanks you for purchasing the most complete, fully engineered high-performance air suspension made for the Honda Accord (10th & 11th Gen). Read these installation instructions to correctly and safely set up the vehicle for a #lifeonair.

Air Lift assumes that the installer has the mechanical knowledge and ability to work on vehicle suspension systems and has basic tools necessary to complete a suspension replacement project. Special tools needed to complete the installation are noted on the System Overview page.

Air Lift reserves the right to make changes and improvements to its products and publications at any time. For the latest version of this manual, contact Air Lift Performance at **(800) 248-0892** or visit **www.airliftperformance.com**.

An Air Lift Performance air management system is highly recommended for this product. Learn more at **air-lift.co/productlines**.

NOTATION EXPLANATION

Hazard notations appear in various locations in this publication. Information highlighted by one of these notations must be observed to help minimize risk of personal injury or possible improper installation, which may render the vehicle unsafe. Notes are used to help emphasize areas of procedural importance and provide helpful suggestions. The following definitions explain the use of these notations as they appear throughout this guide.



DANGER

INDICATES IMMEDIATE HAZARDS WHICH WILL RESULT IN SEVERE PERSONAL INJURY OR DEATH.



WARNING

INDICATES HAZARDS OR UNSAFE PRACTICES WHICH COULD RESULT IN SEVERE PERSONAL INJURY OR DEATH.



CAUTION

INDICATES HAZARDS OR UNSAFE PRACTICES WHICH COULD RESULT IN DAMAGE TO THE VEHICLE OR MINOR PERSONAL INJURY.



NOTE

Used to help emphasize areas of procedural importance and provide helpful suggestions.



TECH TIP

Used to provide helpful tips to ease the installation process.

System Overview

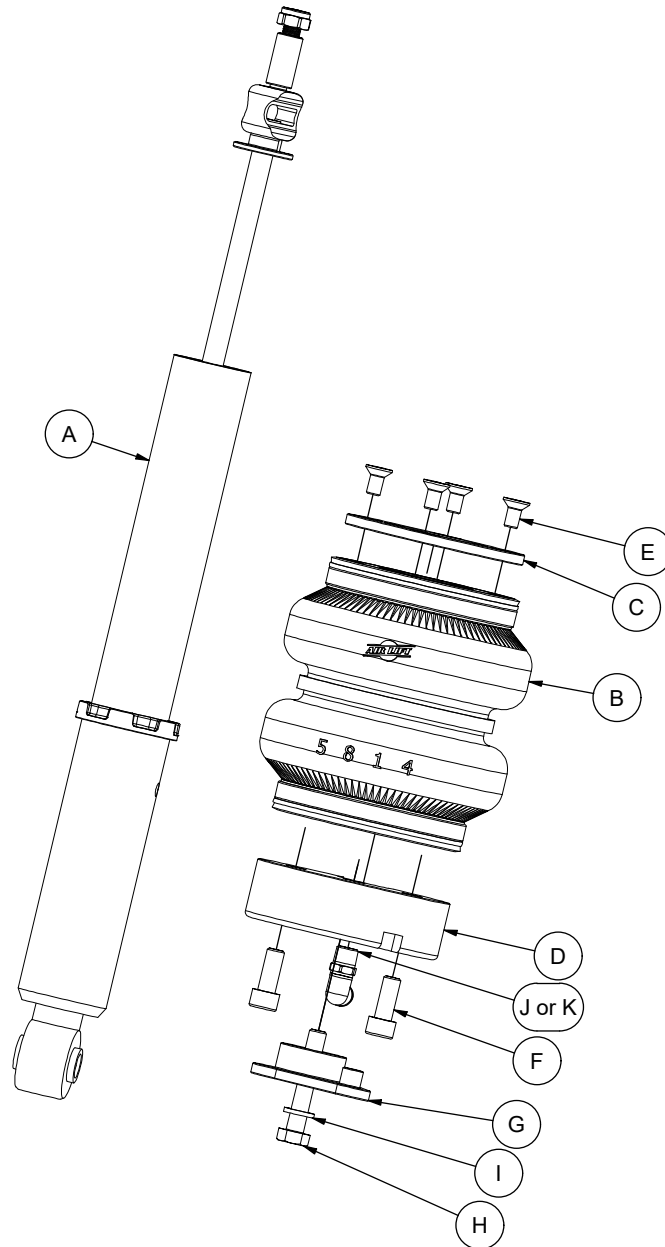

Fig. 1

HARDWARE CONTENT

Item	Part #	Description	Qty
A	39133	SHOCK, 10TH ACCORD, REAR	2
B	58555	AIR SPRING, 2B6 RECD 25 - METRIC	2
C	13326	SPACER, 10TH GEN ACCORD, UPPER	2
D	03050	BRACKET, 10TH GEN ACCORD, LOWER	2
E	17929	M8-1.25 X 16 FLAT-HEAD SOCKET CAP SCREW	8
F	17516	M10-1.5 X 25 SOCKET-HEAD CAP SCREW	4

Item	Part #	Description	Qty
G	13327	CENTERING SPACER, 10TH GEN ACCORD	2
H	17930	M10 X 1.5 X 60 HEX CAP SCREW	2
I	18628	M10, SPLIT LOCK WASHER	2
J	21779	1/4" MNPT X 1/4" PTC ELBOW FITTING - DOT	2
K	21851	1/4" MNPT X 3/8" PTC ELBOW FITTING - DOT	2



Missing or damaged parts? Call Air Lift customer service at (800) 248-0892 for a replacement part.

Install the System



NOTES

See important safety notices on page 2.

SECTION 1. PREPARE THE VEHICLE

1. Elevate and support the vehicle with a hoist or safety stands.
2. Remove the rear wheel and support the lower control arm with a jack. (Figs. 2 & 3)



Fig. 2



Fig. 3

SECTION 2. STOCK SUSPENSION REMOVAL

1. Remove the sway bar end link bolt. (Figs. 4 & 5)



Fig. 4



Fig. 5

2. Remove the lower control arm outer pivot bolt. (Figs. 6 & 7)

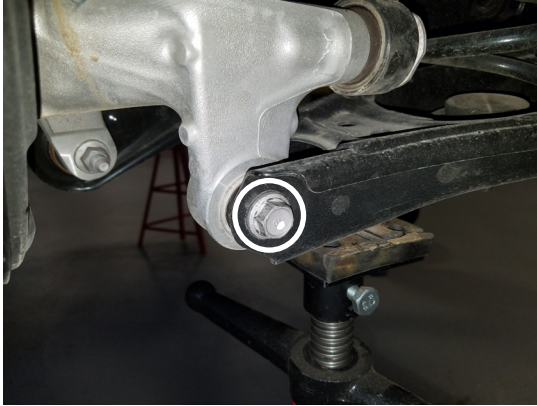

Fig. 6



Fig. 7

3. Loosen the lower control arm inner pivot bolt, but do not remove. (Fig. 8)



Fig. 8

4. Lower the jack under the control arm to release the coil spring. Remove the coil spring from the vehicle. (Figs. 9 & 10)



Fig. 9



Fig. 10

5. Raise the control arm and reinstall the lower control arm outer pivot and sway bar end link bolts. Do not torque at this time. (Fig. 11)

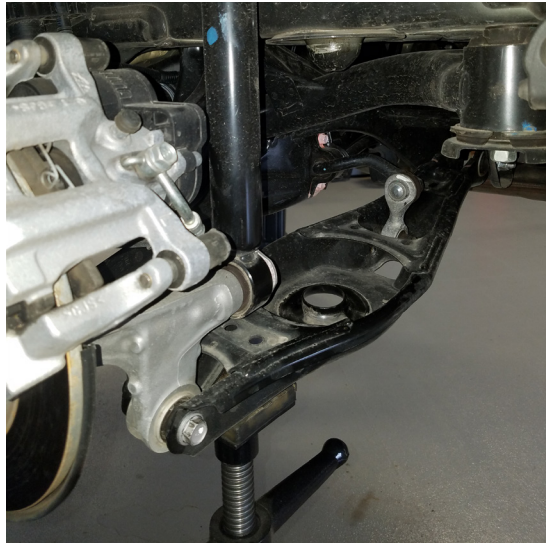

Fig. 11

6. Remove the lower shock mount bolt. (Figs. 12 & 13)



Fig. 12



Fig. 13

7. Remove the upper shock mount bolts. Remove the shock from the vehicle. (Figs. 14 & 15)



Fig. 14



Fig. 15

SECTION 3. INSTALL THE KIT COMPONENTS



PLEASE READ - IMPORTANT INSTALLATION INFORMATION



FOR COIL TO AIR UPGRADE KIT INSTALLATIONS ONLY: Please refer to the included Coil to Air Upgrade Kit installation guide (MN-2000) for details on how to disassemble the coilovers and assemble the air springs.

Also refer to your control system installation guide to ensure the installation of your air suspension system is complete.



NOTES

All dampers come pre-set to even lengths, and locking collars are pre-tightened. It is always recommended to double-check that the dampers are the same length side to side, and the locking collars are tight.

Please refer to the User Guide included with the kit for any suspension setup adjustments.

1. Remove the upper mount/jounce bumper from the stock rear shock (Fig. 16). Separate the jounce bumper from the upper mount. (Fig. 17)



Fig. 16



Fig. 17

2. Install the stock upper shock mount on the Air Lift Performance rear shock. Torque the pin mount nut to 30Nm (22 lb.-ft.). (Figs. 18 & 19)



Fig. 18



Fig. 19

3. Insert the rear shock upper mount into the chassis and install the bolts. Torque the bolts to 40Nm (30 lb.-ft.). Install the lower mount and bolt. Torque the lower mount bolt to 78Nm (58 lb.-ft.) (Figs. 20 & 21)

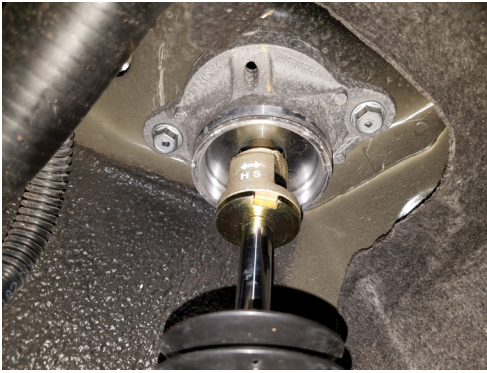

Fig. 20

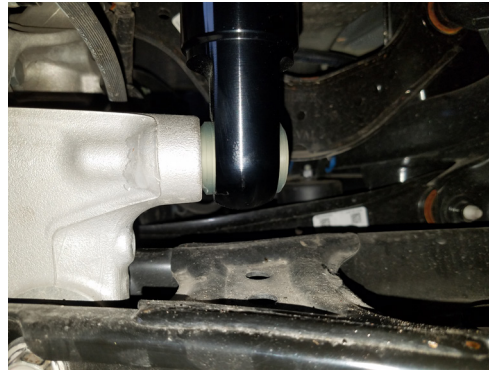

Fig. 21

4. Install the fitting (J or K) into the rear air spring. Tighten the fitting to 1 3/4 turns beyond hand tight. Use two bolts (F) to attach the lower bracket (D) to the air spring. Torque the bolts to 28Nm (20 lb.-ft.) (Figs. 22 & 23)



Fig. 22



Fig. 23

5. Before installing the air spring, route the air line through the lower control arm. Insert the air line into the fitting before installing the air spring. Install the air spring into the lower control arm with the fitting facing inboard of the control arm. Align the notch in the lower bracket with the hole in the control arm. (Figs. 24 & 25)



Fig. 24



Fig. 25

6. Install centering spacer (G) with M10 bolt (H) and split lock washer (I) through the bottom of the lower control arm. Torque the bolt to 40Nm (30 lb.-ft.) (Figs. 26 & 27)



Fig. 26



Fig. 27

SECTION 4. ROUTE THE AIR LINES



WARNING

AFTER INSTALLATION, ENSURE ALL ORIGINAL EQUIPMENT VEHICLE SAFETY FEATURES ARE PROPERLY CALIBRATED BY A QUALIFIED TECHNICIAN. CHANGING VEHICLE HEIGHT MAY AFFECT FUNCTIONING OF SAFETY SENSORS AND CAMERAS.

1. Fully compress the suspension using a jack. With the suspension compressed, review the best routing for the air line that is clear of all suspension components and axle.
2. Routing should allow for the suspension to extend and steer without kinking, pulling the line tight or rubbing on other components. Following the brake line routing is often a good place to start. Check clearances to all other components.



PLEASE READ - IMPORTANT INSTALLATION INFORMATION

Please refer to your control system installation guide for more details on air line routing and to ensure the installation of your air suspension system is complete.

Before Operating

SET THE RIDE HEIGHT

1. Refer to the User Guide supplied with this kit to set up the suspension.

Torque Specifications		
Location	Nm	lb.-ft.
Upper shock pin mount nut	30	22
Lower bracket to air spring bolts	28	20
Lower shock mount bolt	78	58
Upper shock mount bolts	40	30
Sway bar end link bolt	40	30
Lower control arm inner pivot bolt	93	63
Lower control arm outer pivot bolt	69	51
Upper control arm inner pivot bolt	80	59
Upper control arm outer pivot bolt	76	56
Centering spacer bolt	40	30
Lugnuts	108	80
Fitting elbow PTC	1 3/4 turns beyond hand-tight	

2. Upon successful completion of the installation, follow these pressure requirements for the air springs.



Suggested Driving Air Pressure



Maximum Air Pressure



CAUTION

FAILURE TO MAINTAIN ADEQUATE MINIMUM PRESSURE (OR PRESSURE PROPORTIONAL TO LOAD) MAY RESULT IN EXCESSIVE BOTTOMING OUT AND **WILL VOID THE WARRANTY.**

CHECK FOR BINDING



CAUTION

MAKE SURE THE REAR WHEELS ARE STRAIGHT WHEN DEFLATING AND REINFLATING AIR SPRINGS.

1. Inflate and deflate the system (do not exceed 8.6BAR [125 PSI]) to check for clearance or binding issues. With the air springs deflated, check clearances on everything so as not to pinch brake lines, vent tubes, etc. Clear lines if necessary.
2. Inflate the air springs to 5.2-6.2BAR (75-90 PSI) and check all connections for leaks.

INSTALLATION CHECKLIST

- ☐ **Clearance** – Inflate the air springs to 5.2-6.2BAR (75-90 PSI) and make sure there is at least 13mm (1/2") clearance from anything that might rub against the air spring. This should be checked with the air spring fully inflated and fully deflated.
- ☐ **Leak** – Inflate the air springs to 5.2-6.2BAR (75-90 PSI) and check all connections for leaks. All leaks must be eliminated before the vehicle is road-tested.
- ☐ **Heat** – Be sure there is sufficient clearance from heat sources, at least 152mm (6") from air springs and air lines. If a heat shield was included in the kit, install it. If there is no heat shield, but one is required, call Air Lift customer service at **(800) 248-0892**.
- ☐ **Fastener** – Recheck all bolts for proper torque.
- ☐ **Road** – Inflate the air springs to recommended driving pressures (see previous page). Drive the vehicle 16km (10 miles) and recheck for clearance, loose fasteners, and air leaks.
- ☐ **Operating instructions** – If professionally installed, the installer should review the operating instructions with the owner. Be sure to provide the owner with all paperwork that came with the kit.

DAMPING ADJUSTMENT

1. The dampers in this kit have 32 settings, or “clicks,” of adjustable compression and rebound damping characteristics. Damping is changed through the damper rod using the supplied adjuster (example shown here) or a 3mm hex key (not included).
2. Turn the adjuster clockwise (H), and the damping settings are hardened, reducing oscillations and body motion. Turn the adjuster counterclockwise (S), and the damping is softened.
3. Each damper will need to be set after installation and your initial drive, as they are not pre-set. It may take multiple adjustments to dial in your ideal ride. A good starting point is in the middle at 16 clicks from full soft, then drive the vehicle and make adjustments either softer or stiffer.

For more information, refer to the user guide.

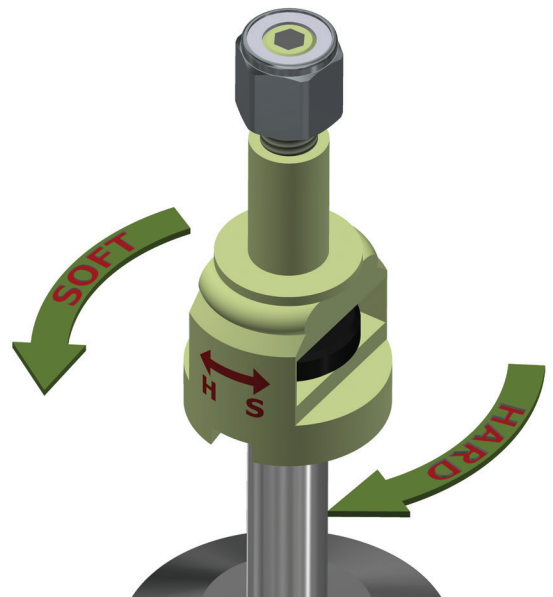

Limited Warranty and Return Policy

Air Lift Company provides a limited warranty* to the original purchaser of Air Lift Performance Air Suspension kits from the date of original purchase, that the products will be free from defects in workmanship and materials when used on cars and trucks as specified by Air Lift Company and under normal operating conditions, subject to the requirements and exclusions set forth in the full Limited Warranty and Return Policy.

* Full Limited Warranty and Return Policy are available at www.airliftperformance.com/warranty and are subject to change.

WARRANTY REGISTRATION & CLAIMS

- To register your warranty, please visit <https://www.airliftperformance.com/support/warranty-registration/>
- To submit a warranty claim, please visit <https://www.airliftperformance.com/support/submit-warranty-claim/>

Thank you for purchasing Air Lift Performance products!

Need Help?

Contact Air Lift Company Customer Service at (800) 248-0892 or +1 (517) 322-2144 for calls from outside the U.S. and Canada.



Connect by searching for **Air Lift Performance** #LifeonAir

AIR LIFT
PERFORMANCE

2727 Snow Road Lansing, MI 48917 or P.O. Box 80167 Lansing, MI 48908-0167
Toll Free (800) 248-0892 • Local (517) 322-2144 • Fax (517) 322-0240
www.airliftperformance.com



**MADE IN USA
WITH GLOBAL
COMPONENTS**

Air Lift Company reserves the right to make changes and improvements to its products and publications at any time. For the latest version of this manual, contact Air Lift Company at (800) 248-0892 or visit airliftperformance.com.