



INSTALLATION INSTRUCTIONS

Not legal for sale or use in California on any pollution controlled motor vehicle.

70-9039 TOYOTA 2016-23 TACOMA V6-3.5L

NOTE: This kit was not designed to fit vehicles with a body lift.

TOOLS NEEDED:

- Ratchet
- Extension
- 10mm Socket
- 12mm Socket
- 13/16 Wrench
- Flat Blade Screwdriver
- Phillips Screwdriver
- 3mm Allen Key
- 4mm Allen Key
- 5/16" Socket / Nut Driver

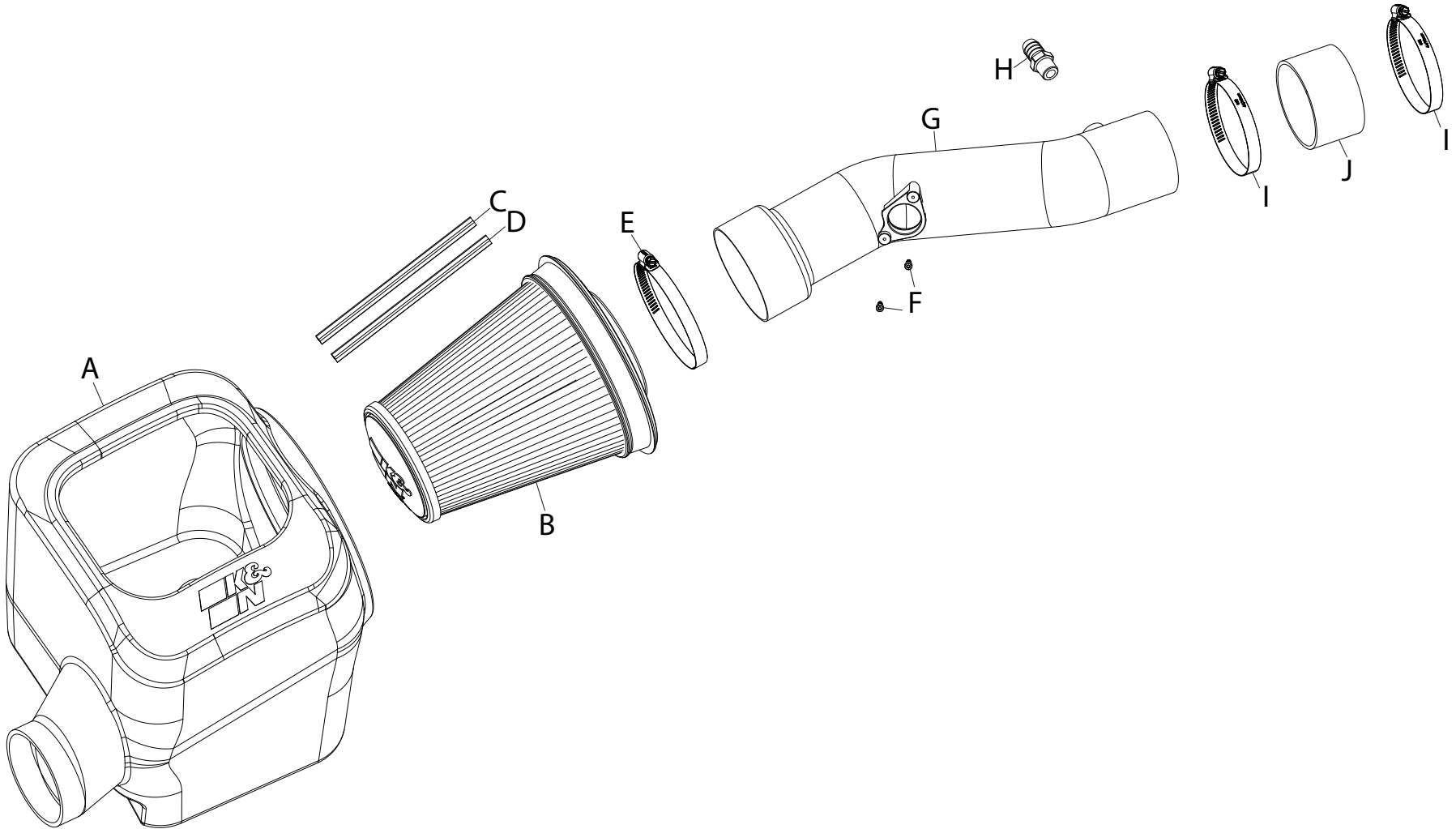

PARTS LIST:

Description	Qty.	Part #	Description	Qty.	Part #	Description	Qty.	Part #
A AIRBOX; XLHDPE	1	087618A	D CLIP; SNAP-ON, RED	1	088220	G TUBE; 3.25"OD X 17"L, ALUM.	1	27689C
B AIR FILTER	1	RU-5341	E HOSE CLAMP; #72, BLK	1	08671KA	H FITTING; 5/8" BARB TO 3/8"NPT	1	82635
C CLIP; SNAP-ON, ORANGE	1	088221	F BOLT; M4.-7 X 8MM, ALNHD	2	07733	I HOSE CLAMP; #52 BLK	2	08610KA
						J HOSE; 3.25"ID X 2"L BLK	1	5-326

If you need any assistance please call 1-800-858-3333 to speak with a representative in our Customer Service Center before returning the product.

NOTE: FAILURE TO FOLLOW INSTALLATION INSTRUCTIONS AND NOT USING THE PROVIDED HARDWARE MAY DAMAGE THE INTAKE TUBE, THROTTLE BODY AND ENGINE.

TO START:

1. Turn off the ignition and disconnect the negative battery cable.
NOTE: Disconnecting the negative battery cable erases pre-programmed electronic memories. Write down all memory settings before disconnecting the negative battery cable. Some radios will require an anti-theft code to be entered after the battery is reconnected. The anti-theft code is typically supplied with your owner's manual. In the event your vehicles anti-theft code cannot be recovered, contact an authorized dealership to obtain your vehicles anti-theft code.



2. Lift up the engine cover to dislodge it from the mounting studs and then remove it from the vehicle.



3. Release the spring clamp and disconnect the crank case vent hose from the factory intake tube.



4. Loosen the hose clamp securing the factory intake tube to the throttle body.



5. Disconnect the MAF sensor electrical connection and unhook the harness from the air filter housing.



6. Release the two clips securing the upper air filter housing and then remove the intake tube and air filter hosing along with the factory air filter.



7. Remove the three bolts securing the lower air filter housing to the inner fender and then remove the lower air filter housing from the vehicle.
NOTE: K&N Engineering, Inc., recommends that customers do not discard factory air intake.



8. Install the K&N airbox into the vehicle and secure using the original three bolts removed from OEM airbox. Secure and tighten.



8. Install the K&N airbox into the vehicle and secure using the original three bolts removed from OEM airbox. Secure and tighten.



9. Attach the filter clips to the pleats on the air filter align and push down. Passenger side filters, place orange clip on top and red on bottom.



10. Install the air filter into the airbox.



11. Install the provided 5/8" barb fitting into the K&N intake tube.
NOTE: The quick connect fitting utilizes 3/8npt threads, thread the fitting in by hand and then tighten one revolution.



12. Remove the mass air sensor from the factory housing and install it into the K&N adapter using the provided hardware.



13. Slide hose with clamps on to the intake tube pass the bead like image shown
Note: Do not over tighten clamps.



14. Install the intake tube assembly and position to air filter and throttle body.



15. Now slide the hose onto the throttle body. adjust and rotate if necessary, and tighten all clamps.
Note: Do not over tighten clamps.



16. Connect the crank case vent hose to the barb fitting and secure using original spring clamp. Re-connect MAF sensor harness.



17. Install the provided K&N decal to the intake tube at desired position.



17. Reconnect the vehicle's negative battery cable. Double check to make sure everything is tight and properly positioned before starting the vehicle.

18. **K&N AIR FILTER MONITOR LIGHT:** Some vehicles are equipped with a "Air Filter Monitor" system that will send a message to the instrument cluster indicating that the air filter needs to be replaced. This system is calibrated for the OEM intake system and air filter and will not be accurate when K&N products are in use. Always refer to WWW.KNFILTERS.COM for K&N air filter service procedures. The "Air Filter Monitor" system must be disabled to prevent the monitor from setting on and causing a factory dealership visit to reset the system. Follow the "Air Filter Monitor" system procedure listed in the factory owners manual.

19. It will be necessary for all K&N® high flow intake systems to be checked periodically for realignment, clearance and tightening of all connections. Failure to follow the above instructions or proper maintenance may void warranty.

ROAD TESTING:

1. Start the engine with the transmission in neutral or park, and the parking brake engaged. Listen for air leaks or odd noises. For air leaks secure hoses and connections. For odd noises, find cause and repair before proceeding. This kit will function identically to the factory system except for being louder and much more responsive.

2. Test drive the vehicle. Listen for odd noises or rattles and fix as necessary.

3. If road test is fine, you can now enjoy the added power and performance from your kit.

4. K&N Engineering, Inc., requires cleaning the intake system's air filter element every 50,000 miles. When used in dusty or off-road environments, our filters will require cleaning more often. We recommend that you visually inspect your filter once every 25,000 miles to determine if the screen is still visible. When the screen is no longer visible some place on the filter element, it is time to clean it. To clean, purchase our Synthetic Filter Cleaner, part number 99-0624 and follow the easy instructions.