



INSTALLATION INSTRUCTIONS

Not legal for sale or use in California on any pollution controlled motor vehicle.

50-2545
DODGE
2012-2023 CHARGER
2011-2023 CHALLENGER
 EXC. SHAKER HOOD

CHRYSLER
2012-2015 300C
V8-6.4L

TOOLS NEEDED:

- Ratchet
- Extension
- 5/16" nut driver
- 8mm socket
- 10mm socket
- 3/4" wrench

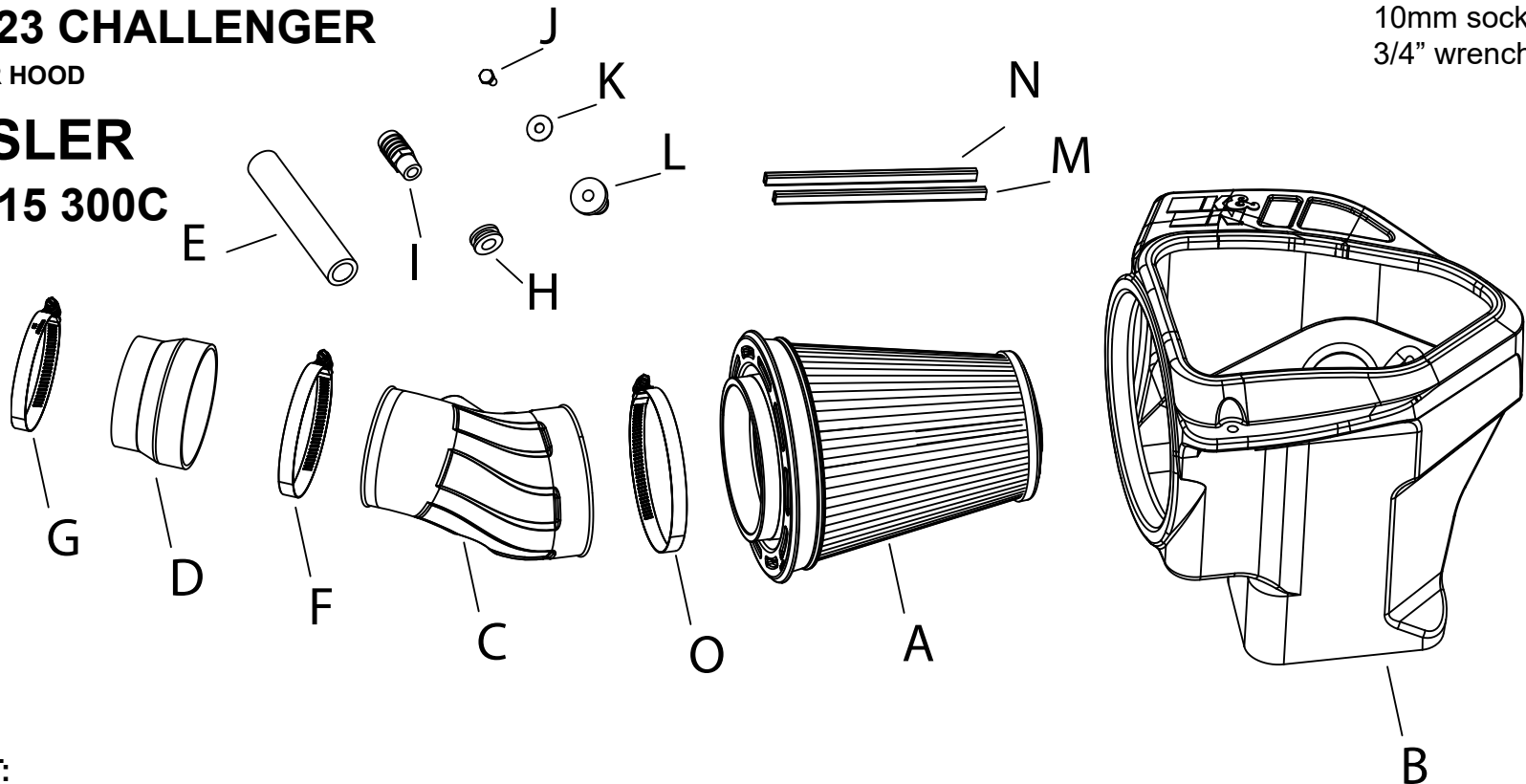

PARTS LIST:

Description	Qty.	Part #	Description	Qty.	Part #	Description	Qty.	Part #
A AIR FILTER	1	RU-5301	F HOSE CLAMP; #64	1	08645KA	K WASHER; 3/8" FLAT WASHER	1	08134
B AIRBOX	1	087620A	G HOSE CLAMP; #56	1	08620KA	L INSERT; 3/8-16 X 3/4 RUBBER	1	08163
C TUBE	1	087671	H GROMMET; 9/16"ID - 1.125"OD	1	KITGRMT02	M CLIP; SNAP-ON RED	1	088220
D REDUCER	1	KITRDCR10	I FITTING; 3/8"NPT,3/4" BARB	1	080026	N CLIP; SNAP-ON ORANGE	1	088221
E HOSE; 3/4"ID X 6"L	1	5-4006	J BOLT; 3/8"-16 X 1-1/4"L HEX	1	07779	O HOSE CLAMP, #88	1	KITHSS88K

If you need any assistance please call 1-800-858-3333 to speak with a representative in our Customer Service Center before returning the product.

NOTE: FAILURE TO FOLLOW INSTALLATION INSTRUCTIONS AND NOT USING THE PROVIDED HARDWARE MAY DAMAGE THE INTAKE TUBE, THROTTLE BODY AND ENGINE.

TO START:

1. Turn off the ignition and disconnect the negative battery cable.
NOTE: Disconnecting the negative battery cable erases pre-programmed electronic memories. Write down all memory settings before disconnecting the negative battery cable. Some radios will require an anti-theft code to be entered after the battery is reconnected. The anti-theft code is typically supplied with your owner's manual. In the event your vehicles anti-theft code cannot be recovered, contact an authorized dealership to obtain your vehicles anti-theft code.

NOTE: K&N Engineering, Inc., recommends that customers do not discard factory air intake.



2. Carefully Lift up the driver side engine cover.



4. Loosen the clamp on the throttle body. Disconnect the Temperature sensor harness.



3. Locate the rubber Crankcase line and pull away from the engine.



5. Remove the bolt holding in front of the airbox and save for later install.



6. Lift straight up and remove the complete factory intake system from the vehicle. **NOTE: K&N Engineering, Inc., recommends that customers do not discard factory air intake.**



7. Install the provided insert nut onto the K&N air filter housing using provided hardware.



8. Install the K&N air filter housing into the vehicle and secure with the factory mounting bolt from step 5. Tighten the bolt from the previous step. Make sure grommet nut is completely in fender hole.



9. Install the hose with clamps provided to the throttle body. Tighten the clamp on throttle body only. Tighten clamps using 5/16" nut driver.



10. Carefully remove the temperature sensor from the factory intake system, remove the o ring.



11. Install the grommet into the hole on K&N intake tube, install the temperature sensor and secure. Install the provided barbed fitting to the threaded insert and tighten. Plastic barb is easily broken, do not over tighten.



12. Attach the filter clips to the pleats on the air filter align and push down. Driver side filters, place the orange clip on top and the red on bottom.



13. Install the K&N air filter into the K&N air filter housing.



14. Install the intake tube assembly into the air filter and then into the hose at the throttle body, adjust the tube for best fit and then secure remaining clamps. Tighten clamps using 5/16" nut driver.



15. Install the provided Crankcase hose to the barbed fitting on tube and to the engine and secure. Re-connect the temperature sensor harness.



16. Verify and tighten, re-adjust if necessary all clamps. Tighten clamps using 5/16" nut driver.



17. Re-install the factory engine cover.



18. Reconnect the vehicle's negative battery cable. Double check to make sure everything is tight and properly positioned before starting the vehicle.

19. It will be necessary for all K&N® high flow intake systems to be checked periodically for realignment, clearance and tightening of all connections. Failure to follow the above instructions or proper maintenance may void warranty.

ROAD TESTING:

1. Start the engine with the transmission in neutral or park, and the parking brake engaged. Listen for air leaks or odd noises. For air leaks secure hoses and connections. For odd noises, find cause and repair before proceeding. This kit will function identically to the factory system except for being louder and much more responsive.

2. Test drive the vehicle. Listen for odd noises or rattles and fix as necessary.

3. If road test is fine, you can now enjoy the added power and performance from your kit.

4. K&N Engineering, Inc., requires cleaning the intake system's air filter element every 100,000 miles. When used in dusty or off-road environments, our filters will require cleaning more often. We recommend that you visually inspect your filter once every 25,000 miles to determine if the screen is still visible. When the screen is no longer visible some place on the filter element, it is time to clean it. To clean and re-oil, purchase our filter Recharger® service kit, part number 99-5050 or 99-5000 and follow the easy instructions.