

**S6026**

**07-10 CHEV/GMC 2500/3500 6.6L  
DURAMAX, PARTICULATE FILTER BACK, 4"  
SINGLE SIDE**

**MBRP**  
INC.  
**PERFORMANCE EXHAUST**

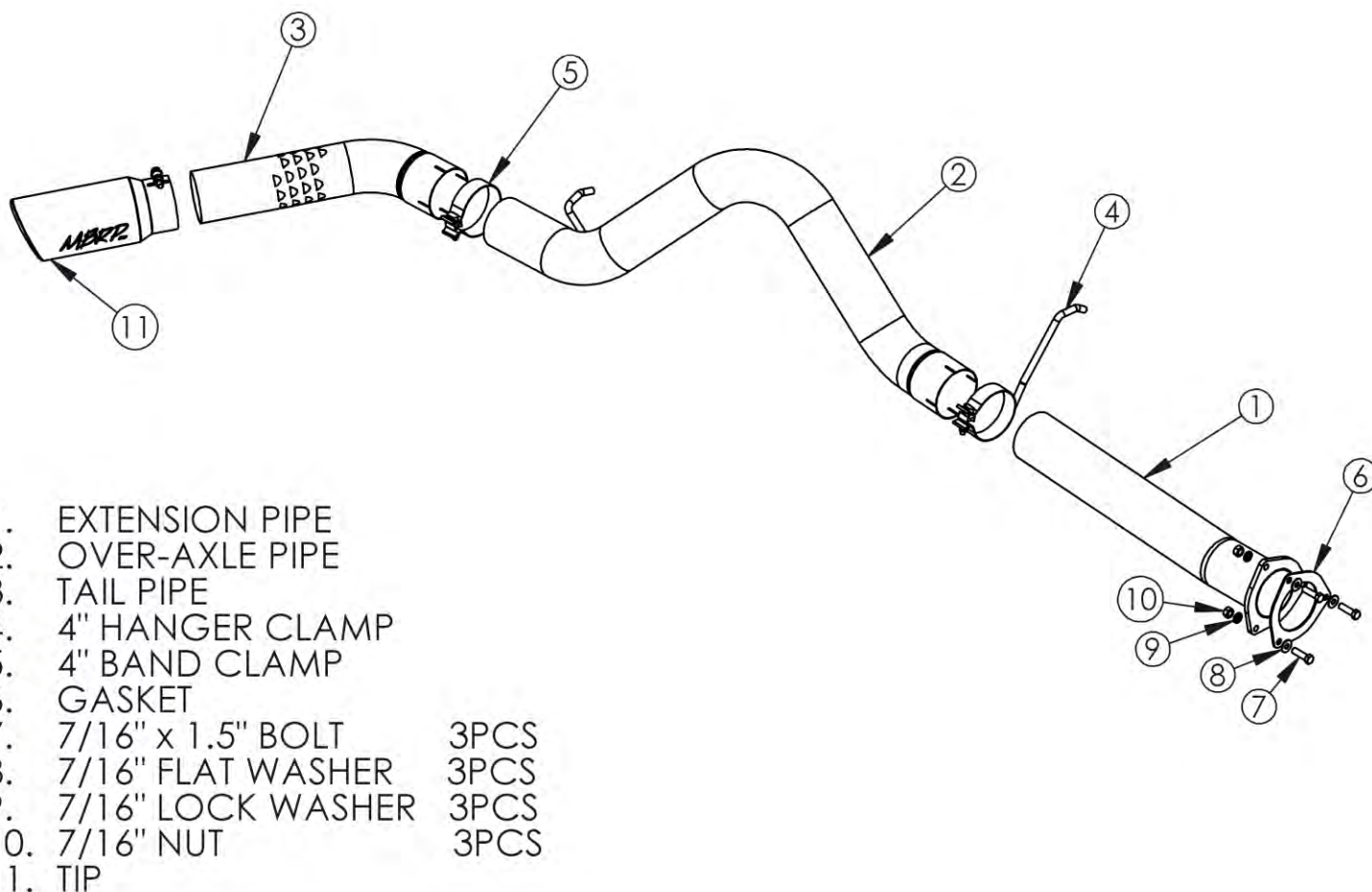

1. EXTENSION PIPE
2. OVER-AXLE PIPE
3. TAIL PIPE
4. 4" HANGER CLAMP
5. 4" BAND CLAMP
6. GASKET
7. 7/16" x 1.5" BOLT 3PCS
8. 7/16" FLAT WASHER 3PCS
9. 7/16" LOCK WASHER 3PCS
10. 7/16" NUT 3PCS
11. TIP

## **PLEASE READ BEFORE STARTING INSTALATION**

**While MBRP Inc. has made every effort to ensure that all components of this system are of superior quality and properly packaged, it is the installer's responsibility to ensure the following before removal of the factory exhaust:**

- that ALL components shown above are present.
- that ALL mating components fit together.
- that there are no damaged components.
- that the system you have purchased is appropriate for your vehicle year, model and configuration.
- that the system will not interfere with any modifications previously installed or planned.
- that you have read and understand these instructions.

If you have any questions or are uncertain about any aspect of the installation of this system to your vehicle please contact your dealer before commencing installation.

**Removal of stock system:**



**Figure 1**

1. Apply a penetrating lubricant liberally to all exhaust fasteners, hangers and rubber isolators.



**Figure 2**

2. Remove the factory tail pipe assembly from the factory rubber isolators.

**Refer to Figures 1 and 2.**



**Figure 3**

3. Cut the factory tail pipe as shown and remove the rear section.

**Refer to Figure 3.**



**Figure 4**

4. Remove the three nuts at the muffler inlet flange and remove the muffler.

**Refer to Figure 4.**



**Figure 5**



**Figure 6**



**Figure 7**



**Figure 8**

## Installation of MBRP Inc. Performance Exhaust

1. Install the three supplied **7/16" Bolts** in the existing flange and place the supplied **Gasket** over the bolts.

Refer to Figure 5.

2. Install the **Extension Pipe** onto the flange. There is a slight bend in the **Extension Pipe**. The inside of this bend must face the driveshaft. If the outlet of the **Extension Pipe** angles slightly towards the driveshaft you have installed it correctly. Failure to install this pipe correctly will result in the **Tail Pipe** not fitting properly. Secure with the three supplied **7/16" Flat Washers**, three **7/16" Lock Washers** and three **7/16" Nuts**. Refer to Figure 6.

3. Slide the **4" Band Hanger Clamp** over the outlet of the **Extension Pipe**. Install the **Over-Axle Pipe** from the rear of the truck over the axle and slide on to the **Extension Pipe**. Install the **4" Band Hanger Clamp** hanger into the factory rubber isolators.

4. Slide the **4" Band Clamp** over the outlet of the **Over-Axle Pipe**. Install the **Tail Pipe**. Install the **Tail Pipe** hanger into the factory rubber isolators. Refer to Figures 7 and 8.

5. Loosely install the supplied **Tip** and align the **Tail Pipe** approximately horizontal as viewed from the rear of the truck. Once the system is aligned, tighten all clamps and secure the **Tip** by tightening the bolt.

6. Check along the whole length of the exhaust system to ensure that there is adequate clearance around the spare tire, fuel and brake lines or any wiring. If any interference is detected relocate or adjust.





**Congratulations!** You are ready to begin experiencing the improved power, sound and driving experience of your MBRP Inc. performance exhaust system. We hope you enjoy your purchase.