

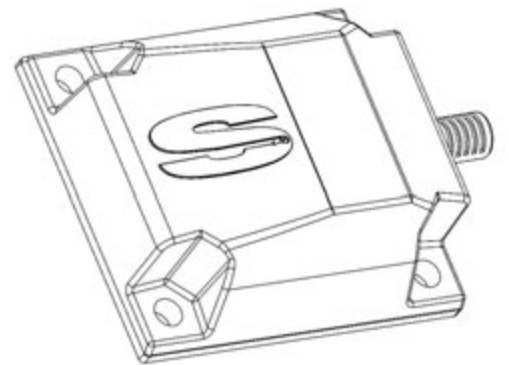

## Wireless Remote kit



PART NUMBER: 2277



SAVE THESE  
INSTRUCTIONS

# CONTENTS

ITEM	QUANTITY	DESCRIPTION
1	1	RECEIVER
2	1	REMOTE
3	4	M6 SERRATED FLANGE NUT
4	4	M6 BUTTON HEAD BOLT
5	4	M6 SPLIT LOCK WASHER
6	4	M6 FLAT WASHER
7	1	GROMMET
ANTI-SEIZE LUBRICANT MUST BE USED ON ALL STAINLESS STEEL FASTENERS TO PREVENT THREAD DAMAGE AND GALLING		

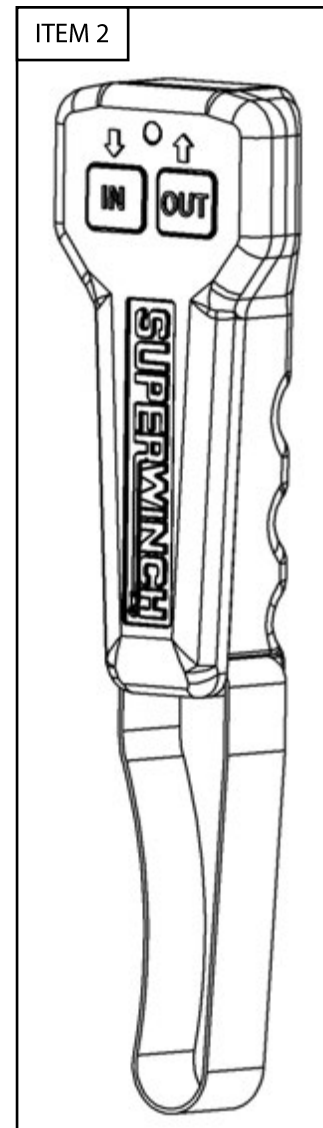
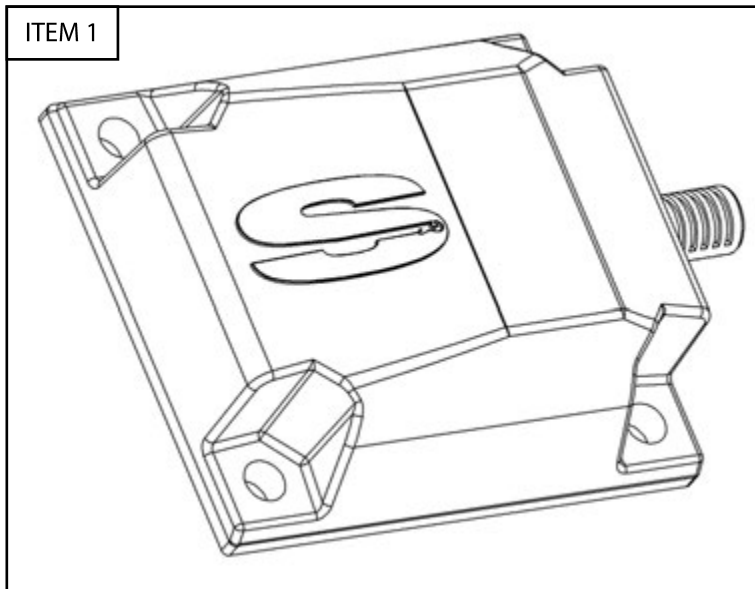

# INSTALLATION INSTRUCTIONS

1. Remove contents from box, verify if all parts listed are present and free from damage. **Failure to identify damage before installation could lead to a rejection of any claim.**
2. Carefully read and understand all instructions before attempting installation. **Caution! Handling +12V systems without professional experience may occur in electrical shock or damage to the winch. Professional experience is highly recommended.**
3. Start with disconnecting the winch from any power source before installation.
4. Remove the control box cover on your winch to gain access to the contactor. Every control box is different, but generally there are 4 screws on the base that hold the cover on.
5. Drill hole in the side of the control box for wiring to run through.
6. Install the grommet.
7. Run receiver wiring through the grommet into the control box.
8. There are 4 wires to connect (See Figure 1) **NOTE: Remove wires one at a time to keep track of correct orientation.**
  - Red wire connects to the +12V stud connection on the contactor.
  - Black wire connects to ground on contactor (generally center connector)
  - Blue and white connect to the outside connectors on the contactor. These may have to be swapped to engage the correct direction on the winch as shown on the remote. Test by reconnecting and clicking the remote in a direction. Ensure the direction matches.
9. Reconnect connection for the wired remote to the piggyback terminals.

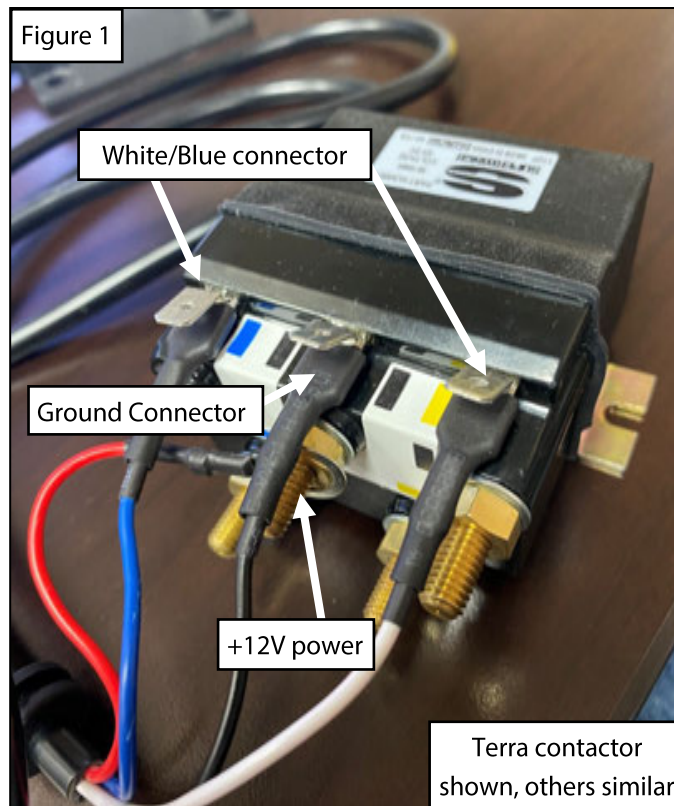

6. After ensuring connections are correct and functioning, re-install the control box cover and route wiring accordingly.
7. Find a desired location to mount the receiver. Using supplied M6 hardware, mount the receiver to the desired location. See **Figure 2**.

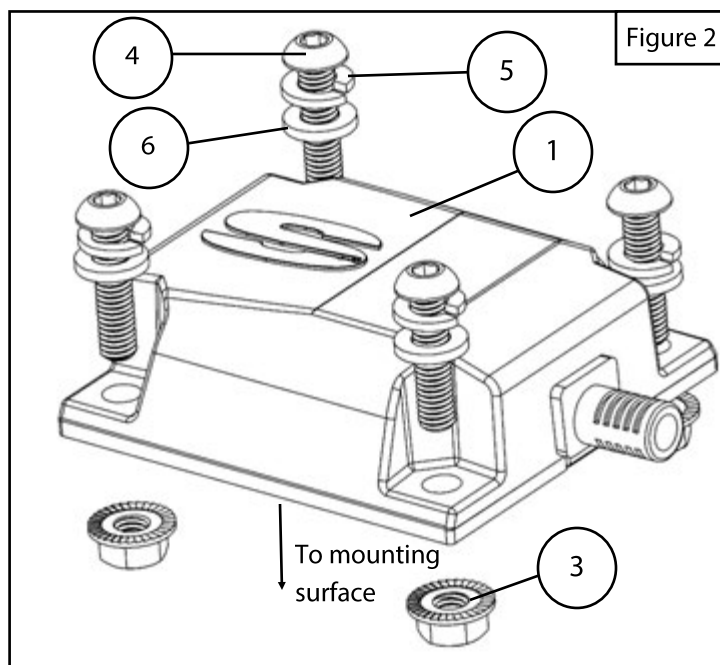

8. Torque M6 hardware to 5-7 ft-lbs. Re-connect 12V power to the winch.
9. Installation is now complete.

# REMOTE FEATURES + OPERATION

## Wireless Remote

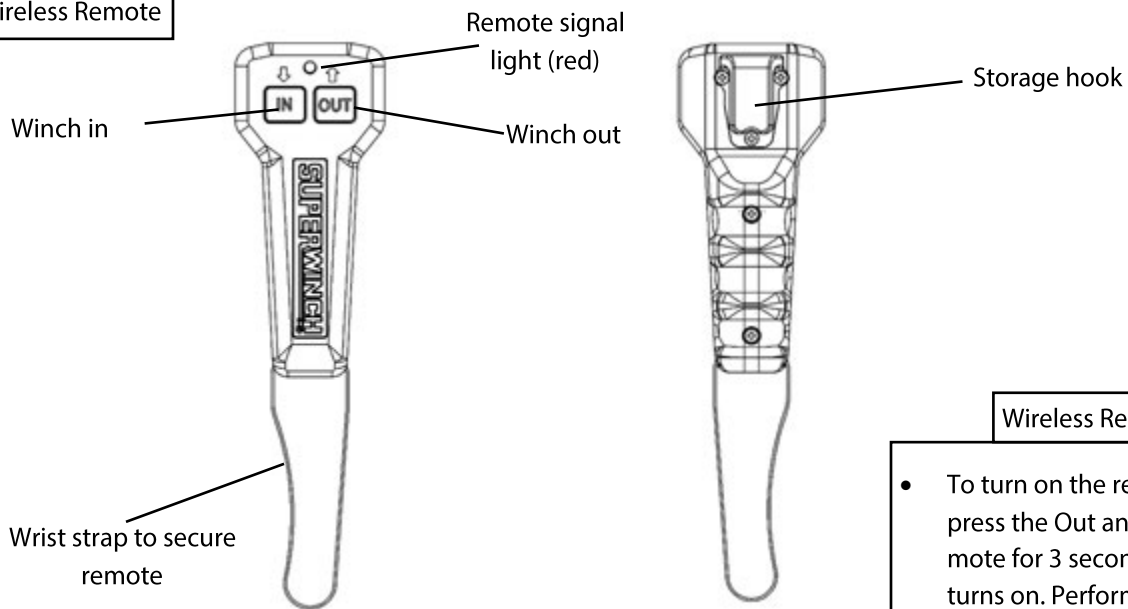

## Wireless Remote Features

- To turn on the remote: **Simultaneously** press the Out and In button on the remote for 3 seconds until the red light turns on. Perform the same process to turn off the remote. It is also on a 2 minute shutoff timer.
- Out/In buttons will operate winch until you release the button.
- Battery size: CR2450

Can be stored on pants pocket



Can be stored on MOLLE



# REPLACE WIRELESS REMOTE BATTERY

1. Remove the 4 screws on the back on the wireless remote. See **figure 3**.
2. Locate the latch on the battery compartment. Open it using a plastic-ended tool. See **figures 4 and 5**.
3. Push the old battery out with a plastic-ended tool.
4. Push the new CR2450 battery in with the **positive side facing up**. See **figure 6**.
5. Close the compartment. See **figure 4**.
6. Close up the remote and reinstall the (4) screws that were removed in step 1.



Figure 3

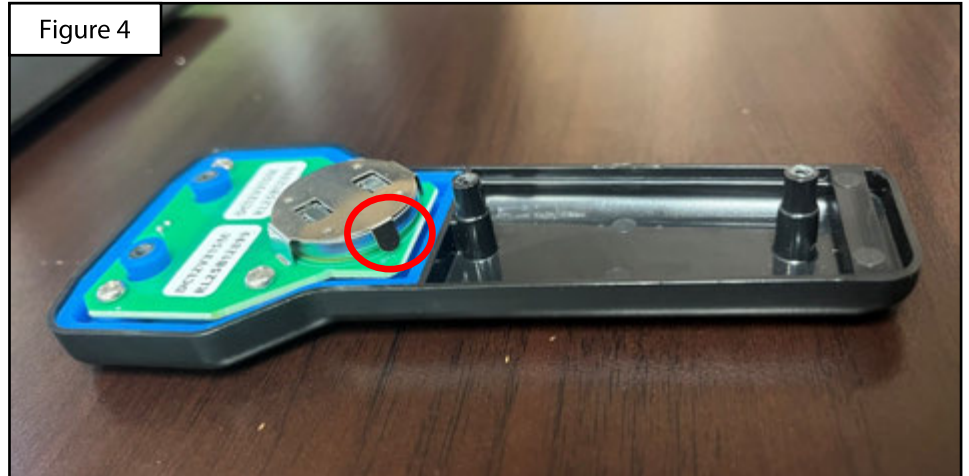

Figure 4

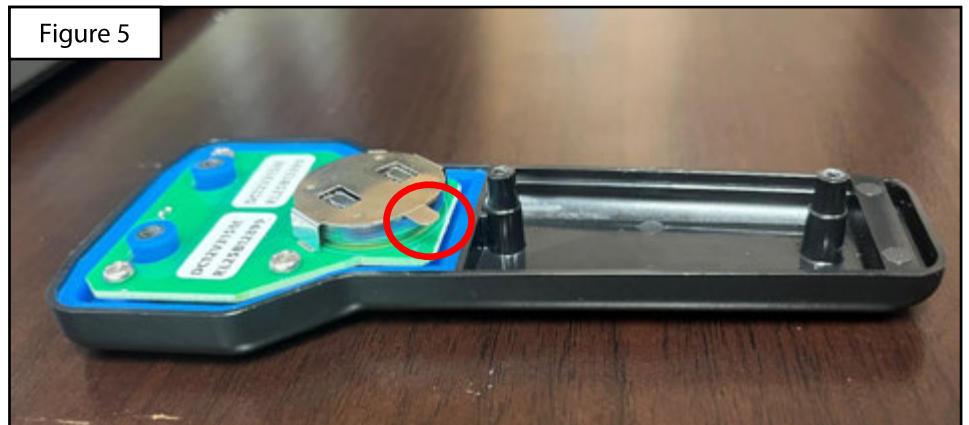

Figure 5

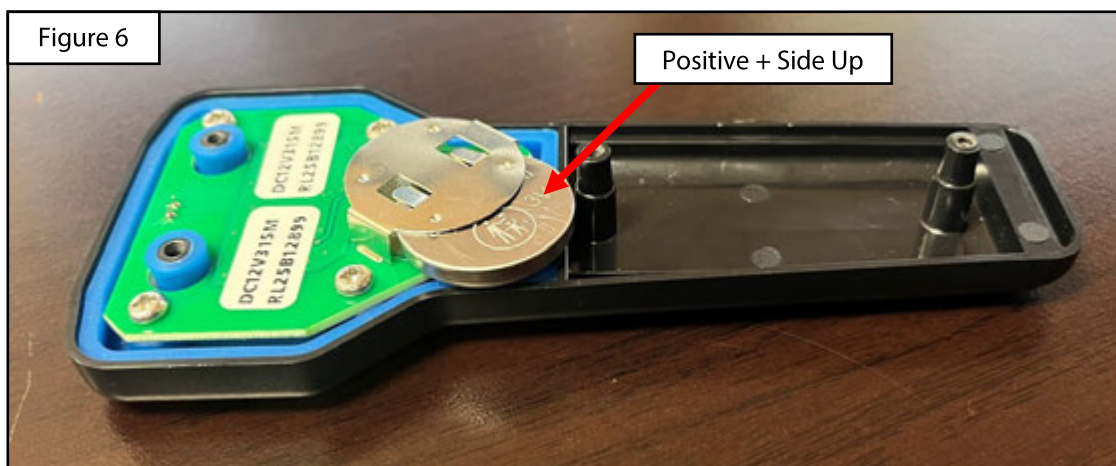

Figure 6

Positive + Side Up

# WARNING

Failure to follow these instructions could lead to death, personal injury, and / or property damage.

## FASTENERS:

All SUPERWINCH supplied fasteners must be utilized and installed in accordance with the installation instructions and apply torque to the specifications as defined. **DOUBLE CHECK ALL FASTENERS BEFORE INITIAL USE, AND PERIODICALLY IN THE FUTURE TO ENSURE PROPER FUNCTION AND SAFETY.**

## EYE PROTECTION:

**ALWAYS WEAR SAFETY GLASSES OR GOGGLES DURING THE INSTALLATION PROCESS TO AVOID PERSONAL INJURY.**

## FOR CALIFORNIA RESIDENTS ONLY-PROP 65 WARNING:

Some products may contain chemicals such as DEHP, which can cause cancer, birth defects or other reproductive harm. For more info go to [www.p65warnings.ca.gov](http://www.p65warnings.ca.gov)



For more information on this and other products,  
or to be put in contact with a Superwinch sales  
rep or distributor, call (800) 323- 2031  
or email [info@superwinch.com](mailto:info@superwinch.com)

**SUPERWINCH**  
**320 W. COVINA BLVD.**  
**SAN DIMAS, CA 91773**

© 2019 SUPERWINCH®, Superwinch®, and S Superwinch® (design) are registered trademarks of Superwinch Inc. in the United States and/or other countries.